

<b>ASSEMBLY INSTRUCTIONS, JET WATER PERFORMANCE CURVES, GA DRAWINGS OPTIONAL WATER JET RING, SERIES TBM</b>				1 of 1
DOCUMENT NBR. :	<b>A0659</b>	REVISION:	<b>1</b>	EFFECTIVE DATE: <b>05/06/25</b>

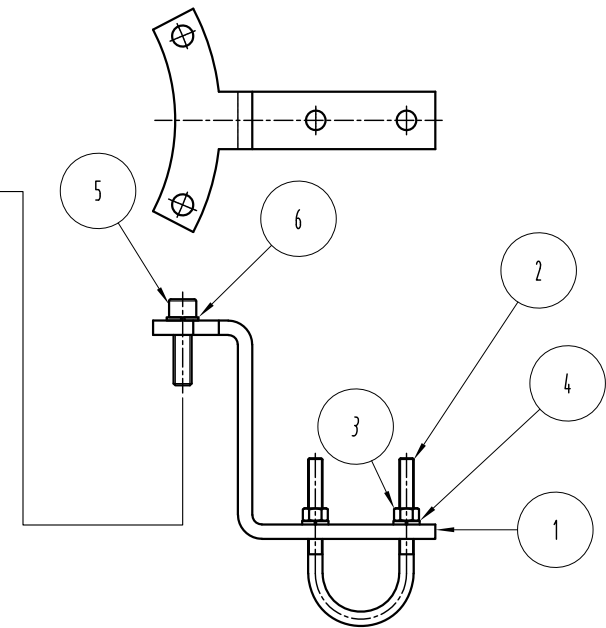

0		NEW	UJB		08/05/2012
1		GENERAL UPDATE	UJB		05/06/2025
REV	ECN	CHANGE DESCRIPTION	BY	APPV'D	DATE

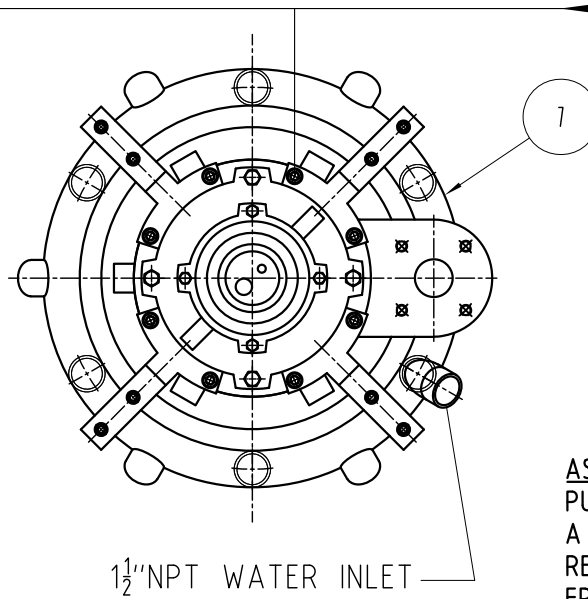
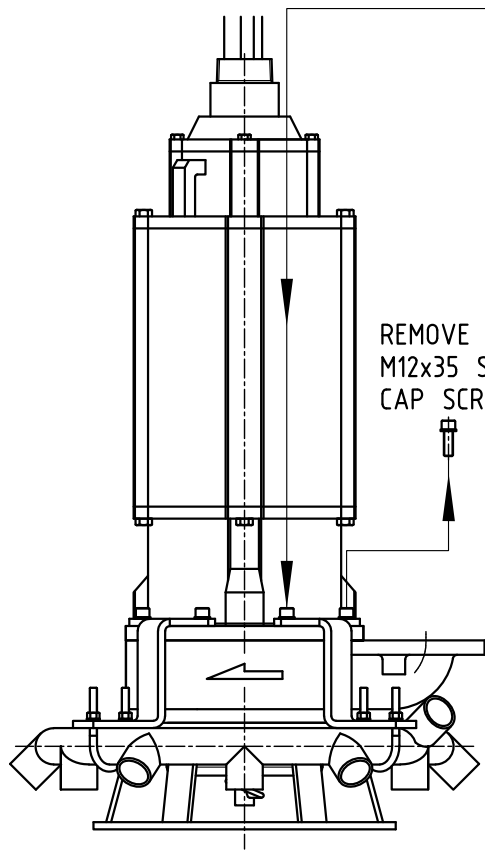

#### ASSEMBLY INSTRUCTIONS:

PUMP MUST BE STANDING UPRIGHT ON THE PUMP STAND ON A FLAT AND LEVEL SURFACE.

REMOVE THE ORIGINAL (8) M12x35 SOCKET HEAD CAP SCREWS FROM THE MOTOR FLANGE.

POSITION AND ATTACH THE (4) MOUNTING BRACKETS (ITEM 1) AS SHOWN WITH THE (8) M12x45 SOCKET HEAD CAP SCREWS AND LOCK WASHERS (ITEMS 5,6). APPLY Loctite® 242 AND RE-TIGHTEN TO 62 Nm (46 lb/ft).

RAISE THE PUMP OFF THE GROUND AND POSITION THE WATER JET RING ASSEMBLY UNDER THE PUMP STAND WITH THE WATER INLET POSITIONED AS SHOWN.

LOWER THE PUMP BACK TO THE FLOOR. USE THE 3/8 U-BOLTS, HEX NUTS AND LOCK WASHERS (ITEMS 2,3,4) TO ATTACH THE WATER JET RING (ITEM 7) TO THE BRACKETS. APPLY Loctite® 242 AND TIGHTEN TO 62 Nm (46 lb/ft).

#### ASSEMBLY INSTRUCTIONS OPTIONAL WATER JET RING TBM 50LH, 75LH

DRAWING NBR.: A0655 REV.: 1

EFFECTIVE DATE : 05/06/25

**POLARIS**  
P U M P S

PUMP MODEL	JET RING BRACKET KIT	WATER JET RING
TBM50LH	973.200.05.01628	973.200.05.01577
TBM75LH		
FOR WATER JET RING PERFORMANCE CURVE SEE:		A0638

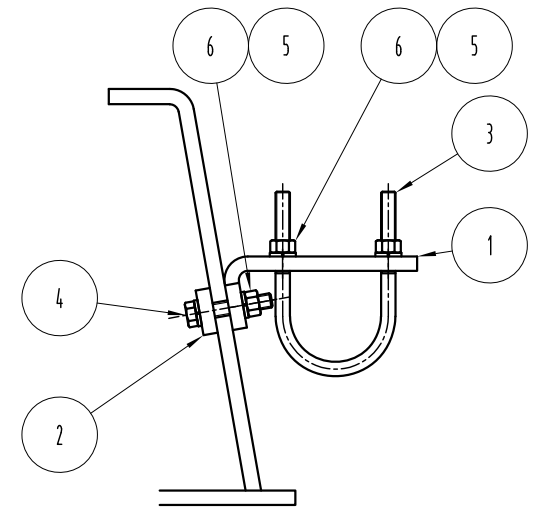
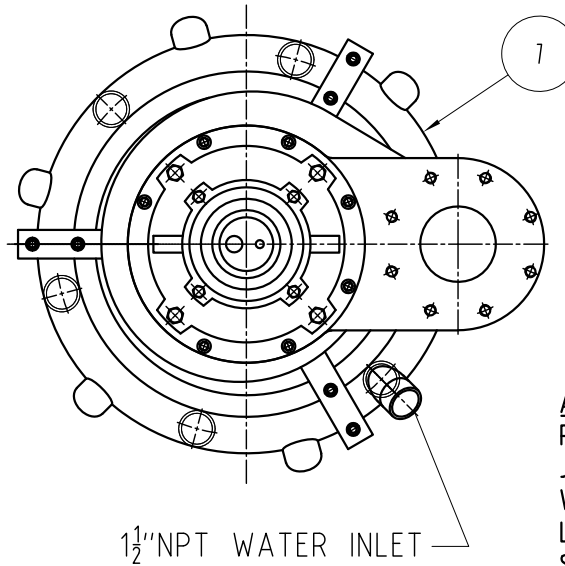
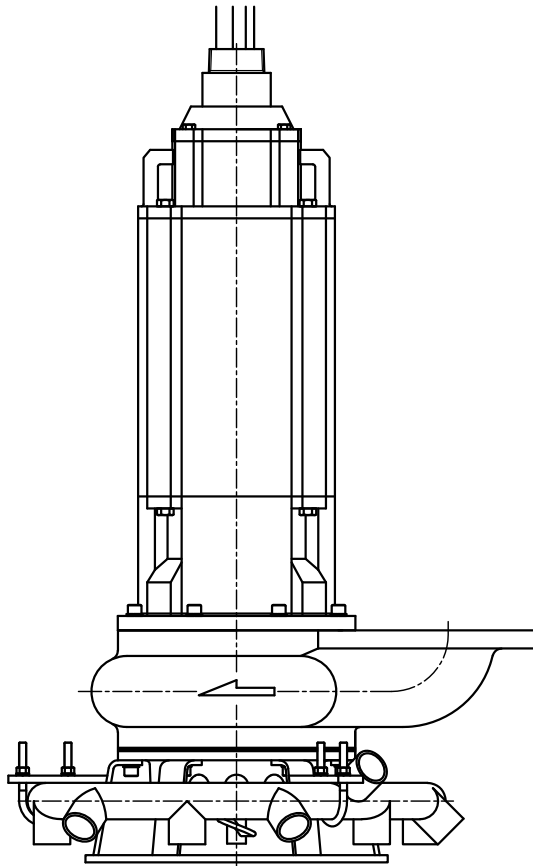

#### ASSEMBLY INSTRUCTIONS:

RAISE THE PUMP OFF THE GROUND AND POSITION THE WATER JET RING ASSEMBLY UNDER THE PUMP STAND WITH THE WATER INLET POSITIONED AS SHOWN.

LOWER THE PUMP BACK ONTO THE FLOOR. PUMP MUST BE STANDING UPRIGHT ON THE PUMP STAND ON A FLAT AND LEVEL SURFACE.

POSITION AND LOOSELY ATTACH THE (3) MOUNTING BRACKETS AND CLAMP PLATES (ITEM 1/2) TO THE PUMP STAND LEGS AS SHOWN WITH THE (6) 3/8x2 HEX HEAD CAP SCREWS, HEX NUTS AND LOCK WASHERS (ITEMS 4/5/6).

USE THE U-BOLTS, HEX NUTS AND LOCK WASHERS (ITEMS 3/5/6) TO ATTACH THE WATER JET RING (ITEM 7) TO THE BRACKETS. APPLY Loctite® 242 AND TIGHTEN ALL FASTENERS TO 62 Nm (46 lb/ft).

#### ASSEMBLY INSTRUCTIONS OPTIONAL WATER JET RING TBM 100LH

DRAWING NBR.: A0656

REV.: 1

EFFECTIVE DATE : 05/06/25

**POLARIS**  
P U M P S

PUMP MODEL	JET RING BRACKET KIT	WATER JET RING
TBM100LH	973.200.05.01572	973.200.05.01577
FOR WATER JET RING PERFORMANCE CURVE SEE:		A0638

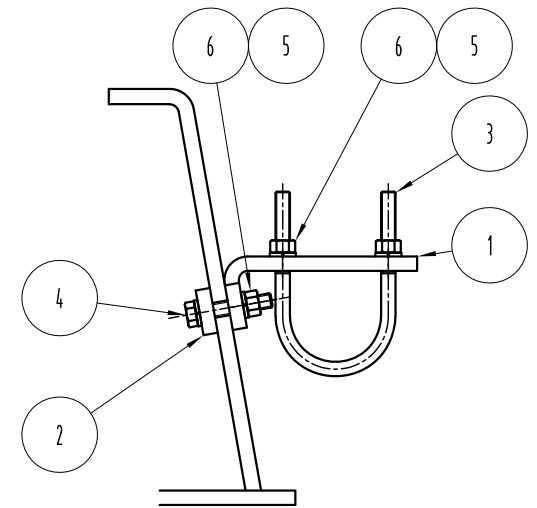
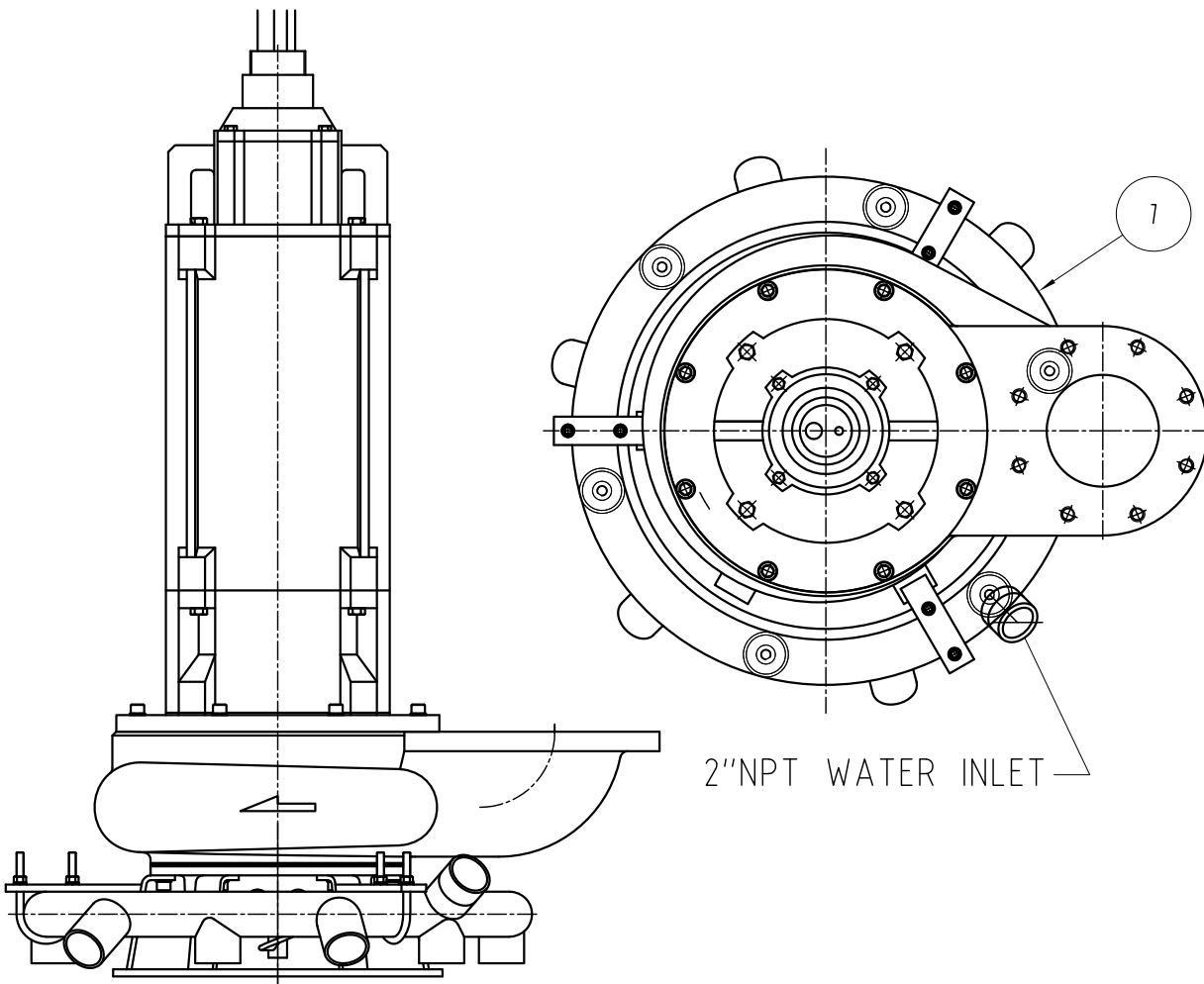

#### ASSEMBLY INSTRUCTIONS:

RAISE THE PUMP OFF THE GROUND AND POSITION THE WATER JET RING ASSEMBLY UNDER THE PUMP STAND WITH THE WATER INLET POSITIONED AS SHOWN.

LOWER THE PUMP BACK ONTO THE FLOOR. PUMP MUST BE STANDING UPRIGHT ON THE PUMP STAND ON A FLAT AND LEVEL SURFACE.

POSITION AND LOOSELY ATTACH THE (3) MOUNTING BRACKETS AND CLAMP PLATES (ITEM 1/2) TO THE PUMP STAND LEGS AS SHOWN WITH THE (6)  $\frac{3}{8}$ x2 HEX HEAD CAP SCREWS, HEX NUTS AND LOCK WASHERS (ITEMS 4/5/6).

USE THE U-BOLTS, HEX NUTS AND LOCK WASHERS (ITEMS 3/5/6) TO ATTACH THE WATER JET RING (ITEM 7) TO THE BRACKETS. APPLY Loctite® 242 AND TIGHTEN ALL FASTENERS TO 62 Nm (46 lb/ft).

#### ASSEMBLY INSTRUCTIONS

OPTIONAL WATER JET RING  
TBM 150LH, 75MH, 100MH

DRAWING NBR.: A0657

REV.: 0

EFFECTIVE DATE : 05/06/25

**POLARIS**  
P U M P S

PUMP MODEL	JET RING BRACKET KIT	WATER JET RING
TBM150LH	973.200.05.01539	973.200.05.01545
TBM75MH	973.200.05.01550	
TBM100MH		
FOR WATER JET RING PERFORMANCE CURVE SEE:		A0637

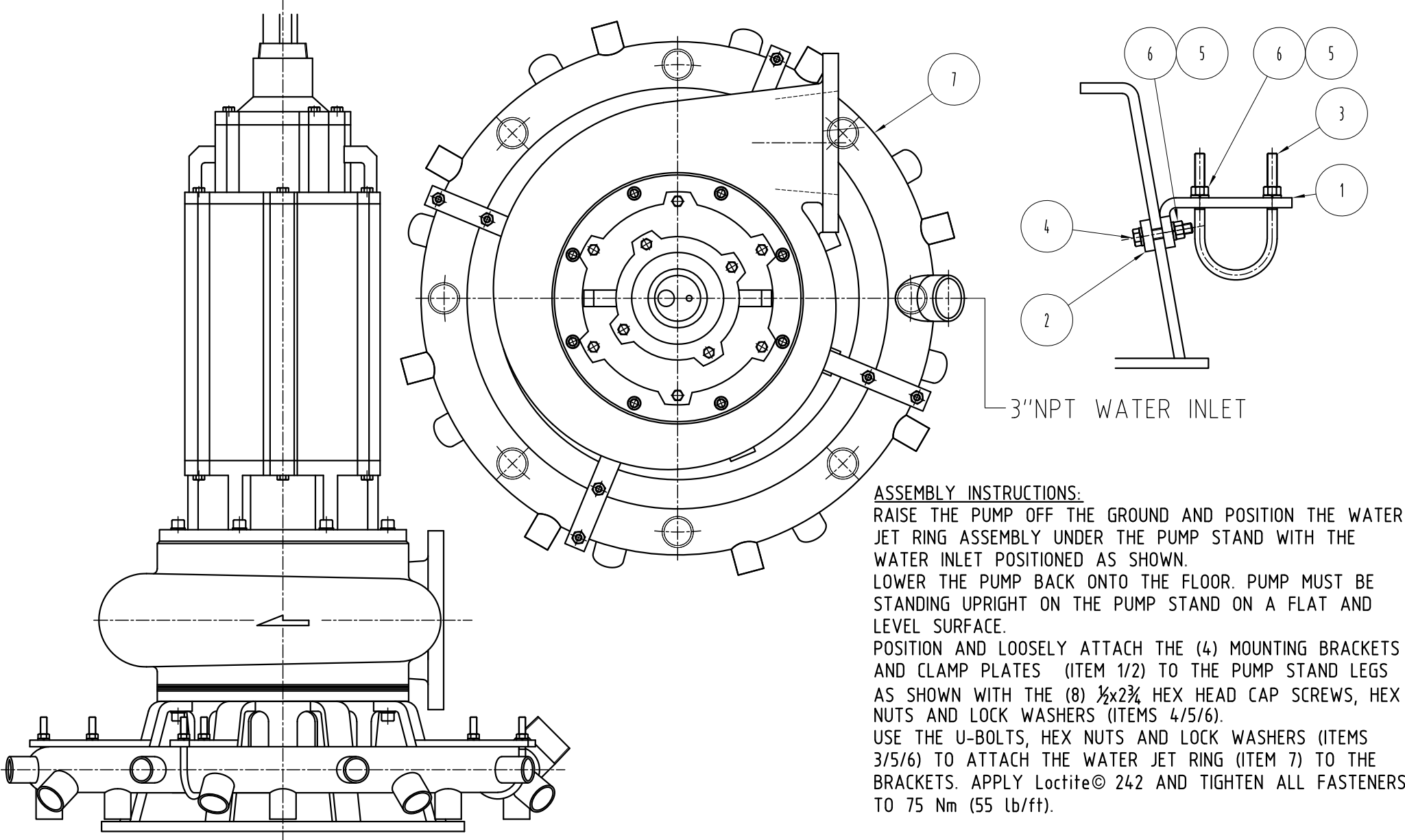

**ASSEMBLY INSTRUCTIONS:**  
 RAISE THE PUMP OFF THE GROUND AND POSITION THE WATER JET RING ASSEMBLY UNDER THE PUMP STAND WITH THE WATER INLET POSITIONED AS SHOWN.  
 LOWER THE PUMP BACK ONTO THE FLOOR. PUMP MUST BE STANDING UPRIGHT ON THE PUMP STAND ON A FLAT AND LEVEL SURFACE.  
 POSITION AND LOOSELY ATTACH THE (4) MOUNTING BRACKETS AND CLAMP PLATES (ITEM 1/2) TO THE PUMP STAND LEGS AS SHOWN WITH THE (8) 1/2x2 3/4 HEX HEAD CAP SCREWS, HEX NUTS AND LOCK WASHERS (ITEMS 4/5/6).  
 USE THE U-BOLTS, HEX NUTS AND LOCK WASHERS (ITEMS 3/5/6) TO ATTACH THE WATER JET RING (ITEM 7) TO THE BRACKETS. APPLY Loctite® 242 AND TIGHTEN ALL FASTENERS TO 75 Nm (55 lb/ft).

ASSEMBLY INSTRUCTIONS OPTIONAL WATER JET RING TBM 200LH, 150MH, 200MH	
DRAWING NBR.: A0658	REV.: 1
EFFECTIVE DATE : 06/06/25	

**POLARIS**  
 P U M P S

PUMP MODEL	JET RING BRACKET KIT	WATER JET RING
TBM200LH	973.200.05.01555	973.200.05.01516
TBM150MH	973.200.05.01556	
TBM200MH	973.200.05.01521	
FOR WATER JET RING PERFORMANCE CURVE SEE:		A0636

# POLARIS

## P U M P S

PUMP MODEL TBM50LH TBM75LH TBM100LH	CURVE NBR.: <b>A0638</b>	JET RING PART NUMBER: <b>971.200.05.01576 (A53Gr.B)</b>
	REVISION : <b>1</b>	<b>971.200.05.01577 (316SS)</b>
	TEST NBR.: <b>N/A</b>	JET RING WATER INLET $\phi$ : <b>1 1/2" NPT</b>
	EFFECTIVE DATE : <b>05/06/25</b>	PERFORMANCE FOR <u>CLEAR WATER</u> @ 68°F/20°C AND 1.0 S.G.
	APPROVED BY : <b>UJB</b>	MAXIMUM JET RING WORKING PRESSURE = 150PSI

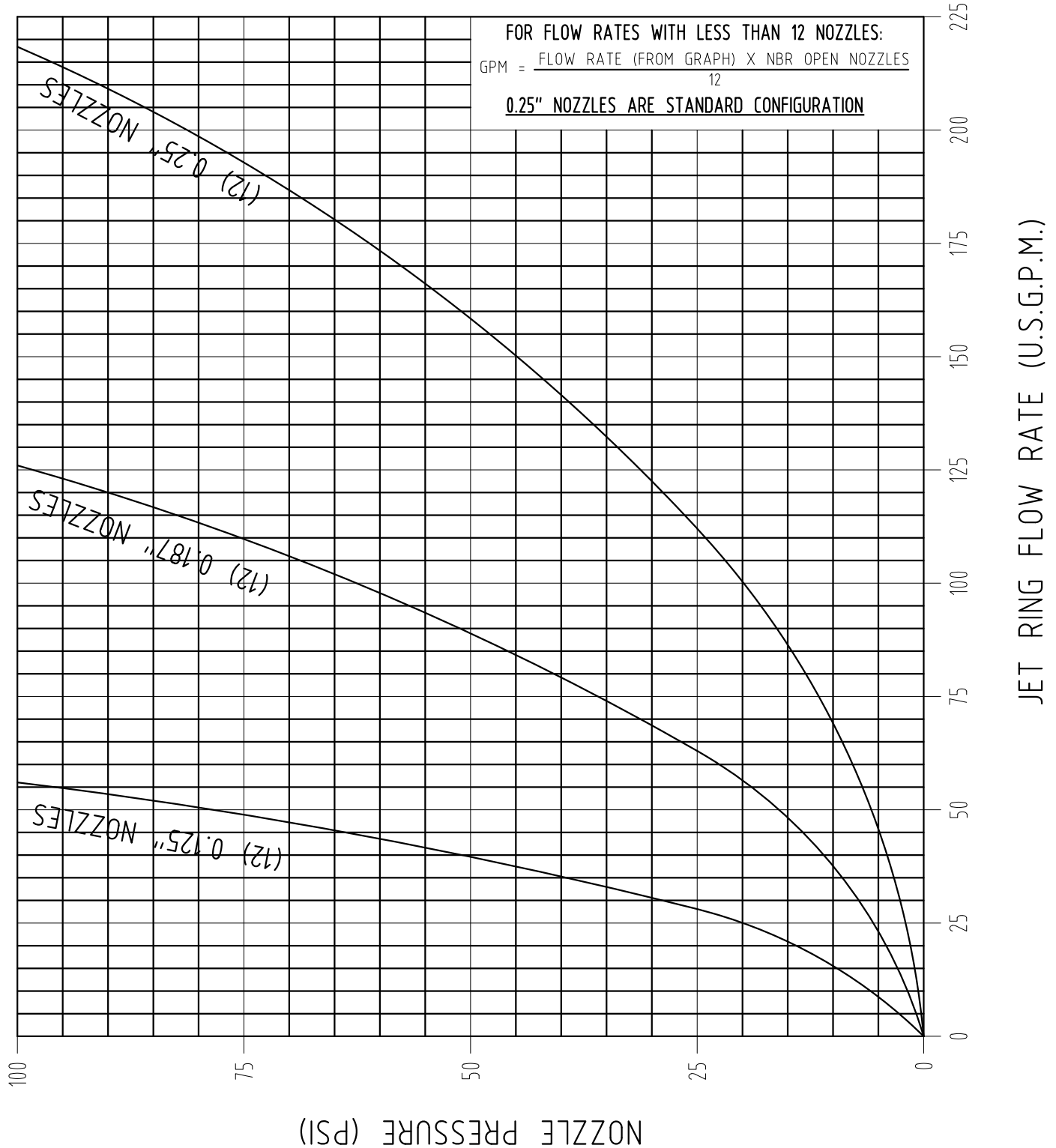

# POLARIS

## P U M P S

PUMP MODEL TBM150LH TBM75MH TBM100MH	CURVE NBR.: <b>A0637</b>	JET RING PART NUMBER: <b>971.200.05.01545 (A53Gr.B)</b> <b>971.200.05.01707 (316SS)</b>
	REVISION : <b>1</b>	
	TEST NBR.: <b>N/A</b>	JET RING WATER INLET $\phi$ : <b>2" NPT</b>
	EFFECTIVE DATE : <b>05/06/25</b>	PERFORMANCE FOR <u>CLEAR WATER</u> @ 68°F/20°C AND 1.0 S.G. MAXIMUM JET RING WORKING PRESSURE = 150PSI
	APPROVED BY : <b>UJB</b>	

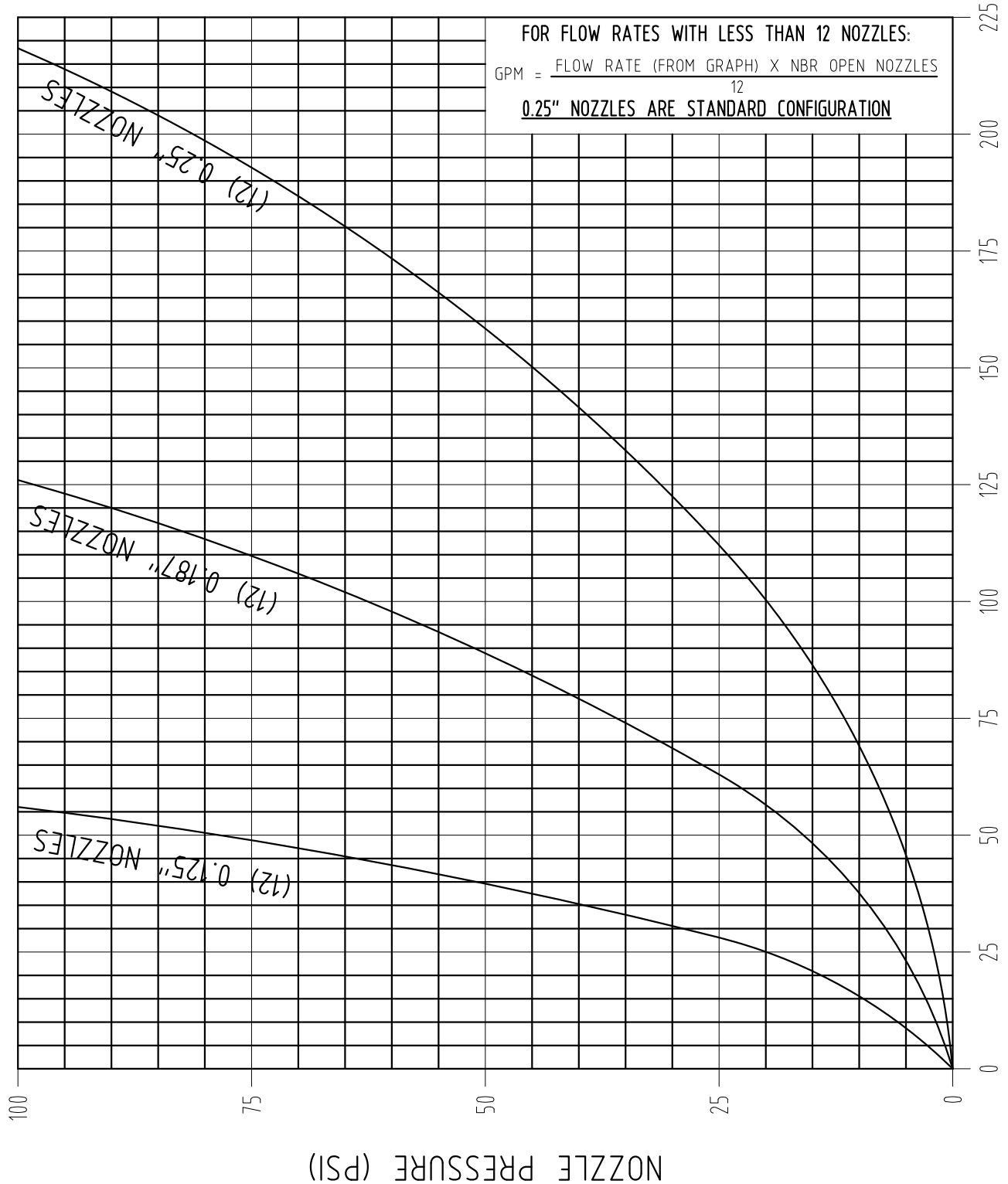

JET RING FLOW RATE (U.S.G.P.M.)



# POLARIS

## PUMPS

PUMP MODEL TBM200LH TBM150MH TBM200MH	CURVE NBR.: A0636	JET RING PART NUMBER: 971.200.05.01516 (A53Gr.B)
	REVISION : 2	971.200.05.01965 (316SS)
	TEST NBR.: N/A	JET RING WATER INLET $\phi$ : 3" NPT
	EFFECTIVE DATE : 05/06/25	PERFORMANCE FOR CLEAR WATER @ 68°F/20°C AND 1.0 S.G.
	APPROVED BY : UJB	MAXIMUM JET RING WORKING PRESSURE = 150PSI

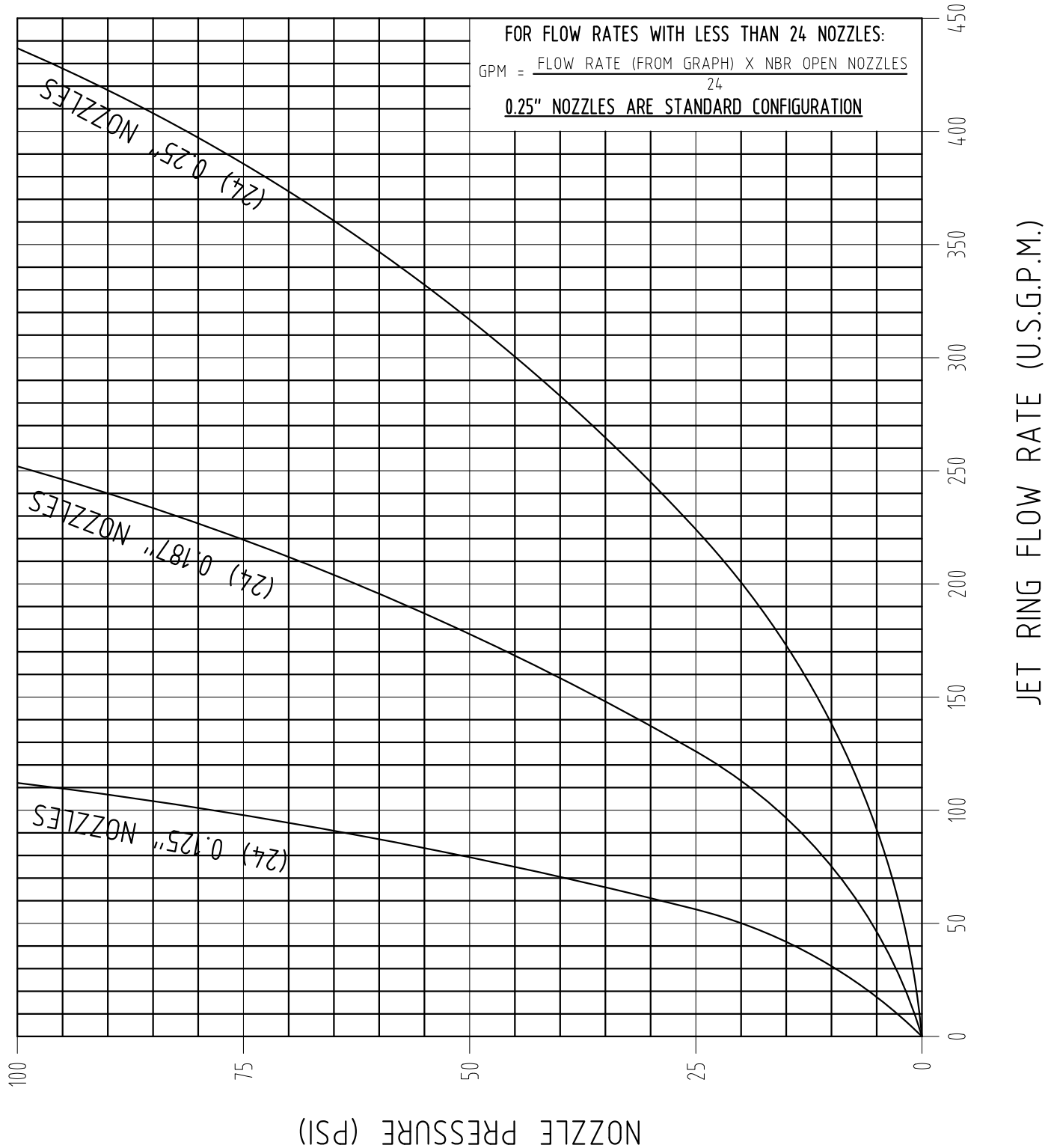











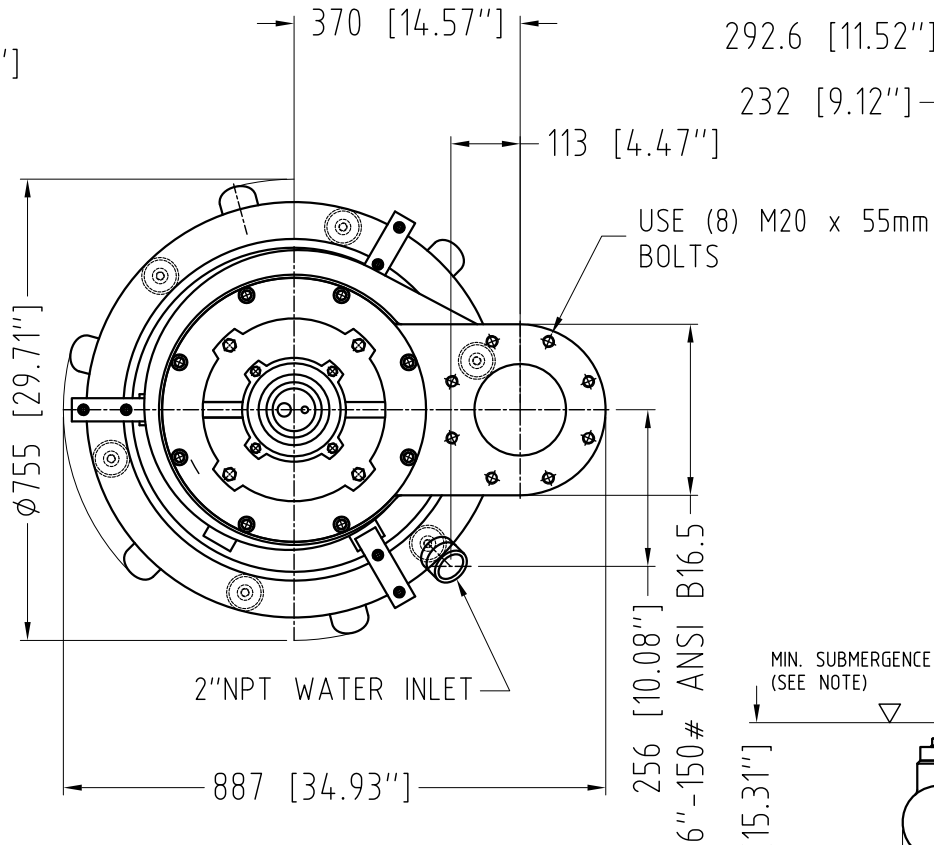
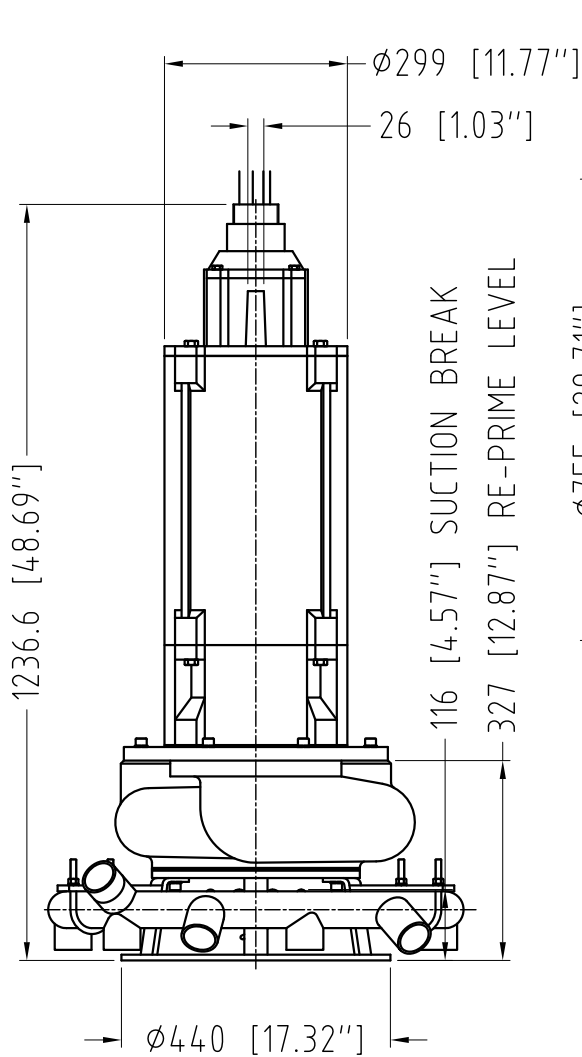

**NOTE:**  
MIN. SUBMERGENCE FOR MOTOR  
MODULES EQUIPPED WITH  
WATER JACKETS ONLY

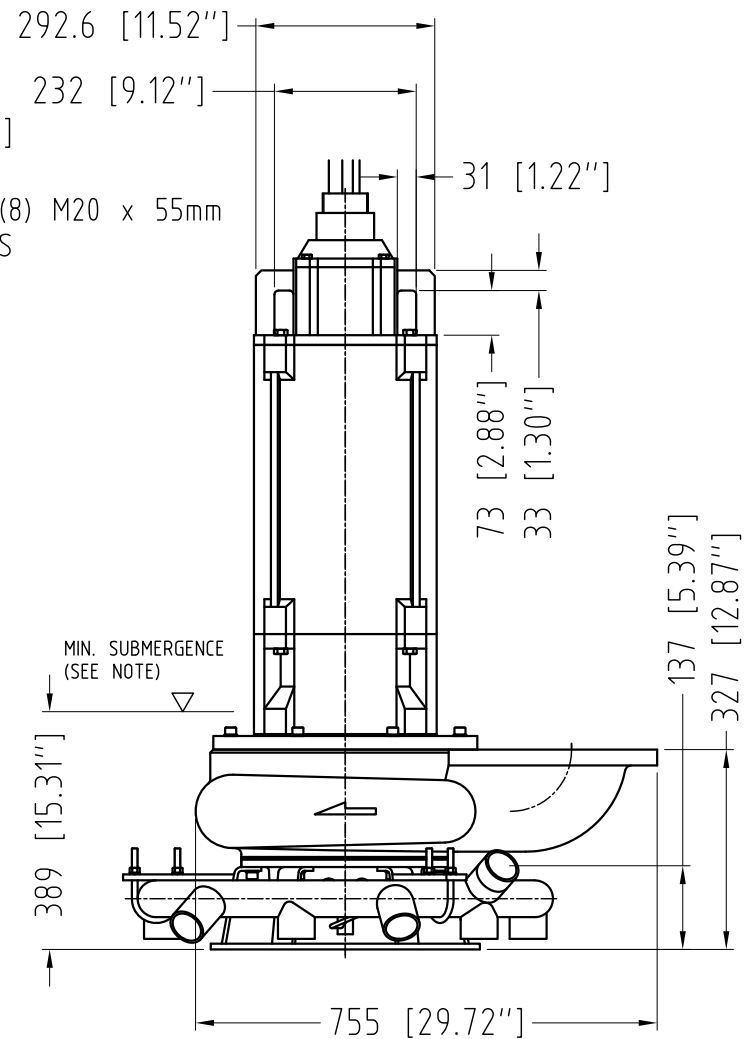

GENERAL ARRANGEMENT, WEIGHTS  
 TBM 150 LH-PHO, PBO, PVO (OPTIONAL WATER JET RING)  
 (25-40HP 4P, 15-25 HP 6P Motors)

DRAWING NBR.: A0645 REV.: 0

EFFECTIVE DATE : 08/05/2012

**POLARIS**  
 P U M P S

PUMP MODEL	WEIGHT (lbs.)	WEIGHT (kg)
TBM 150 LH - PHO	1101	501
TBM 150 LH - PBO	1106	503
TBM 150 LH - PVO	1108	504

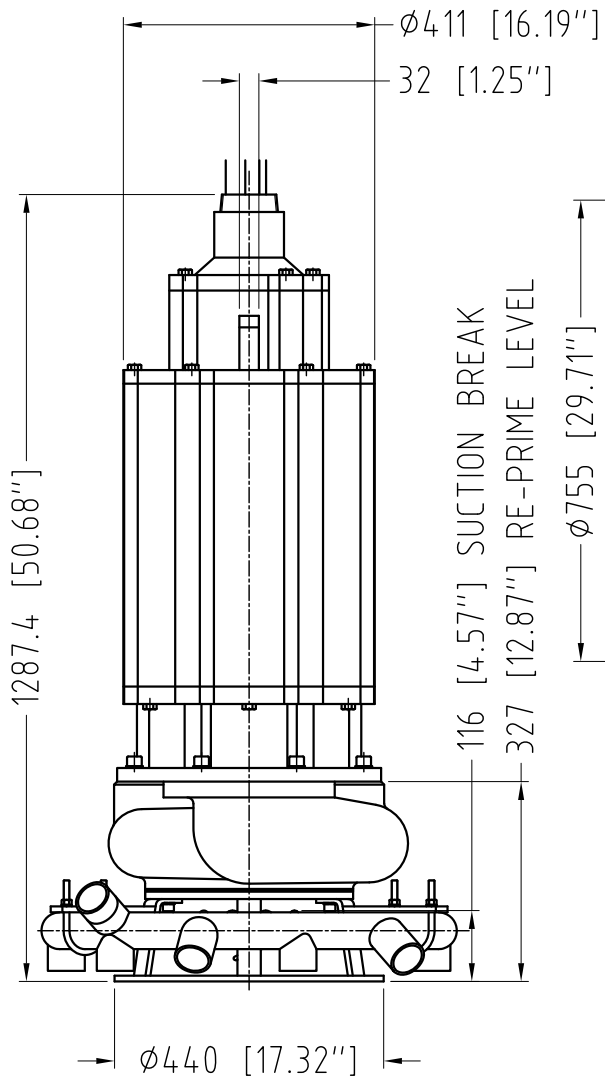

116 [4.57"] SUCTION BREAK  
327 [12.87"] RE-PRIME LEVEL

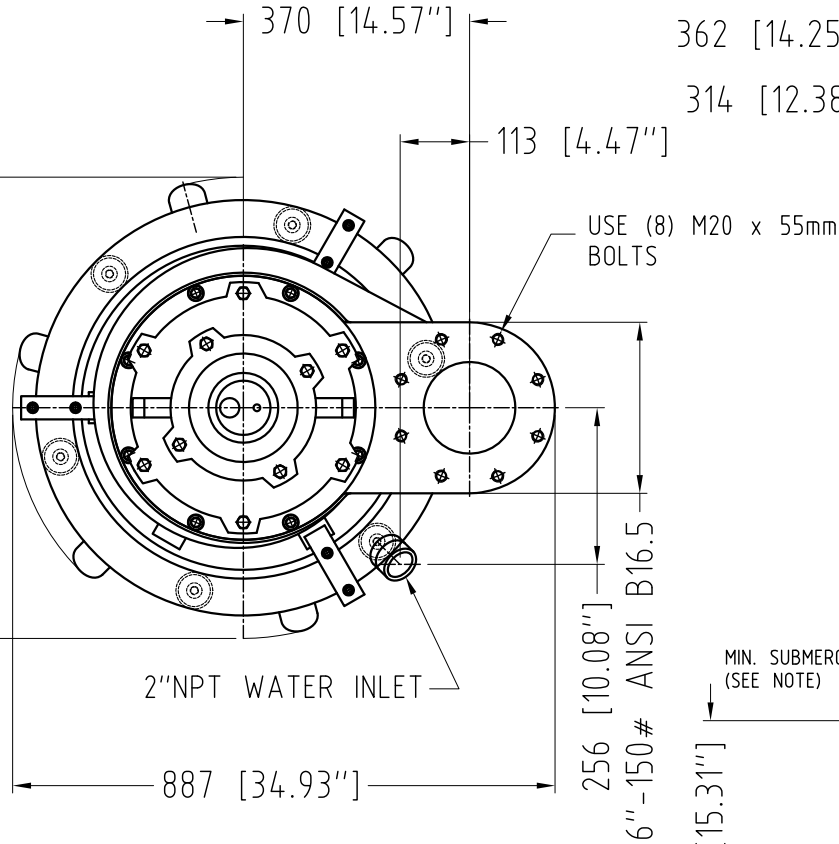

NOTE:  
MIN. SUBMERGENCE FOR MOTOR  
MODULES EQUIPPED WITH  
WATER JACKETS ONLY

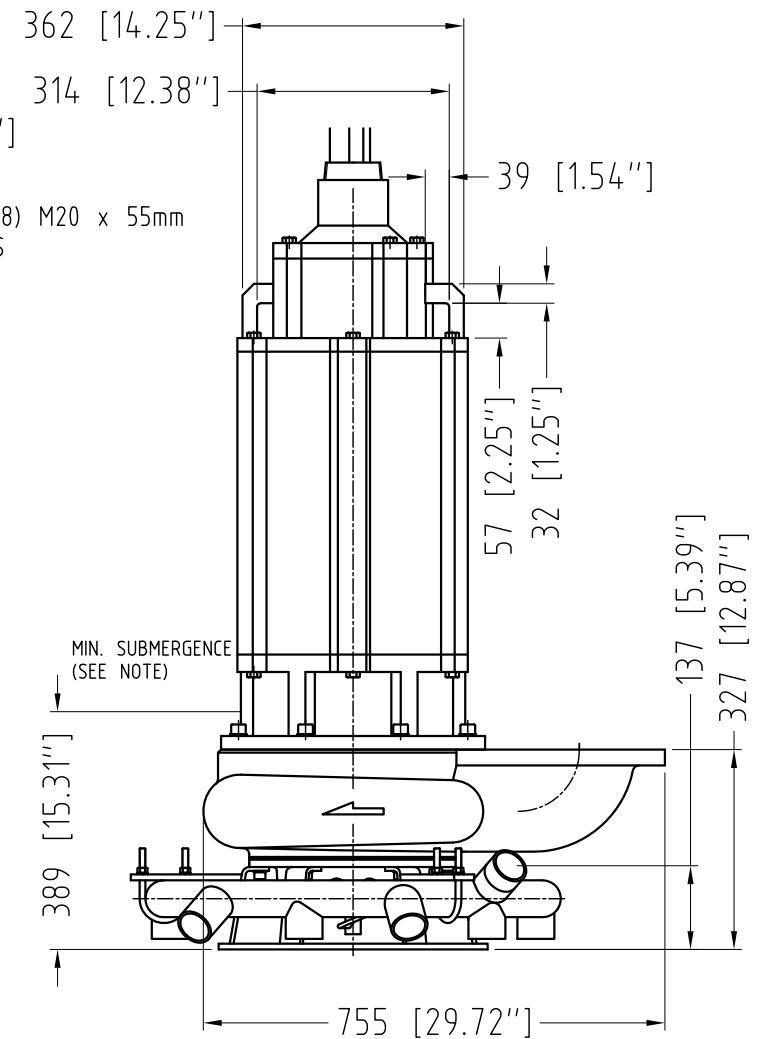

GENERAL ARRANGEMENT, WEIGHTS  
TBM 150 LH-PHO, PBO, PVO (OPTIONAL WATER JET RING)  
(30-40HP 6P, 50-75HP 4P Motors)

DRAWING NBR.: A0646 REV.: 0

EFFECTIVE DATE : 08/05/2012

**POLARIS**  
PUMPS

PUMP MODEL	WEIGHT (lbs.)	WEIGHT (kg)
TBM 150 LH - PHO	1503	683
TBM 150 LH - PBO	1506	684
TBM 150 LH - PVO	1507	685

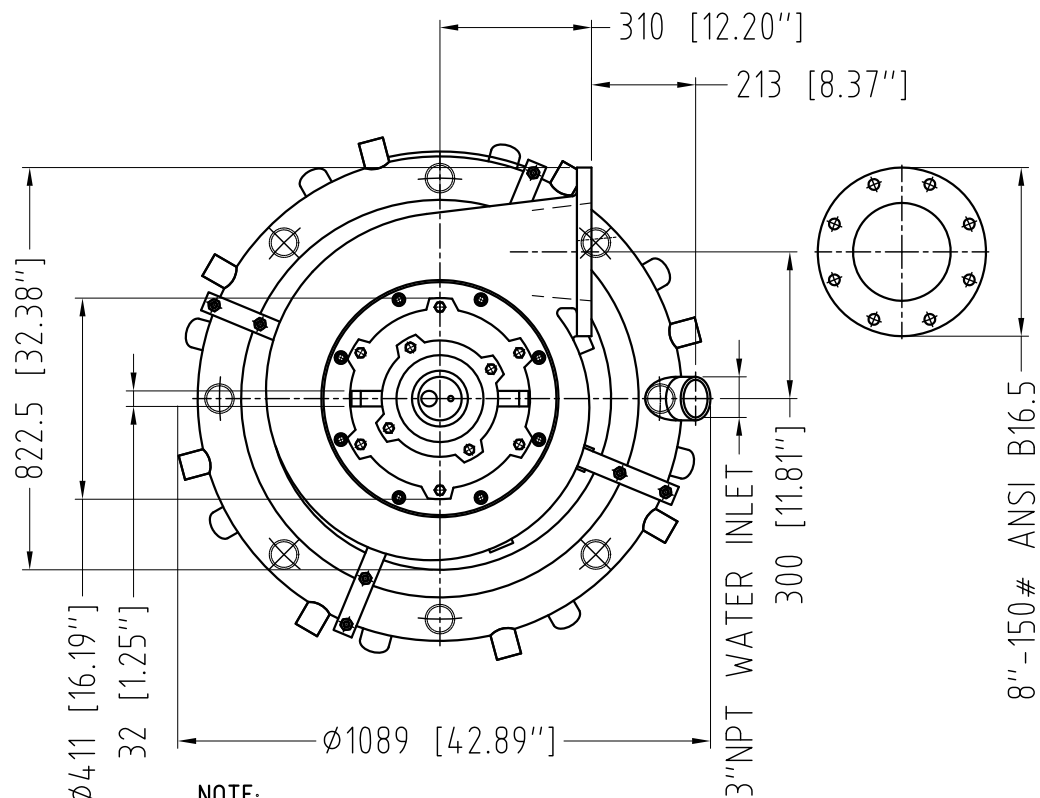
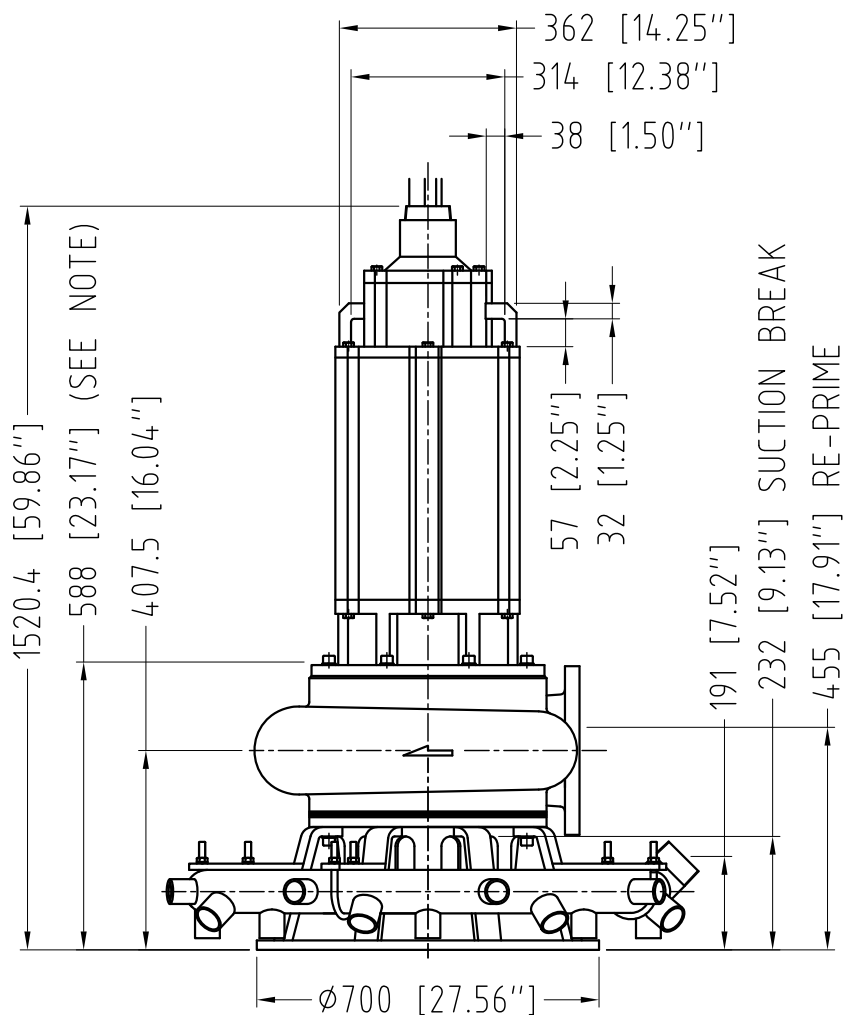

**NOTE:**  
MIN. SUBMERGENCE FOR MOTOR  
MODULES EQUIPPED WITH  
WATER JACKETS ONLY

GENERAL ARRANGEMENT, WEIGHTS  
 TBM 200 LH-PHO, PBO, PVO (40 - 60 HP 6P Motors)  
 OPTIONAL WATER JET RING (30 - 40 HP 8P Motors)

DRAWING NBR.: A0646 REV.: 0

EFFECTIVE DATE : 08/05/2012

**POLARIS**  
 P U M P S

PUMP MODEL	WEIGHT (lbs.)	WEIGHT (kg)
TBM 200 LH - PHO	2128	967
TBM 200 LH - PBO	2139	972
TBM 200 LH - PVO	2143	974





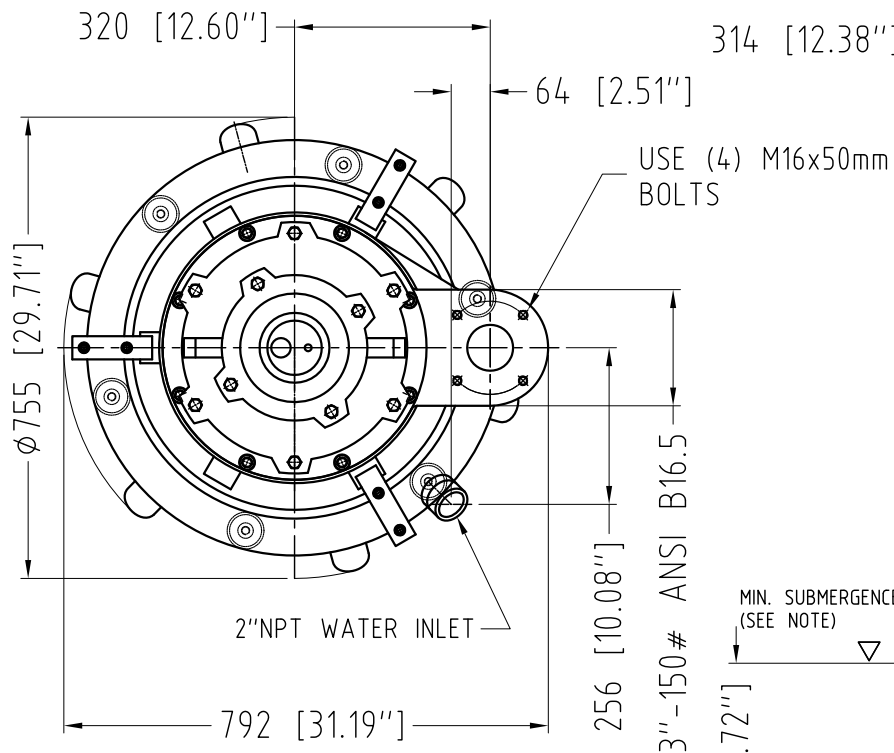
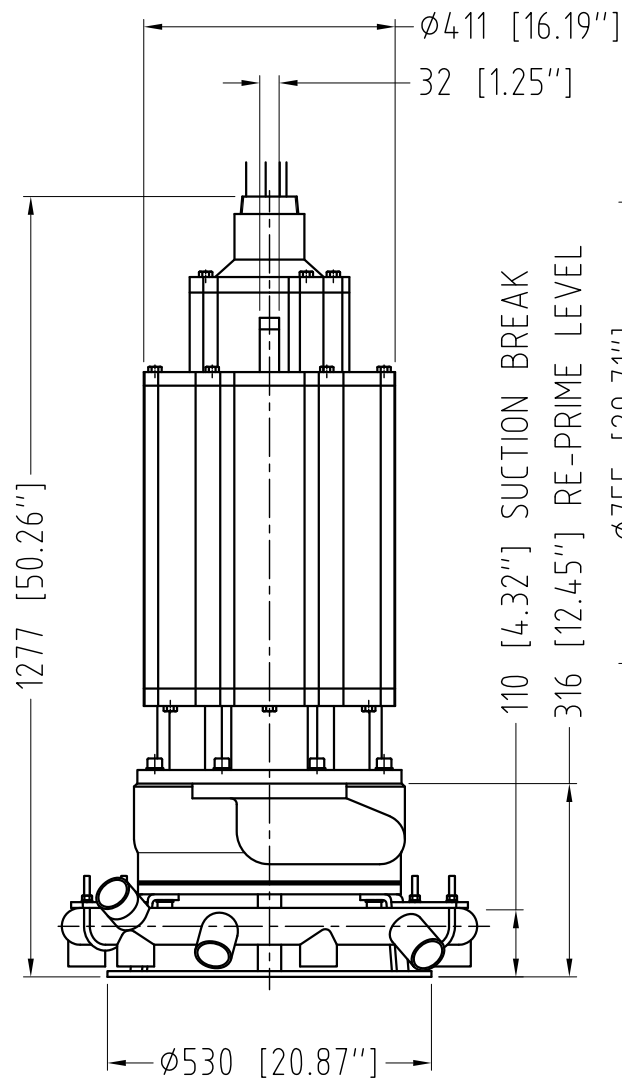

**NOTE:**  
 MIN. SUBMERGENCE FOR MOTOR  
 MODULES EQUIPPED WITH  
 WATER JACKETS ONLY

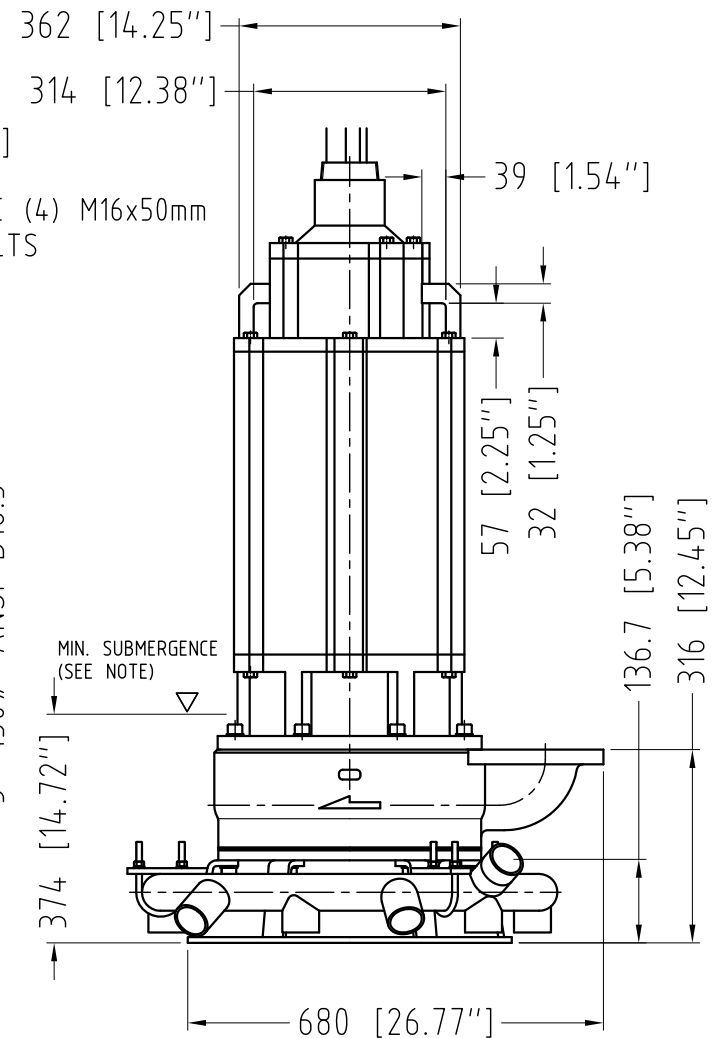

GENERAL ARRANGEMENT, WEIGHTS  
 TBM 75 MH-PHO, PBO, PVO (50 - 75 HP 4P Motors)

DRAWING NBR.: A0648

REV.: 0

EFFECTIVE DATE : 08/05/2012

**POLARIS**  
 P U M P S

PUMP MODEL	WEIGHT (lbs.)	WEIGHT (kg)
TBM 75 MH - PHO	1388	631
TBM 75 MH - PBO	1393	633
TBM 75 MH - PVO	1395	634



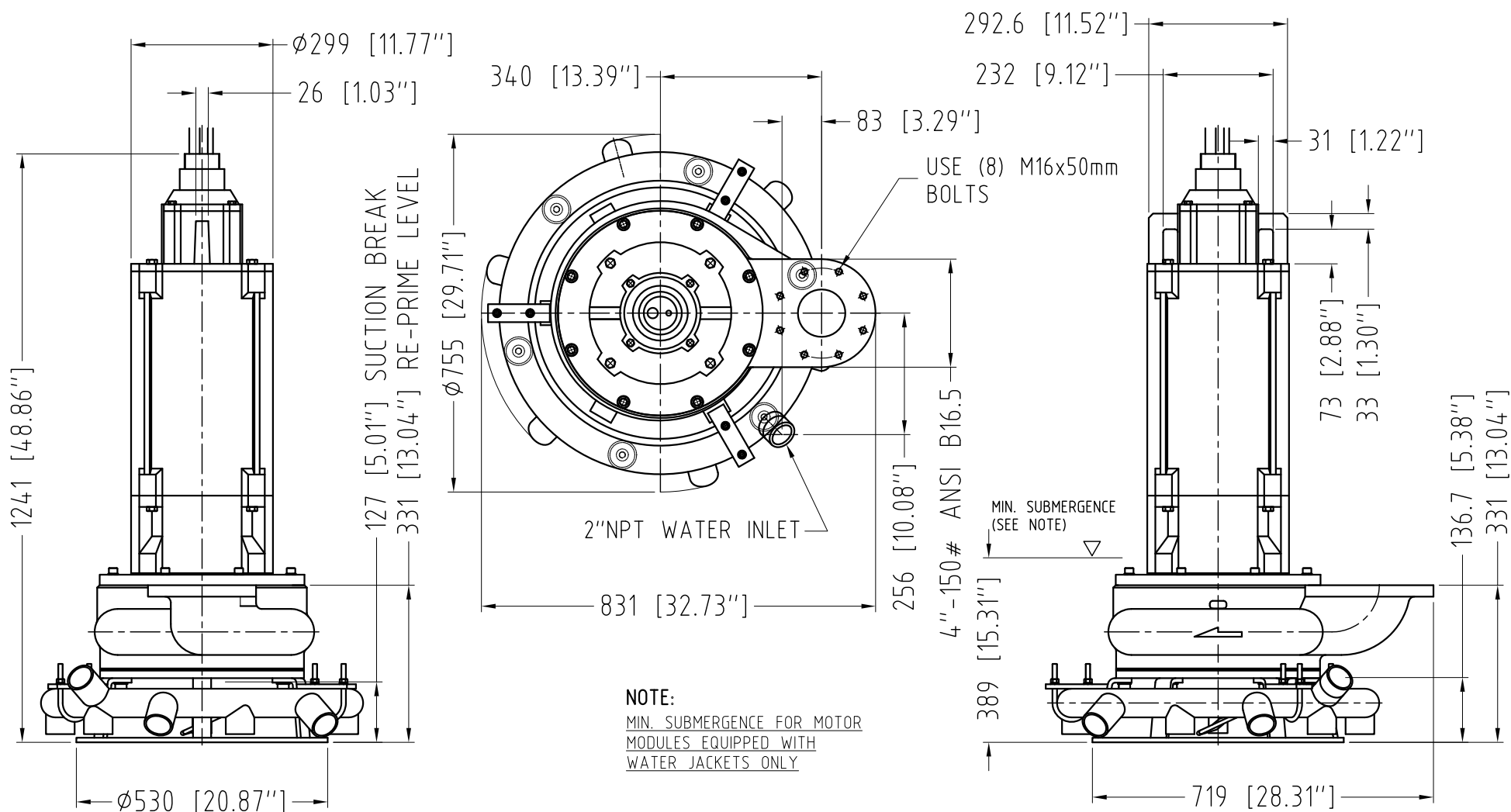

GENERAL ARRANGEMENT, WEIGHTS  
TBM 100 MH-PHO, PBO, PVO (25 - 40 HP 4P Motors)  
(15 - 25 HP 6P Motors)

DRAWING NBR.: A0649

REV.: 0

EFFECTIVE DATE : 08/05/2012

**POLARIS**  
PUMPS

PUMP MODEL	WEIGHT (lbs.)	WEIGHT (kg)
TBM 100 MH - PHO	827	376
TBM 100 MH - PBO	834	379
TBM 100 MH - PVO	832	378

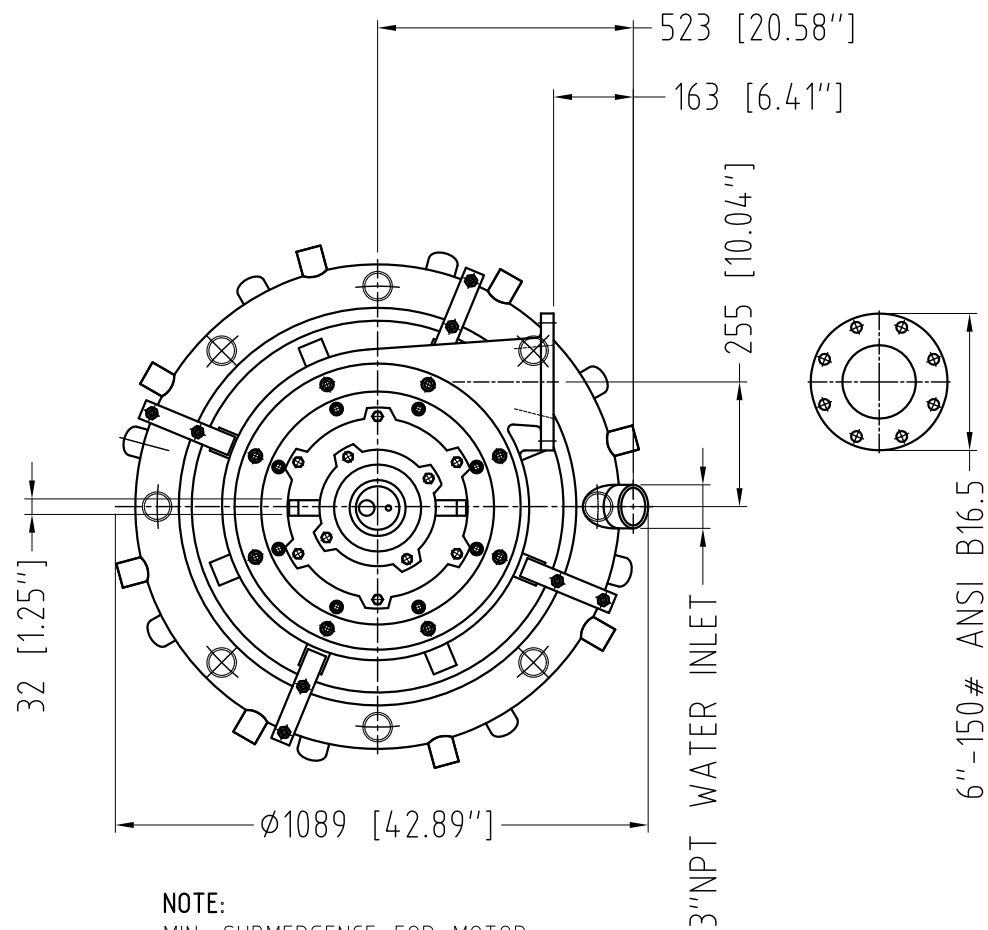
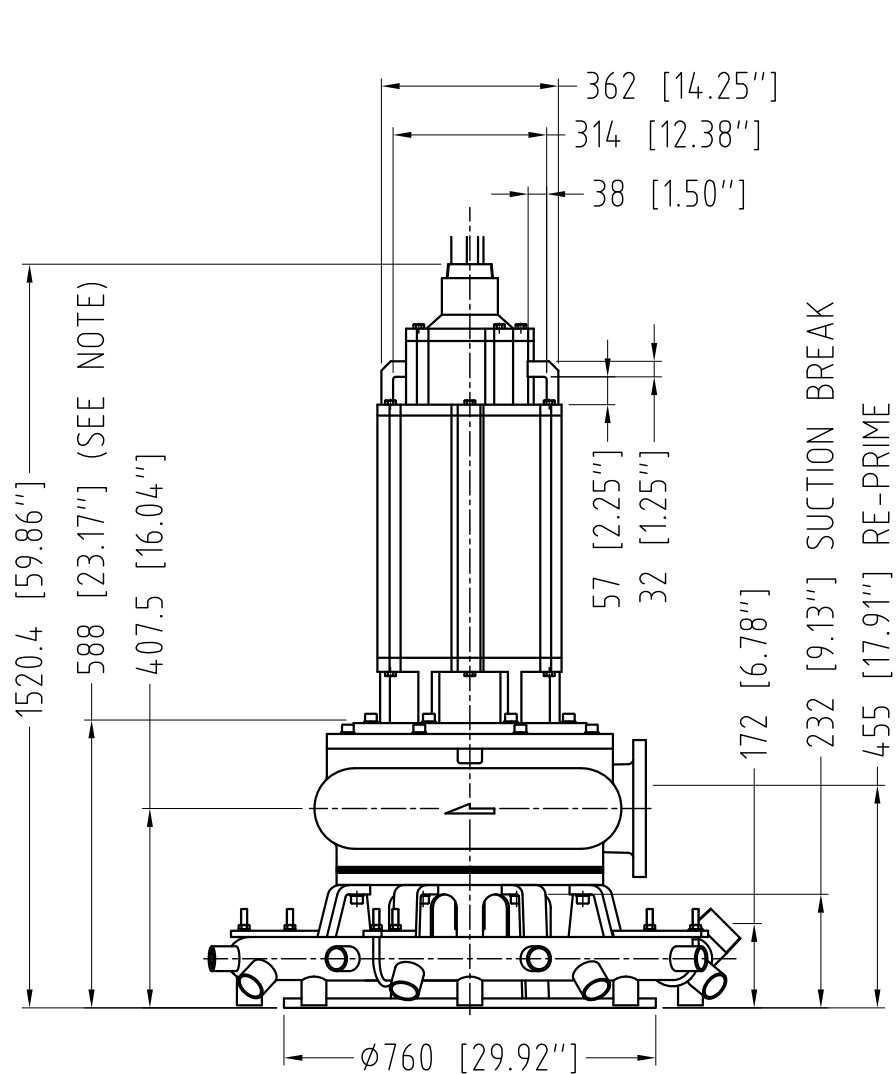

**NOTE:**  
MIN. SUBMERGENCE FOR MOTOR  
MODULES EQUIPPED WITH  
WATER JACKETS ONLY

#### GENERAL ARRANGEMENT, WEIGHTS

TBM 150 MH-PHO, PBO, PVO (50 - 60 HP 6P Motors)  
 OPTIONAL WATER JET RING (30 - 40 HP 8P Motors)

DRAWING NBR.: A0644

REV.: 0

EFFECTIVE DATE : 08/05/2012

**POLARIS**  
 P U M P S

PUMP MODEL	WEIGHT (lbs.)	WEIGHT (kg)
TBM 150 MH - PHO	2101	955
TBM 150 MH - PBO	2341	1064
TBM 150 MH - PVO	2361	1073

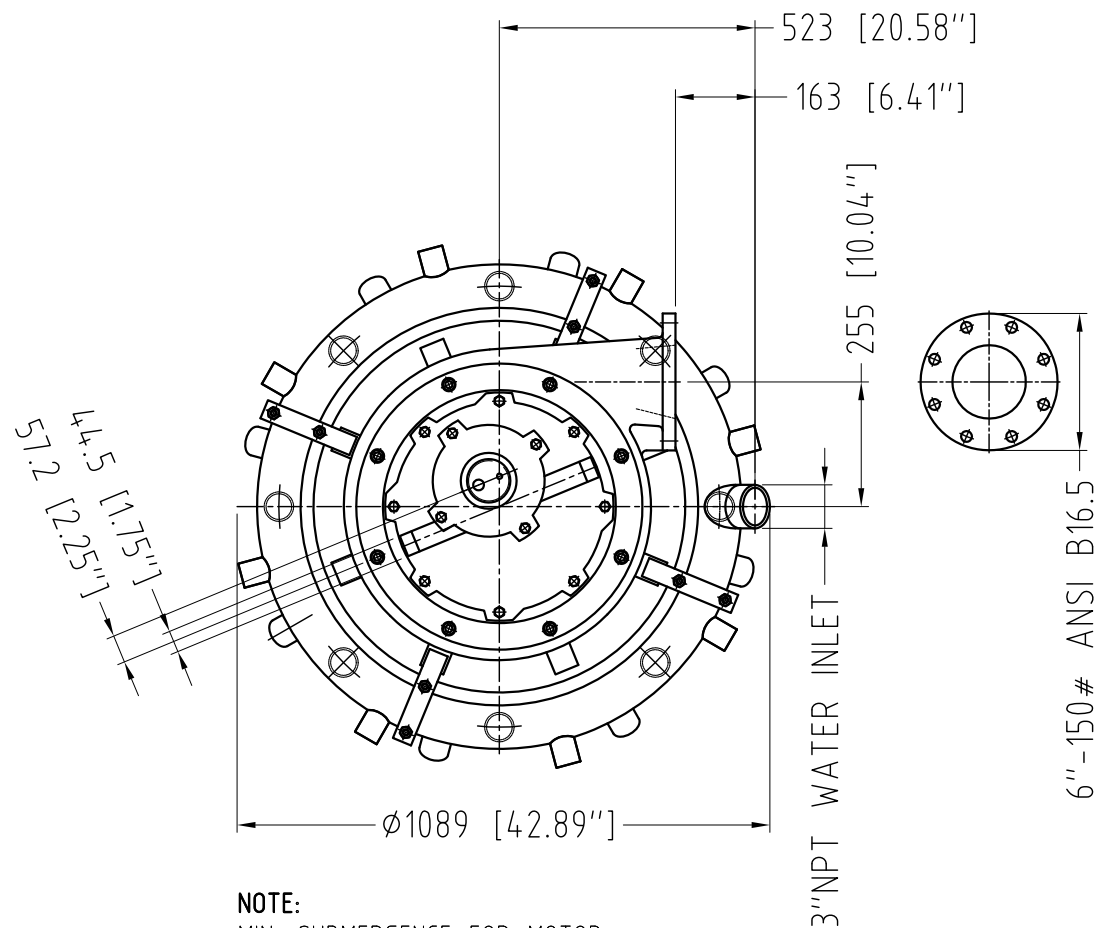
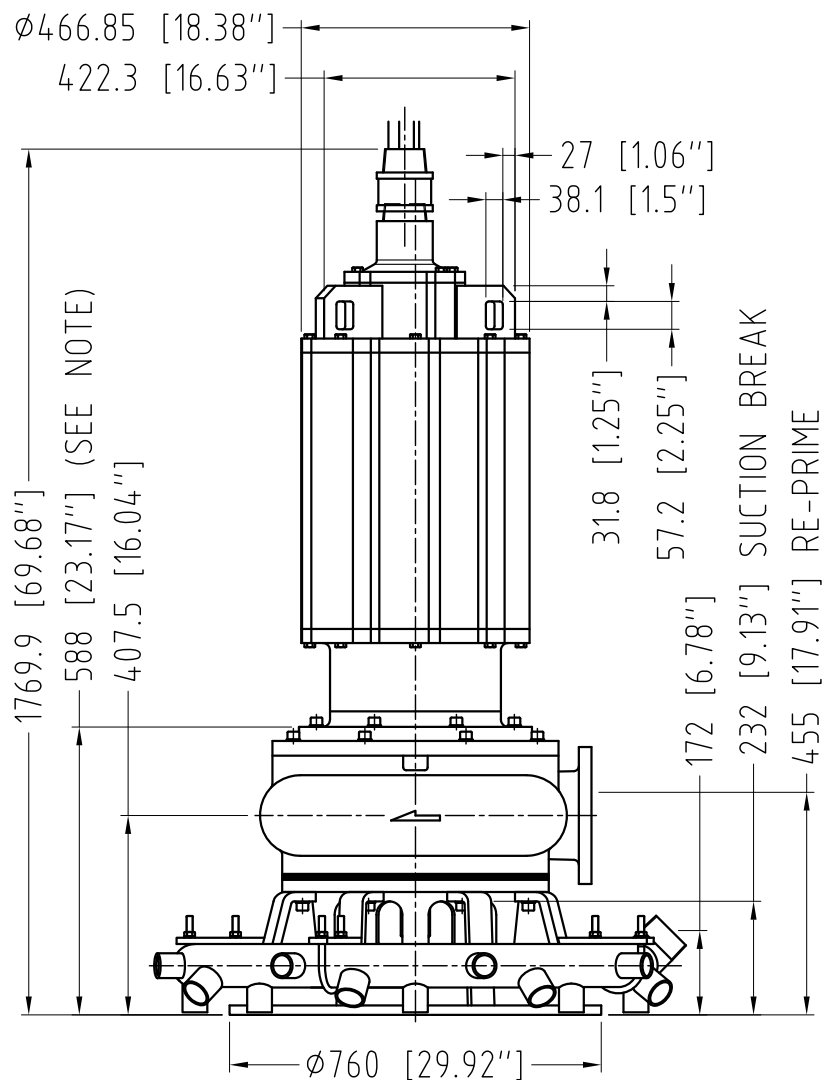

**NOTE:**  
 MIN. SUBMERGENCE FOR MOTOR  
 MODULES EQUIPPED WITH  
 WATER JACKETS ONLY

GENERAL ARRANGEMENT, WEIGHTS  
 TBM 150 MH-PHO, PBO, PVO (100-125HP 6P/8P Motors)  
 OPTIONAL WATER JET RING (100-150 HP 4P Motors)

DRAWING NBR.: A0643 REV.: 0

EFFECTIVE DATE : 08/05/2012

**POLARIS**  
 P U M P S

PUMP MODEL	WEIGHT (lbs.)	WEIGHT (kg)
TBM 150 MH - PHO	2451	1114
TBM 150 MH - PBO	2691	1223
TBM 150 MH - PVO	2693	1224





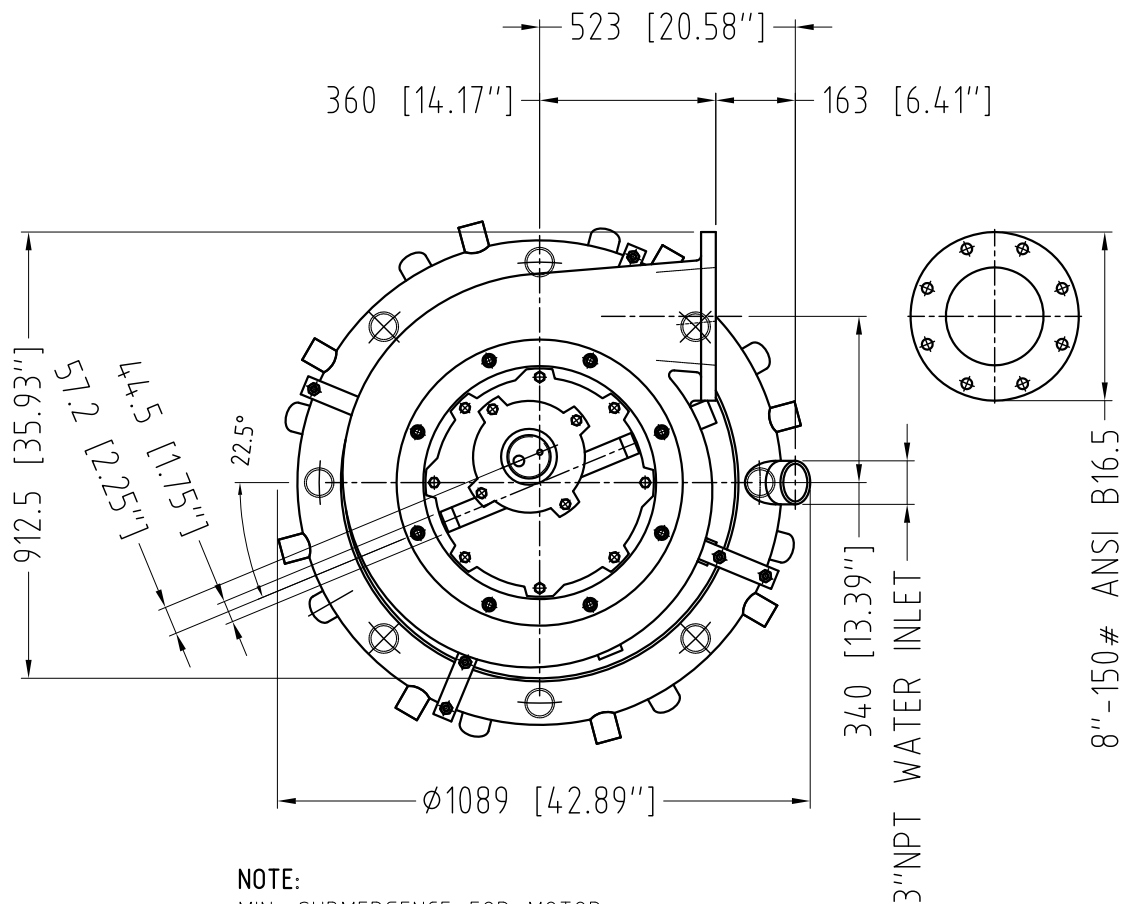
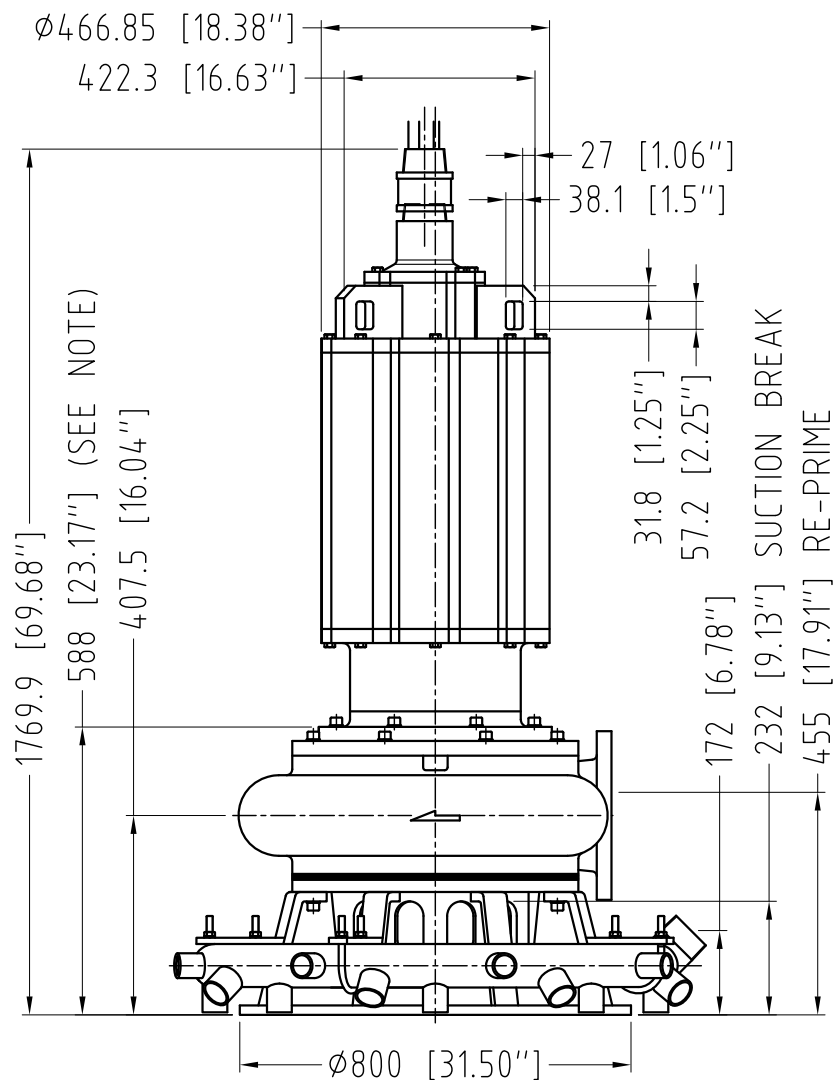

NOTE:  
MIN. SUBMERGENCE FOR MOTOR  
MODULES EQUIPPED WITH  
WATER JACKETS ONLY

GENERAL ARRANGEMENT, WEIGHTS  
TBM 200 MH-PHO, PBO, PVO (75 - 125 HP 6P Motors)  
OPTIONAL WATER JET RING (60 - 150 HP 8P Motors)

DRAWING NBR.: A0652 REV.: 0

EFFECTIVE DATE : 08/05/2012

**POLARIS**  
PUMPS

PUMP MODEL	WEIGHT (lbs.)	WEIGHT (kg)
TBM 200 MH - PHO	2785	1266
TBM 200 MH - PBO	2805	1275
TBM 200 MH - PVO	2810	1277

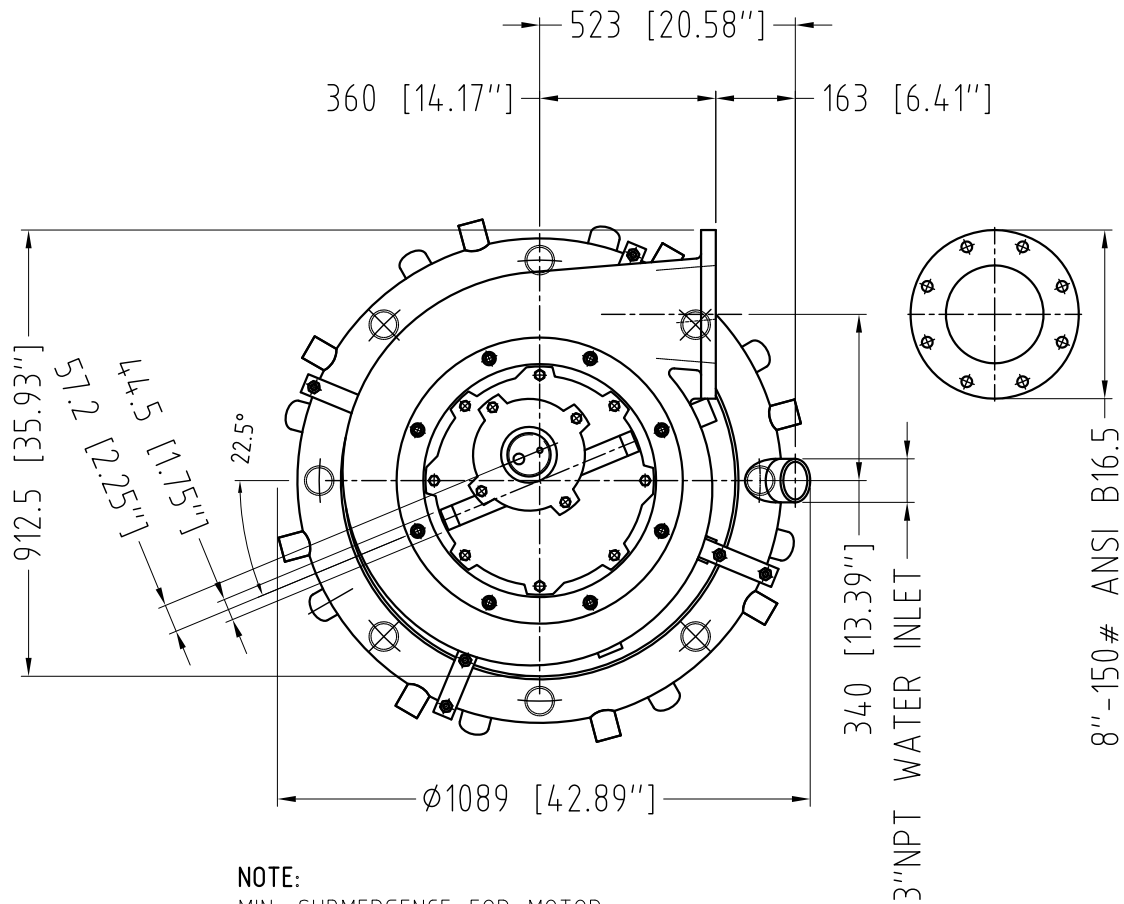
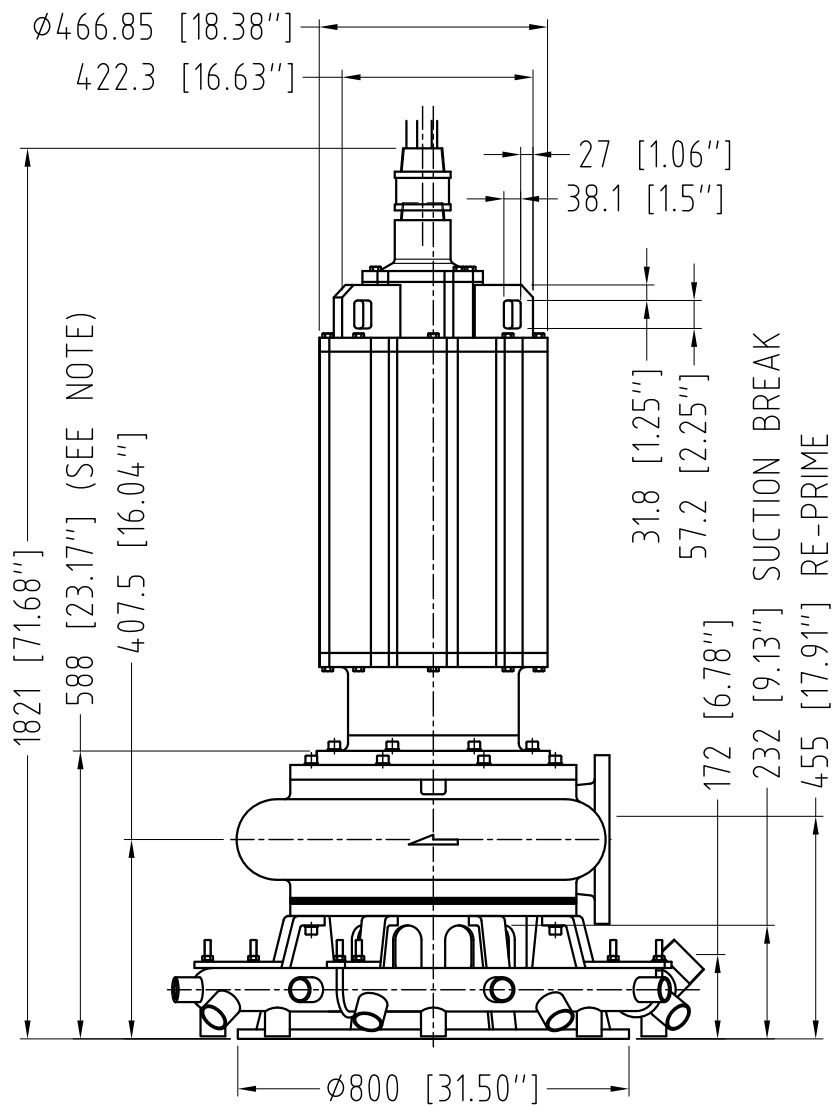

NOTE:  
MIN. SUBMERGENCE FOR MOTOR  
MODULES EQUIPPED WITH  
WATER JACKETS ONLY

GENERAL ARRANGEMENT, WEIGHTS  
TBM 200 MH-PHO, PBO, PVO (150 HP 6P Motor)  
OPTIONAL WATER JET RING

DRAWING NBR.: A0653 REV.: 0

EFFECTIVE DATE : 08/05/2012

**POLARIS**  
PUMPS

PUMP MODEL	WEIGHT (lbs.)	WEIGHT (kg)
TBM 200 MH - PHO	2785	1266
TBM 200 MH - PBO	2805	1275
TBM 200 MH - PVO	2810	1277