



P U M P S

ORIGINAL SOLUTIONS. NO COMPROMISES.

ASSEMBLY INSTRUCTIONS, JET WATER PERFORMANCE CURVES, GA DRAWINGS					1 of 1
OPTIONAL WATER JET RING, SERIES TBM					
DOCUMENT NBR. :	A0659	REVISION:	1	EFFECTIVE DATE:	05/06/25



LLC

0		NEW	UJB		08/05/2012
1		GENERAL UPDATE	UJB		05/06/2025
REV	ECN	CHANGE DESCRIPTION	BY	APPV'D	DATE

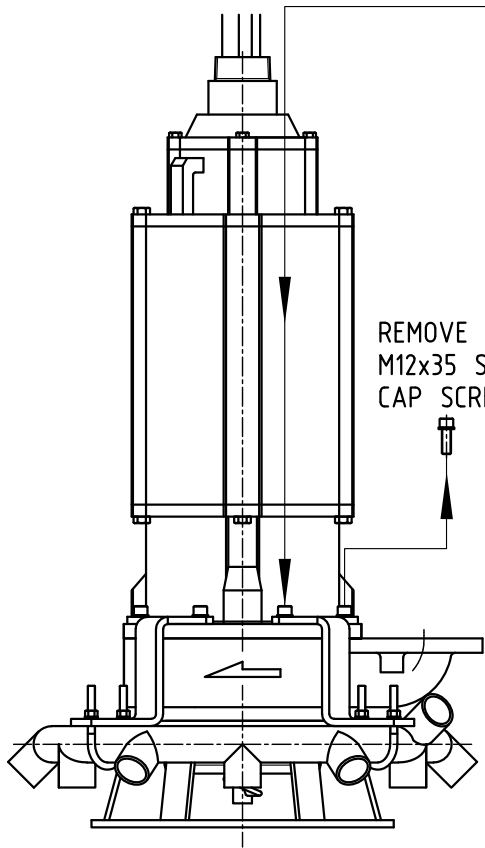

REMOVE (8) ORIGINAL
M12x35 SOCKET HEAD
CAP SCREWS

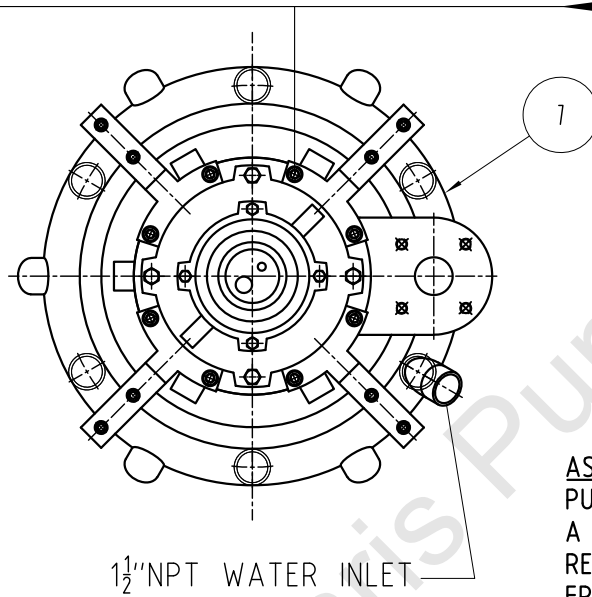

1 1/2" NPT WATER INLET

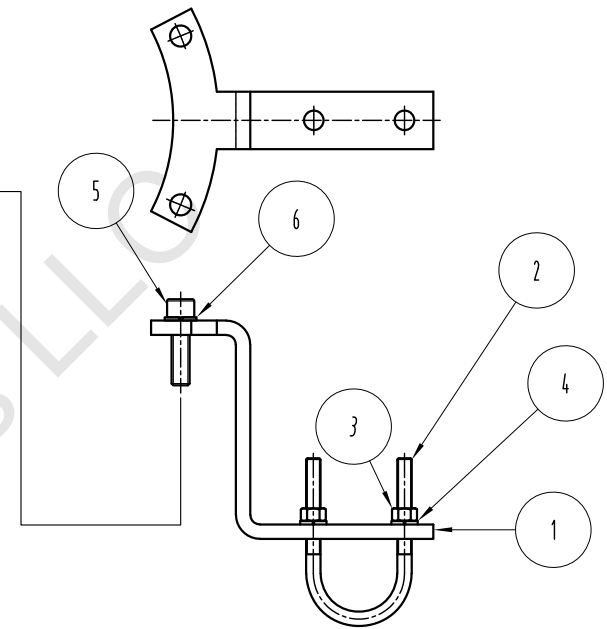

ASSEMBLY INSTRUCTIONS:

PUMP MUST BE STANDING UPRIGHT ON THE PUMP STAND ON A FLAT AND LEVEL SURFACE.

REMOVE THE ORIGINAL (8) M12x35 SOCKET HEAD CAP SCREWS FROM THE MOTOR FLANGE.

POSITION AND ATTACH THE (4) MOUNTING BRACKETS (ITEM 1) AS SHOWN WITH THE (8) M12x45 SOCKET HEAD CAP SCREWS AND LOCK WASHERS (ITEMS 5,6). APPLY Loctite® 242 AND RE-TIGHTEN TO 62 Nm (46 lb/ft).

RAISE THE PUMP OFF THE GROUND AND POSITION THE WATER JET RING ASSEMBLY UNDER THE PUMP STAND WITH THE WATER INLET POSITIONED AS SHOWN.

LOWER THE PUMP BACK TO THE FLOOR. USE THE 3/8 U-BOLTS, HEX NUTS AND LOCK WASHERS (ITEMS 2,3,4) TO ATTACH THE WATER JET RING (ITEM 7) TO THE BRACKETS. APPLY Loctite® 242 AND TIGHTEN TO 62 Nm (46 lb/ft).

ASSEMBLY INSTRUCTIONS
OPTIONAL WATER JET RING
TBM 50LH, 75LH

DRAWING NBR.: A0655

REV.: 1

EFFECTIVE DATE : 05/06/25

POLARIS
PUMPS

PUMP MODEL	JET RING BRACKET KIT	WATER JET RING
TBM50LH	973.200.05.01628	973.200.05.01577
TBM75LH		
FOR WATER JET RING PERFORMANCE CURVE SEE:		A0638

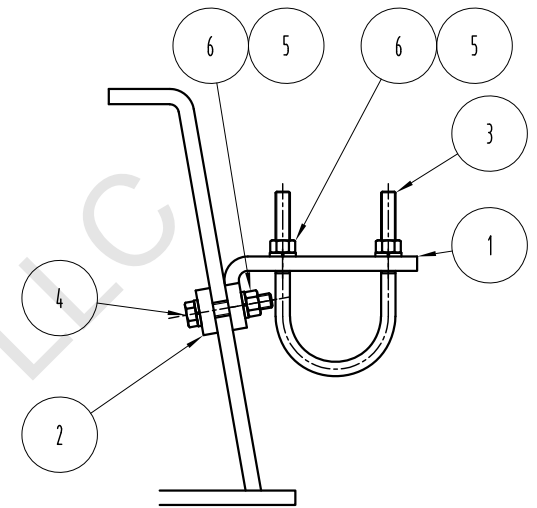
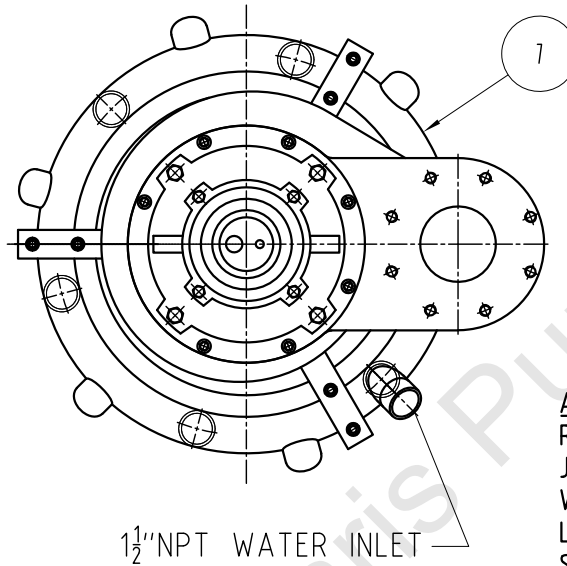
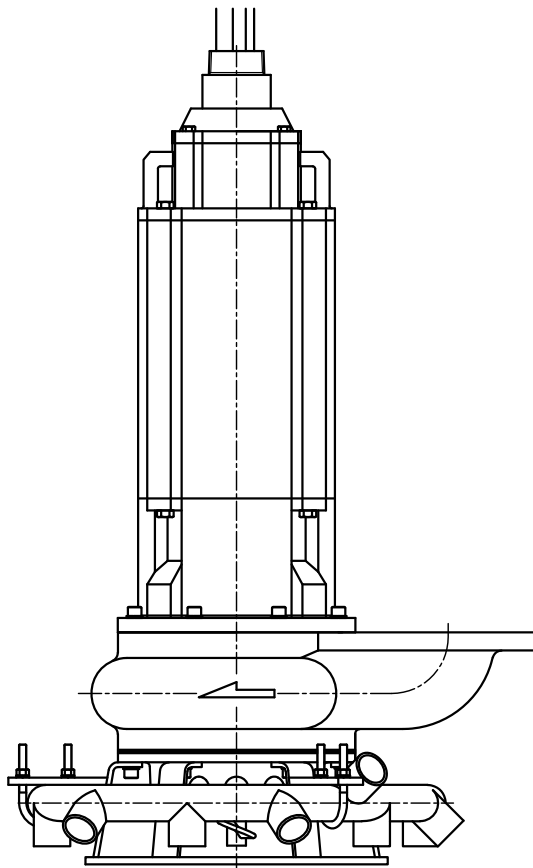

ASSEMBLY INSTRUCTIONS:

RAISE THE PUMP OFF THE GROUND AND POSITION THE WATER JET RING ASSEMBLY UNDER THE PUMP STAND WITH THE WATER INLET POSITIONED AS SHOWN.

LOWER THE PUMP BACK ONTO THE FLOOR. PUMP MUST BE STANDING UPRIGHT ON THE PUMP STAND ON A FLAT AND LEVEL SURFACE.

POSITION AND LOOSELY ATTACH THE (3) MOUNTING BRACKETS AND CLAMP PLATES (ITEM 1/2) TO THE PUMP STAND LEGS AS SHOWN WITH THE (6) 3/8"x2 HEX HEAD CAP SCREWS, HEX NUTS AND LOCK WASHERS (ITEMS 4/5/6).

USE THE U-BOLTS, HEX NUTS AND LOCK WASHERS (ITEMS 3/5/6) TO ATTACH THE WATER JET RING (ITEM 7) TO THE BRACKETS. APPLY Loctite© 242 AND TIGHTEN ALL FASTENERS TO 62 Nm (46 lb/ft).

ASSEMBLY INSTRUCTIONS
OPTIONAL WATER JET RING
TBM 100LH

DRAWING NBR.: A0656

REV.: 1

EFFECTIVE DATE : 05/06/25

POLARIS
PUMPS

PUMP MODEL	JET RING BRACKET KIT	WATER JET RING
TBM100LH	973.200.05.01572	973.200.05.01577
FOR WATER JET RING PERFORMANCE CURVE SEE:		A0638

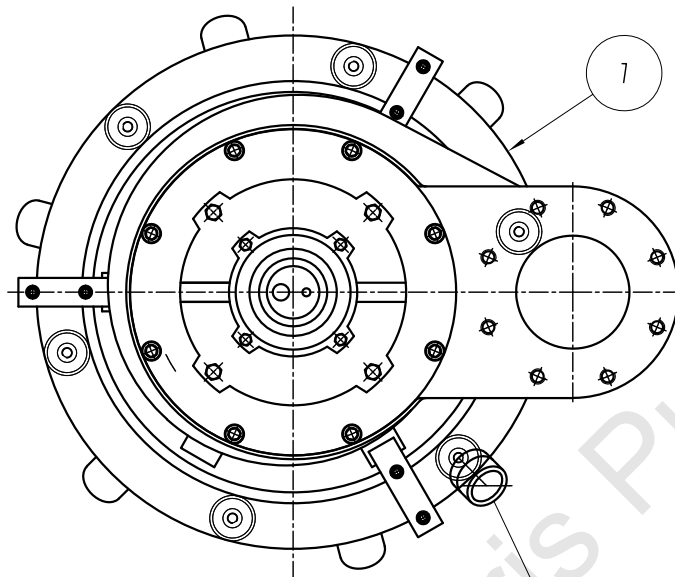
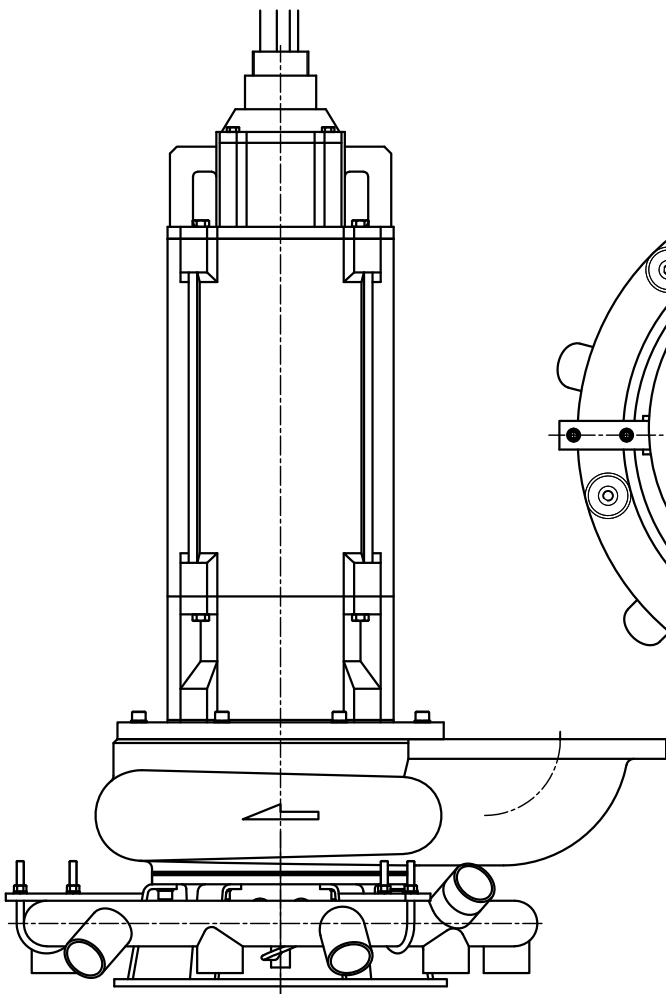

2" NPT WATER INLET

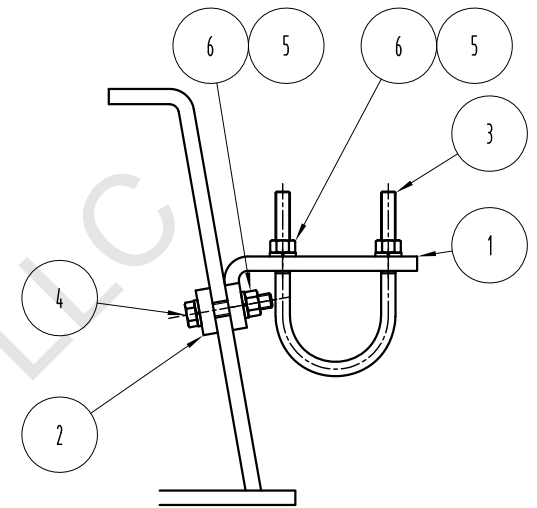

ASSEMBLY INSTRUCTIONS:

RAISE THE PUMP OFF THE GROUND AND POSITION THE WATER JET RING ASSEMBLY UNDER THE PUMP STAND WITH THE WATER INLET POSITIONED AS SHOWN.

LOWER THE PUMP BACK ONTO THE FLOOR. PUMP MUST BE STANDING UPRIGHT ON THE PUMP STAND ON A FLAT AND LEVEL SURFACE.

POSITION AND LOOSELY ATTACH THE (3) MOUNTING BRACKETS AND CLAMP PLATES (ITEM 1/2) TO THE PUMP STAND LEGS AS SHOWN WITH THE (6) $\frac{3}{8}$ x2 HEX HEAD CAP SCREWS, HEX NUTS AND LOCK WASHERS (ITEMS 4/5/6).

USE THE U-BOLTS, HEX NUTS AND LOCK WASHERS (ITEMS 3/5/6) TO ATTACH THE WATER JET RING (ITEM 7) TO THE BRACKETS. APPLY Loctite® 242 AND TIGHTEN ALL FASTENERS TO 62 Nm (46 lb/ft).

ASSEMBLY INSTRUCTIONS
OPTIONAL WATER JET RING
TBM 150LH, 75MH, 100MH

DRAWING NBR.: A0657

REV.: 0

EFFECTIVE DATE : 05/06/25

POLARIS
PUMPS

PUMP MODEL	JET RING BRACKET KIT	WATER JET RING
TBM150LH	973.200.05.01539	
TBM75MH	973.200.05.01550	973.200.05.01545
TBM100MH		
FOR WATER JET RING PERFORMANCE CURVE SEE:		A0637

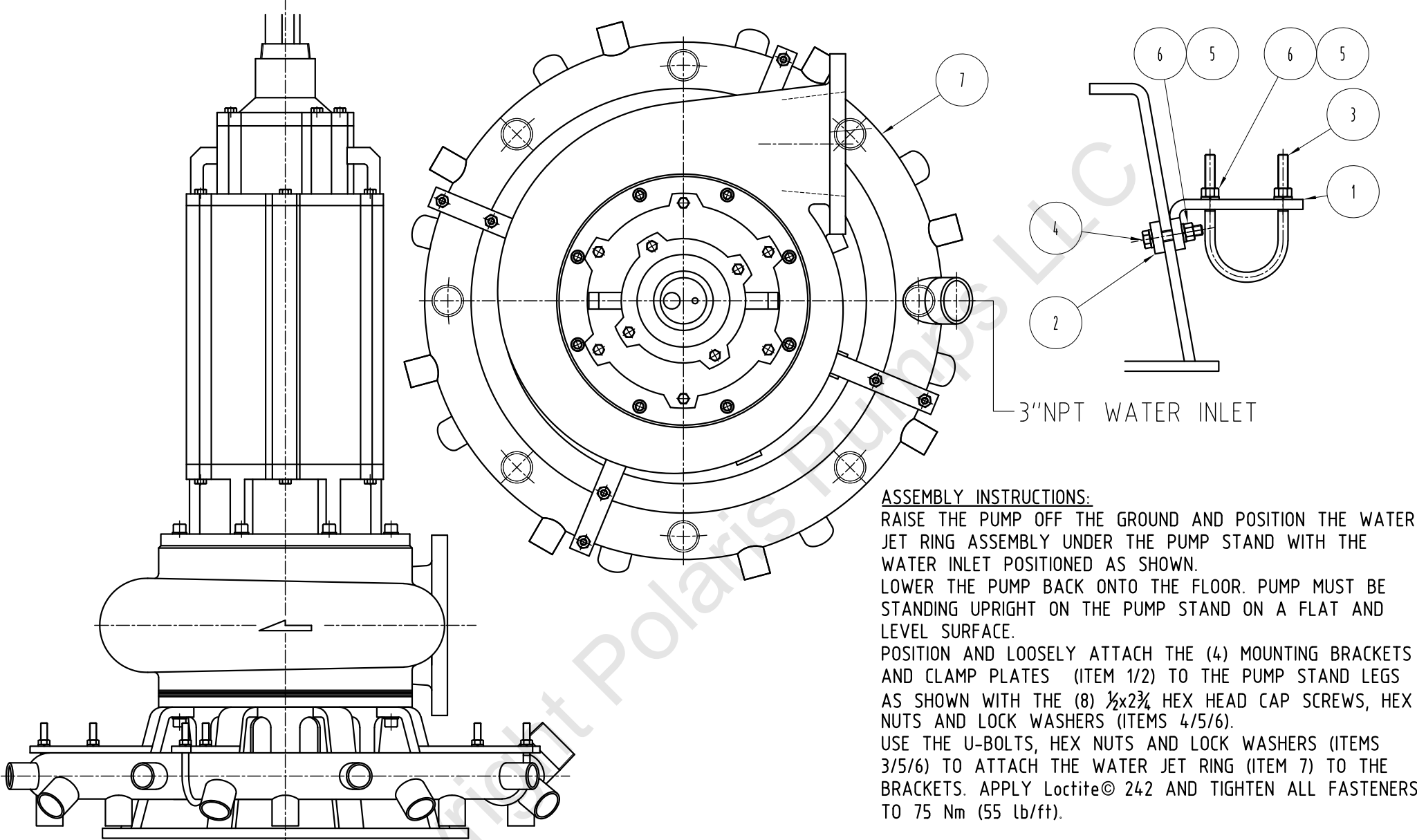

ASSEMBLY INSTRUCTIONS:

RAISE THE PUMP OFF THE GROUND AND POSITION THE WATER JET RING ASSEMBLY UNDER THE PUMP STAND WITH THE WATER INLET POSITIONED AS SHOWN.

LOWER THE PUMP BACK ONTO THE FLOOR. PUMP MUST BE STANDING UPRIGHT ON THE PUMP STAND ON A FLAT AND LEVEL SURFACE.

POSITION AND LOOSELY ATTACH THE (4) MOUNTING BRACKETS AND CLAMP PLATES (ITEM 1/2) TO THE PUMP STAND LEGS AS SHOWN WITH THE (8) 1/2x2 3/4 HEX HEAD CAP SCREWS, HEX NUTS AND LOCK WASHERS (ITEMS 4/5/6).

USE THE U-BOLTS, HEX NUTS AND LOCK WASHERS (ITEMS 3/5/6) TO ATTACH THE WATER JET RING (ITEM 7) TO THE BRACKETS. APPLY Loctite© 242 AND TIGHTEN ALL FASTENERS TO 75 Nm (55 lb/ft).

ASSEMBLY INSTRUCTIONS
 OPTIONAL WATER JET RING
 TBM 200LH, 150MH, 200MH

DRAWING NBR.: A0658 REV.: 1

EFFECTIVE DATE : 06/06/25

POLARIS
 P U M P S

PUMP MODEL	JET RING BRACKET KIT	WATER JET RING
TBM200LH	973.200.05.01555	
TBM150MH	973.200.05.01556	973.200.05.01516
TBM200MH	973.200.05.01521	
FOR WATER JET RING PERFORMANCE CURVE SEE:		A0636

POLARIS

PUMPS

PUMP MODEL TBM50LH TBM75LH TBM100LH	CURVE NBR.: A0638	JET RING PART NUMBER: 971.200.05.01576 (A53Gr.B)
	REVISION : 1	971.200.05.01577 (316SS)
	TEST NBR.: N/A	JET RING WATER INLET ϕ : 1 1/2" NPT
	EFFECTIVE DATE : 05/06/25	PERFORMANCE FOR <u>CLEAR WATER</u> @ 68°F/20°C AND 1.0 S.G.
	APPROVED BY : UJB	MAXIMUM JET RING WORKING PRESSURE = 150PSI

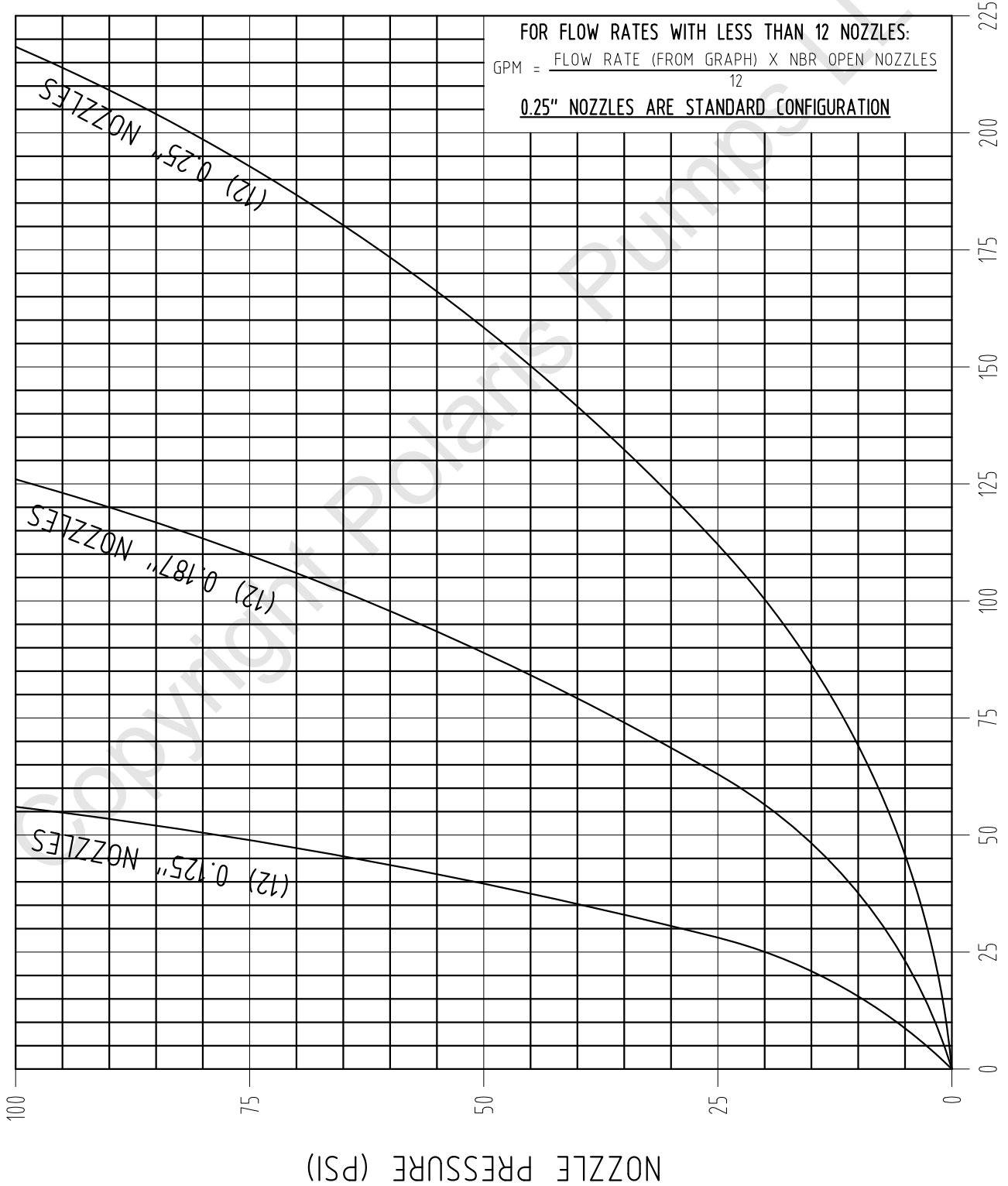

JET RING FLOW RATE (U.S.G.P.M.)

POLARIS

PUMPS

PUMP MODEL TBM150LH TBM75MH TBM100MH	CURVE NBR.: A0637	JET RING PART NUMBER: 971.200.05.01545 (A53Gr.B)
	REVISION : 1	971.200.05.01707 (316SS)
	TEST NBR.: N/A	JET RING WATER INLET ϕ : 2" NPT
	EFFECTIVE DATE : 05/06/25	PERFORMANCE FOR <u>CLEAR WATER</u> @ 68°F/20°C AND 1.0 S.G.
	APPROVED BY : UJB	MAXIMUM JET RING WORKING PRESSURE = 150PSI

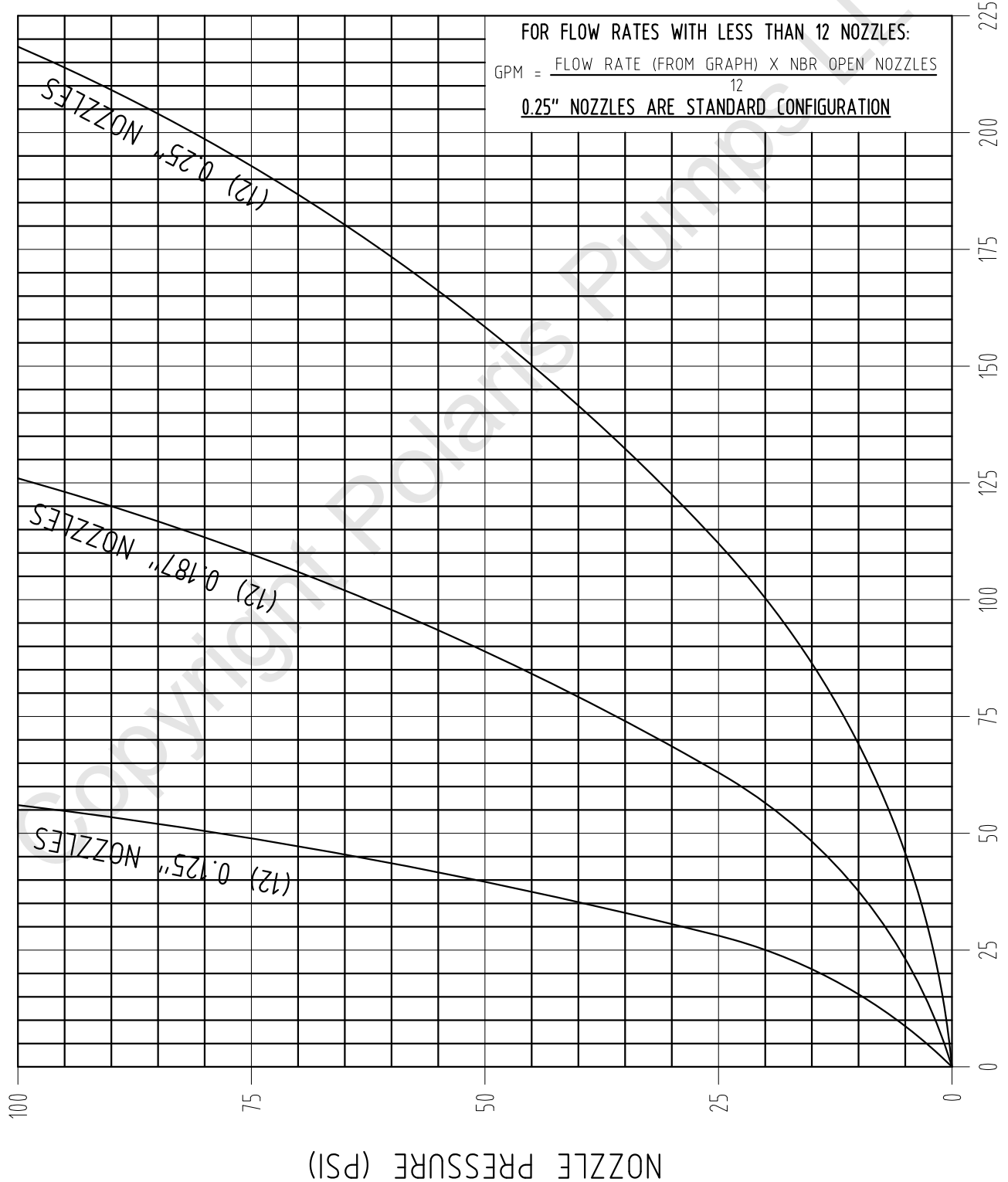

JET RING FLOW RATE (U.S.G.P.M.)

POLARIS

PUMPS

PUMP MODEL TBM200LH TBM150MH TBM200MH	CURVE NBR.: A0636	JET RING PART NUMBER: 971.200.05.01516 (A53Gr.B)
	REVISION : 2	971.200.05.01965 (316SS)
	TEST NBR.: N/A	JET RING WATER INLET ϕ : 3" NPT
	EFFECTIVE DATE : 05/06/25	PERFORMANCE FOR <u>CLEAR WATER</u> @ 68°F/20°C AND 1.0 S.G.
	APPROVED BY : UJB	MAXIMUM JET RING WORKING PRESSURE = 150PSI

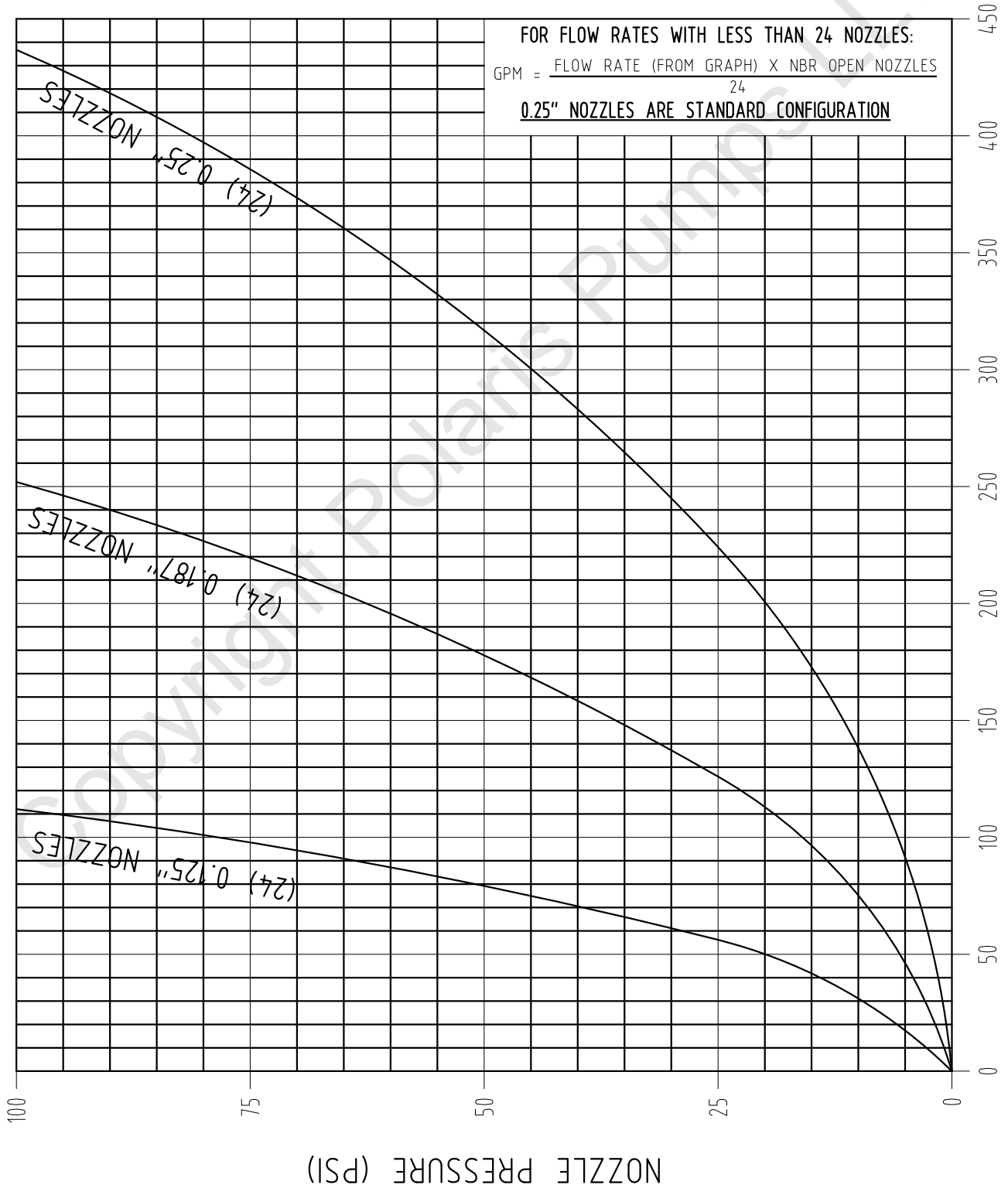

JET RING FLOW RATE (U.S.G.P.M.)

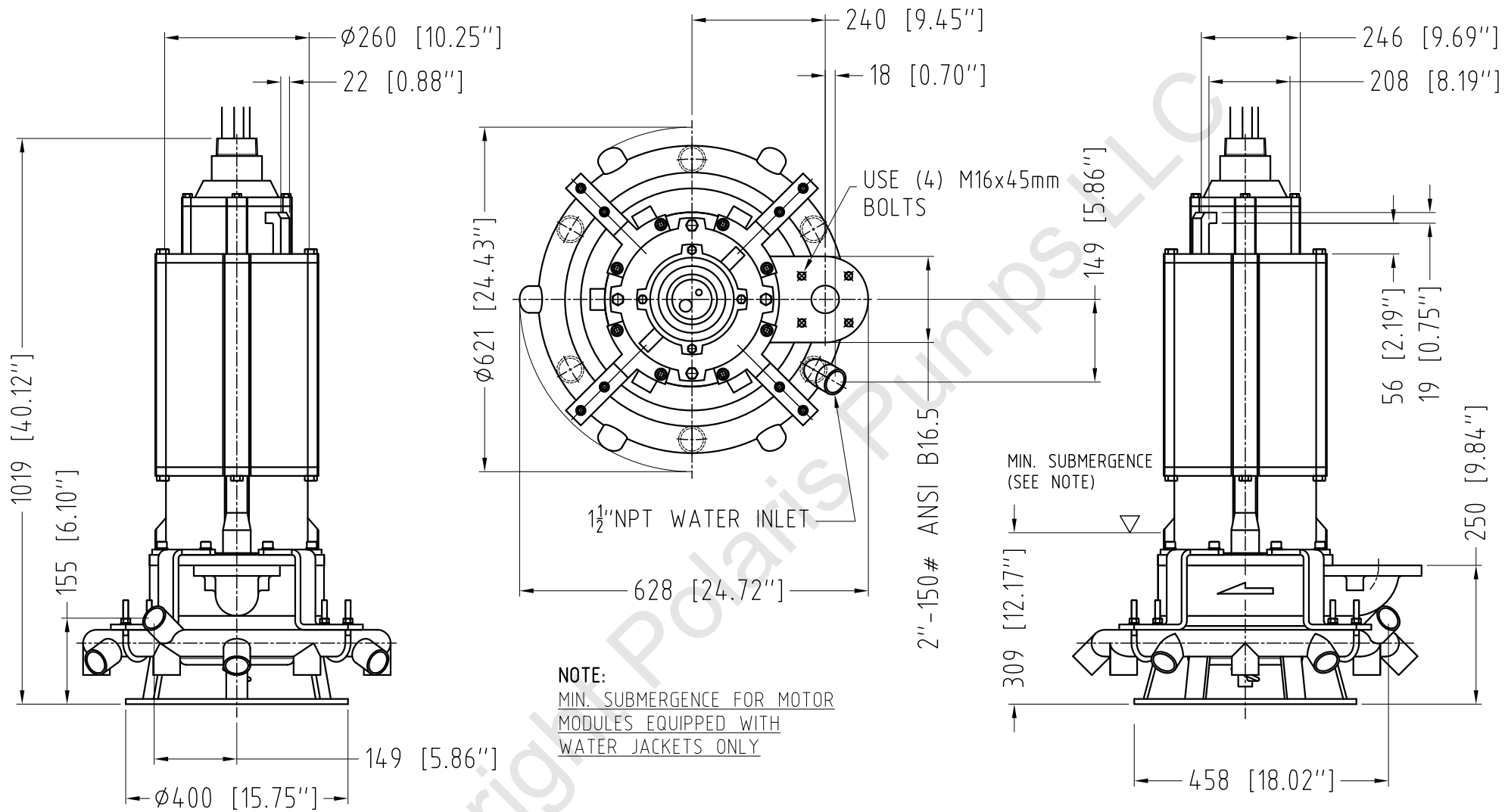

GENERAL ARRANGEMENT, WEIGHTS
 TBM 50 LH-PHO, PBO, PVO (5 - 10HP 4P ISS Motors)
 OPTIONAL WATER JET RING

DRAWING NBR.: A0647 REV.: 0

EFFECTIVE DATE : 08/05/2012

POLARIS
 P U M P S

PUMP MODEL	WEIGHT (lbs.)	WEIGHT (kg)
TBM 50 LH - PHO	506	230
TBM 50 LH - PBO	508	231
TBM 50 LH - PVO	511	232

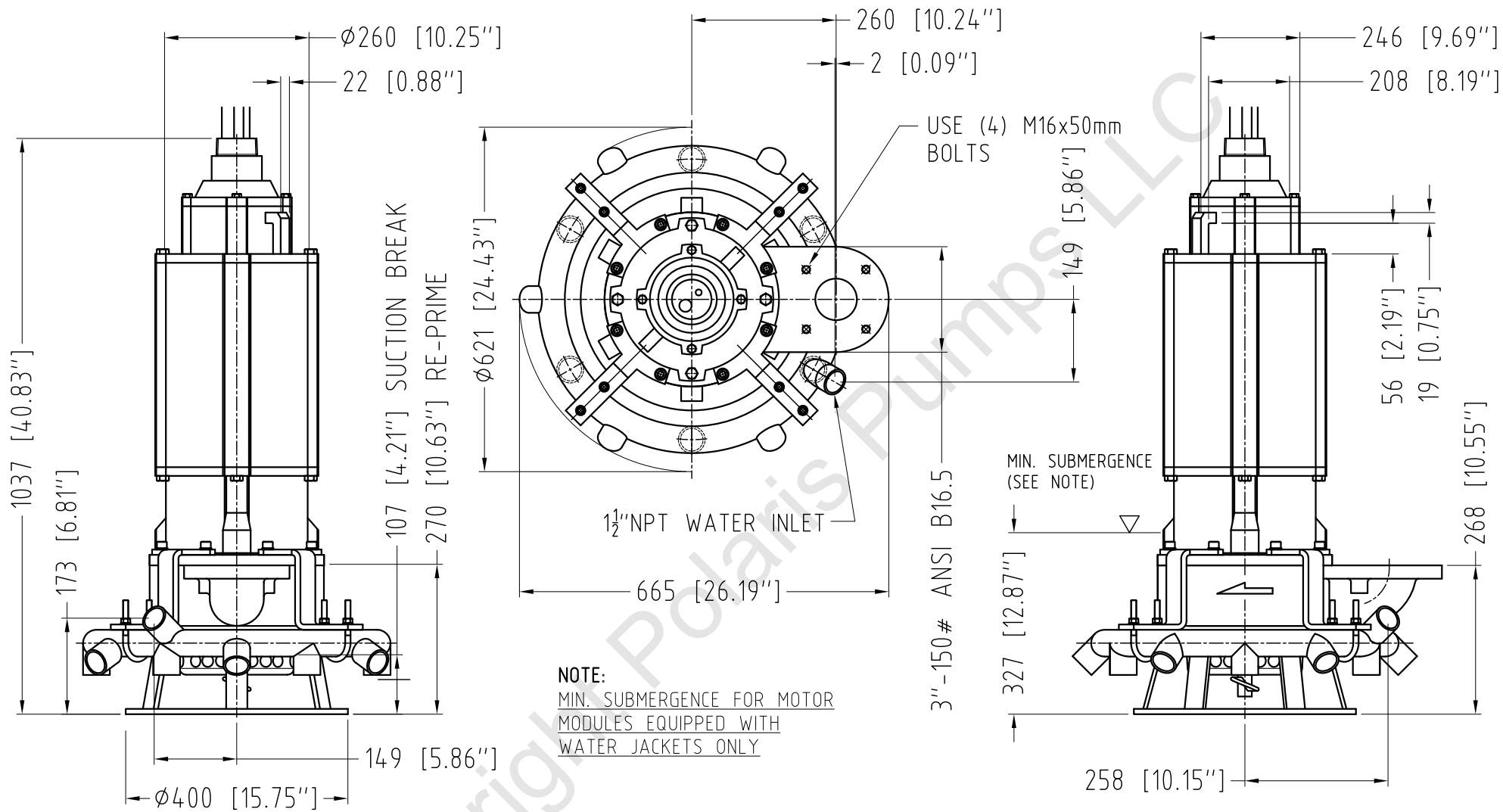

GENERAL ARRANGEMENT, WEIGHTS	
TBM 75 LH-PHO, PBO, PVO (5 - 10 HP 4P ISS Motors)	
OPTIONAL WATER JET RING	
DRAWING NBR.: A0651	REV.: 0
EFFECTIVE DATE : 08/05/2012	

P **L A R I S**
 P U M P S

PUMP MODEL	WEIGHT (lbs.)	WEIGHT (kg)
TBM 75 LH - PHO	528	240
TBM 75 LH - PBO	530.2	241
TBM 75 LH - PVO	531.3	241.5

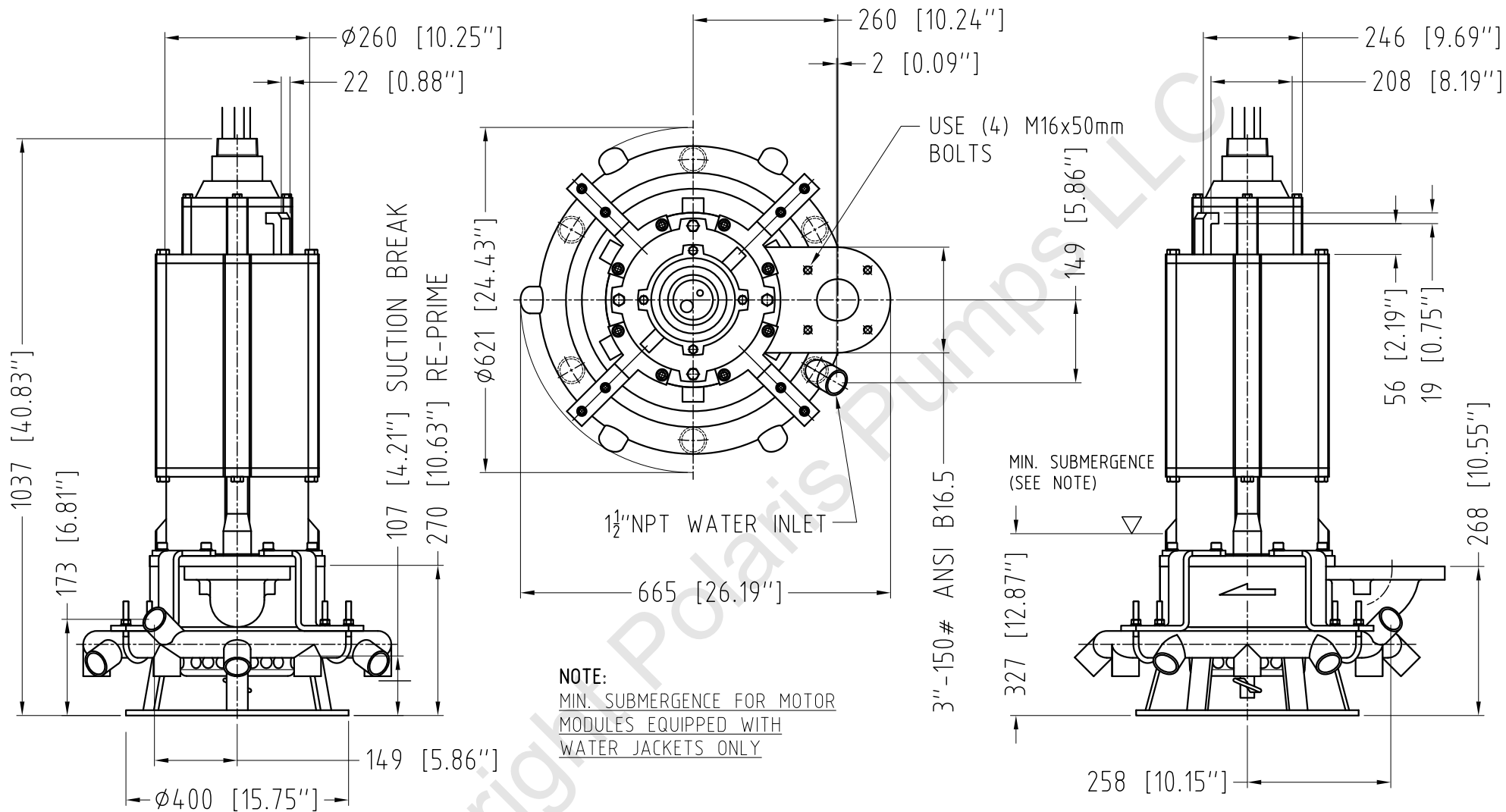

NOTE:
 MIN. SUBMERGENCE FOR MOTOR
 MODULES EQUIPPED WITH
 WATER JACKETS ONLY

GENERAL ARRANGEMENT, WEIGHTS	
TBM 75 LH-PHO, PBO, PVO (10 - 20 HP 4P Motors)	
OPTIONAL WATER JET RING	
DRAWING NBR.: A0607	REV.: 1
EFFECTIVE DATE : 08/05/2012	

POLARIS
 P U M P S

PUMP MODEL	WEIGHT (lbs.)	WEIGHT (kg)
TBM 75 LH - PHO	528	240
TBM 75 LH - PBO	530.2	241
TBM 75 LH - PVO	531.3	241.5

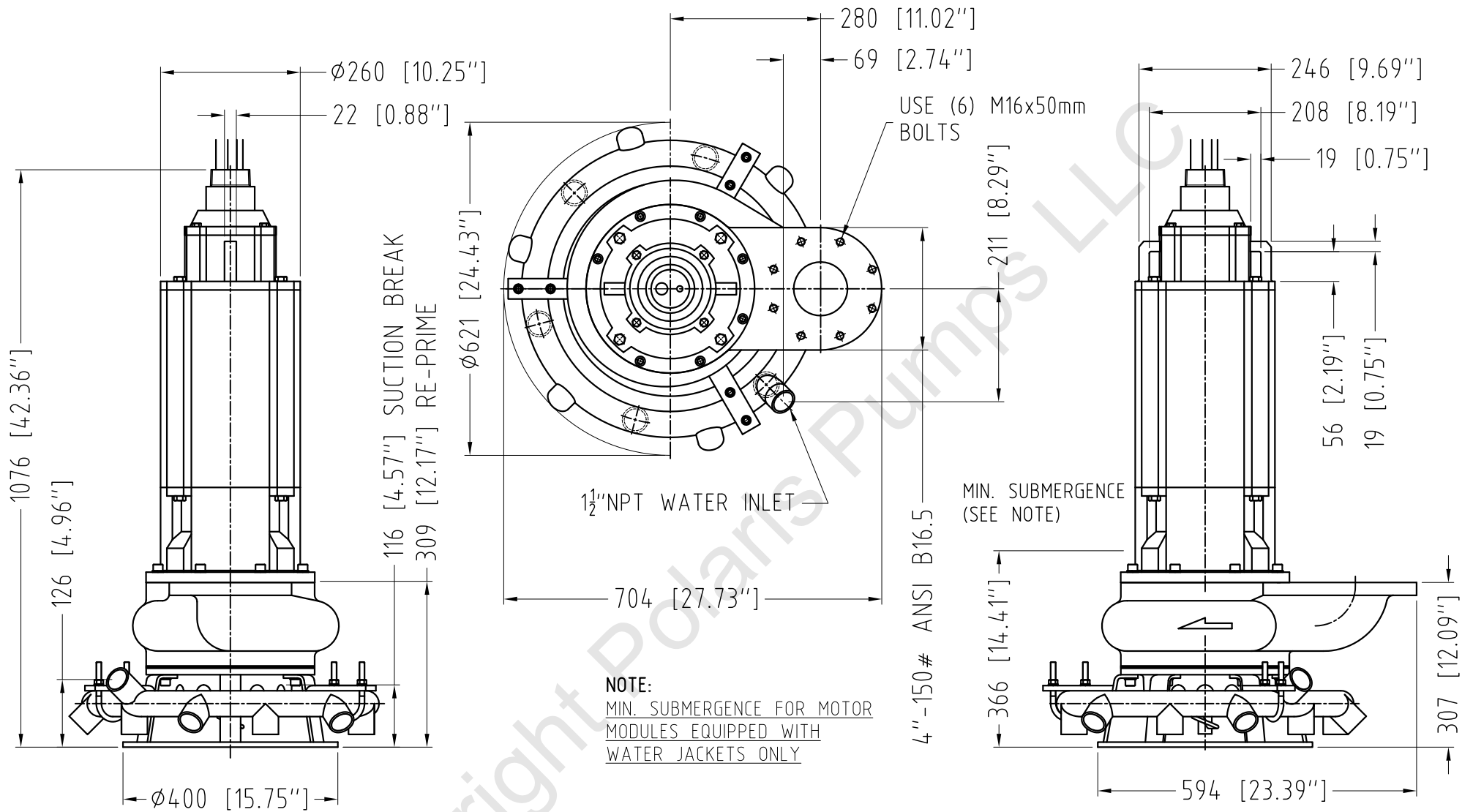

GENERAL ARRANGEMENT, WEIGHTS TBM 100 LH-PHO, PBO, PVO (15 - 20 HP 4P Motors) OPTIONAL WATER JET RING	
DRAWING NBR.: A0629	REV.: 0
EFFECTIVE DATE : 08-09-2011	

POLARIS
PUMPS

PUMP MODEL	WEIGHT (lbs.)	WEIGHT (kg)
TBM 100 LH - PHO	558.8	254
TBM 100 LH - PBO	561	255
TBM 100 LH - PVO	562	255.5

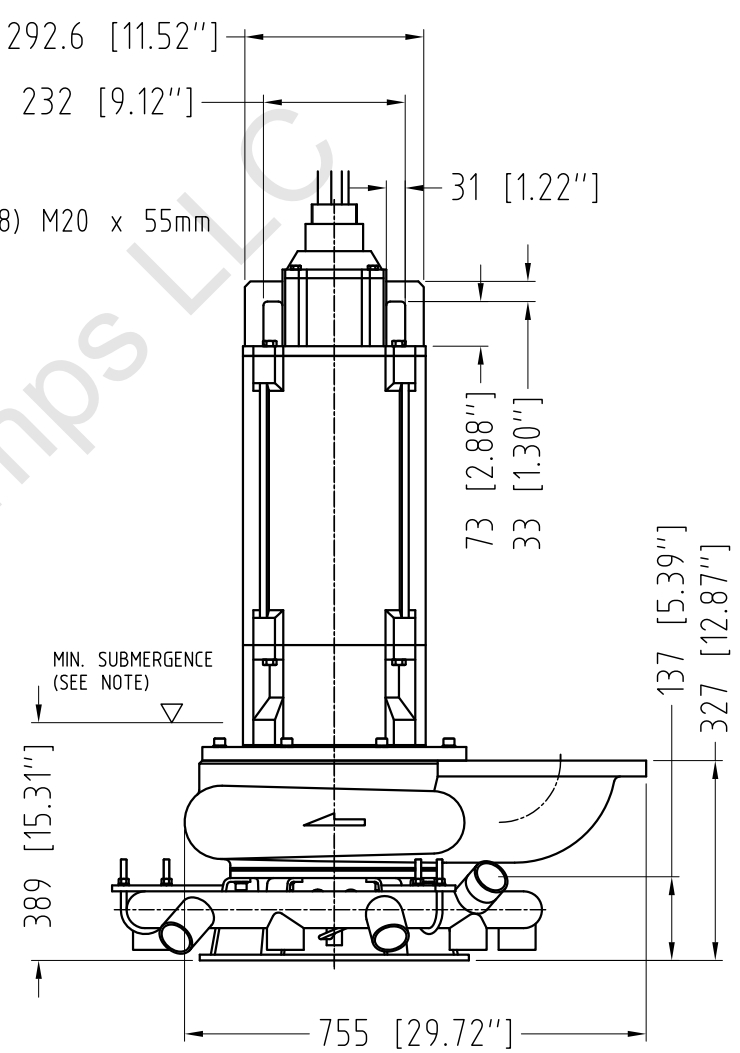
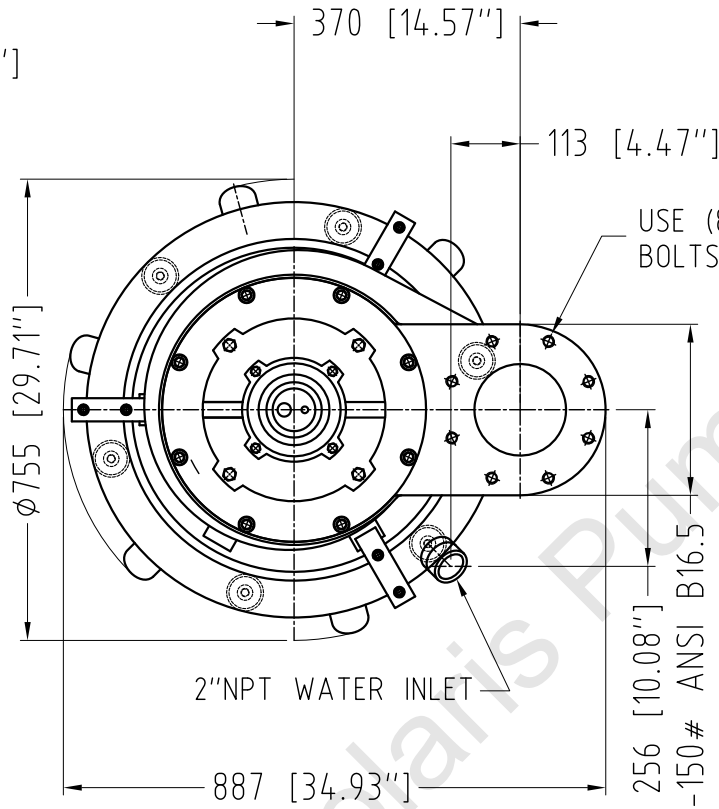
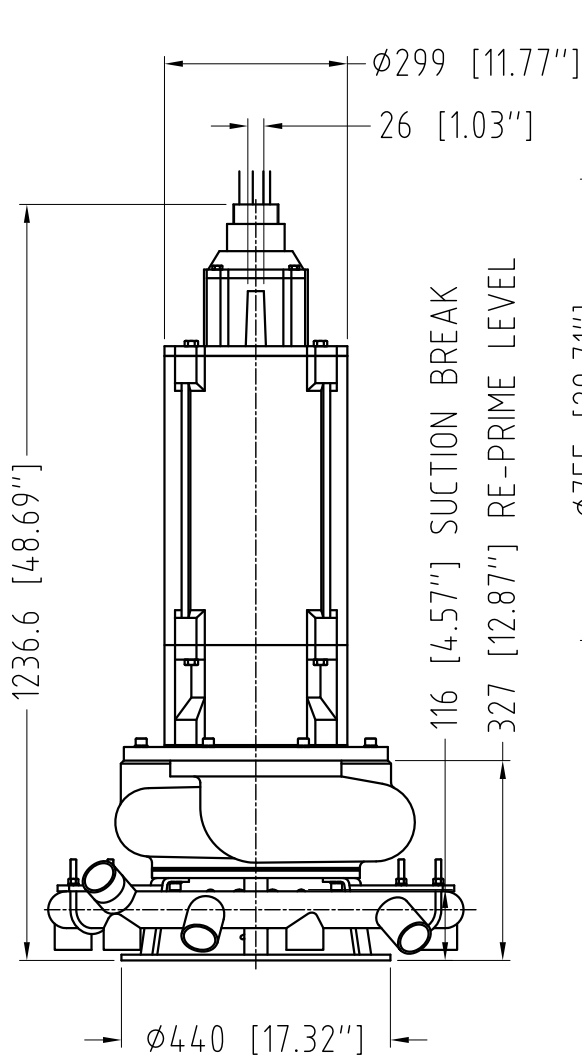

NOTE:
 MIN. SUBMERGENCE FOR MOTOR
 MODULES EQUIPPED WITH
 WATER JACKETS ONLY

GENERAL ARRANGEMENT, WEIGHTS TBM 150 LH-PHO, PBO, PVO (OPTIONAL WATER JET RING) (25-40HP 4P, 15-25 HP 6P Motors)	
DRAWING NBR.: A0645	REV.: 0
EFFECTIVE DATE : 08/05/2012	

POLARIS
 P U M P S

PUMP MODEL	WEIGHT (lbs.)	WEIGHT (kg)
TBM 150 LH - PHO	1101	501
TBM 150 LH - PBO	1106	503
TBM 150 LH - PVO	1108	504

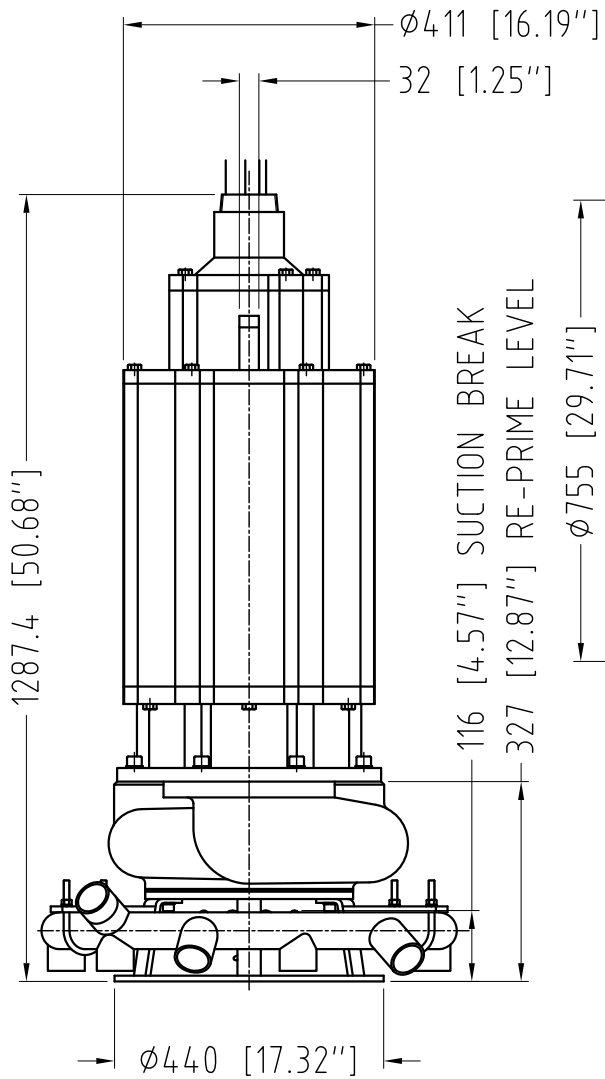

116 [4.57"] SUCTION BREAK
327 [12.87"] RE-PRIME LEVEL

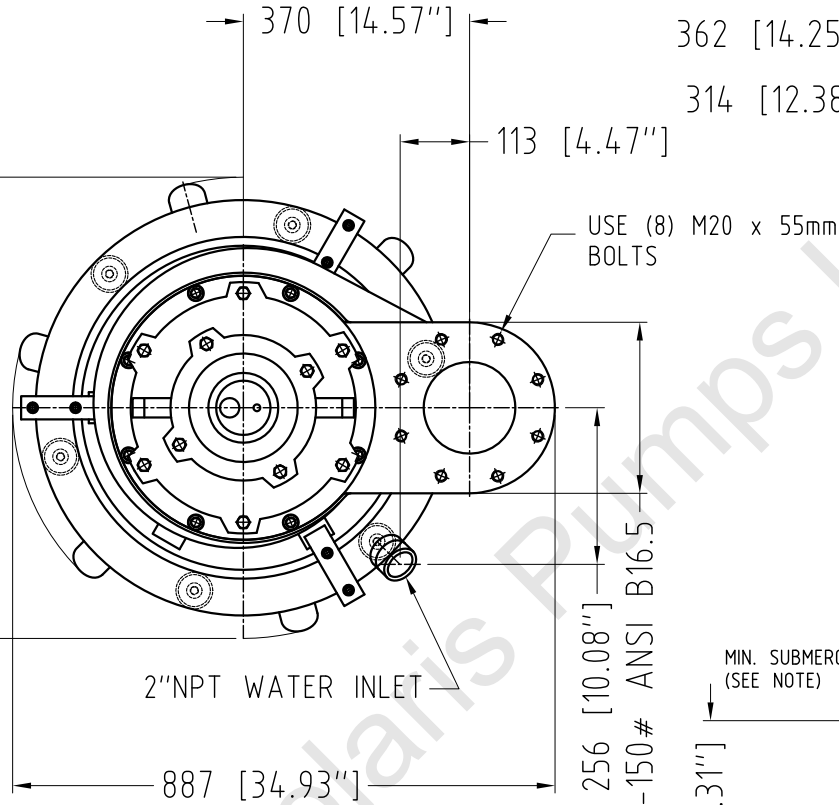

2" NPT WATER INLET

USE (8) M20 x 55mm BOLTS

NOTE:
MIN. SUBMERGENCE FOR MOTOR
MODULES EQUIPPED WITH
WATER JACKETS ONLY



MIN. SUBMERGENCE
(SEE NOTE)

GENERAL ARRANGEMENT, WEIGHTS TBM 150 LH-PHO, PBO, PVO (OPTIONAL WATER JET RING) (30-40HP 6P, 50-75HP 4P Motors)	
DRAWING NBR.: A0646	REV.: 0
EFFECTIVE DATE : 08/05/2012	

POLARIS
PUMPS

PUMP MODEL	WEIGHT (lbs.)	WEIGHT (kg)
TBM 150 LH - PHO	1503	683
TBM 150 LH - PBO	1506	684
TBM 150 LH - PVO	1507	685

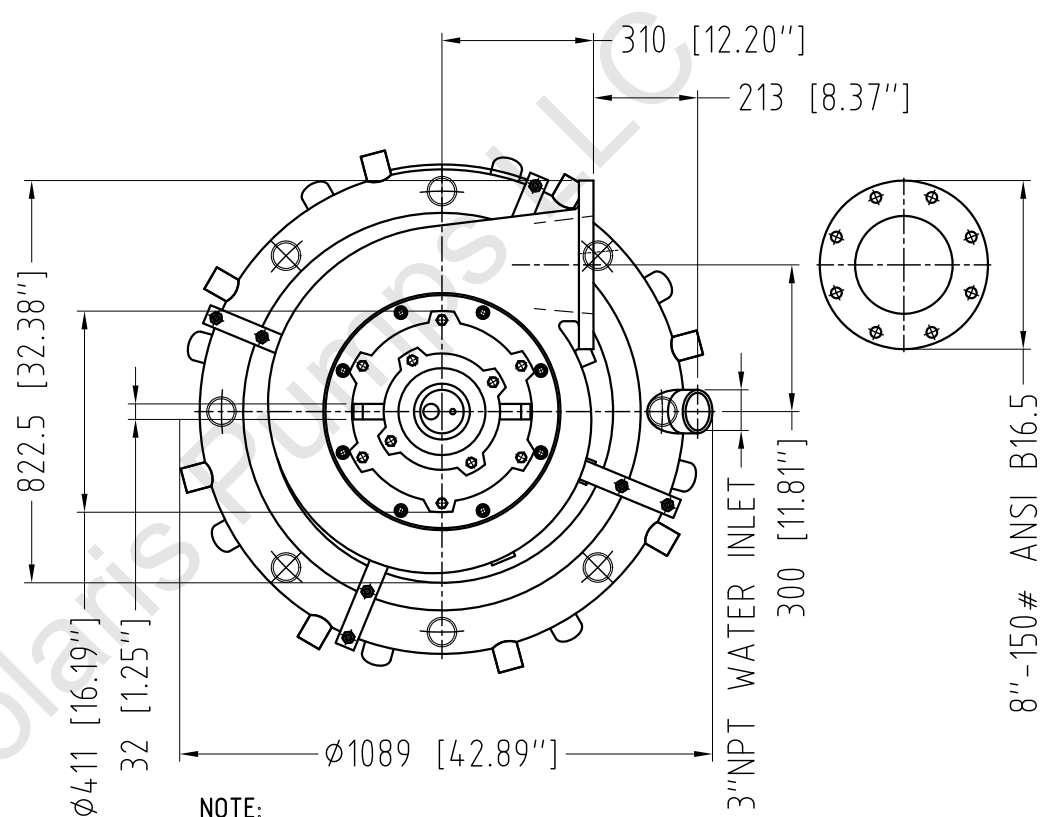
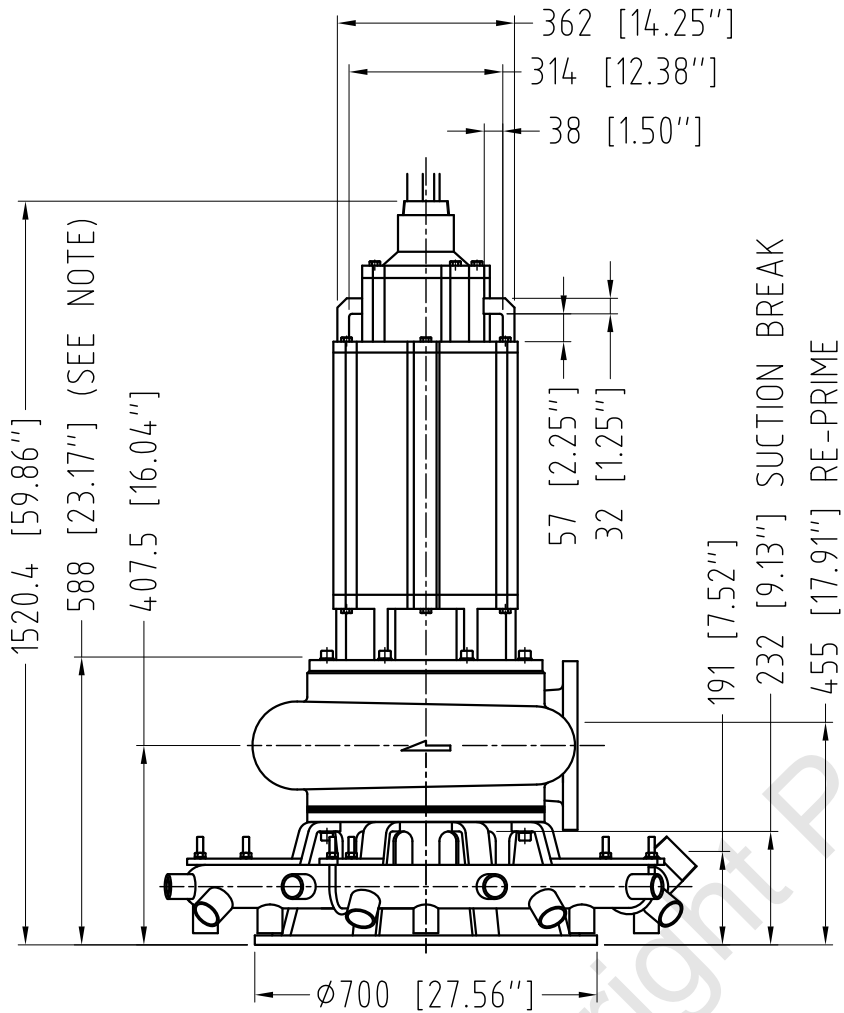

NOTE:
 MIN. SUBMERGENCE FOR MOTOR
 MODULES EQUIPPED WITH
 WATER JACKETS ONLY

GENERAL ARRANGEMENT, WEIGHTS	
TBM 200 LH-PHO, PBO, PVO (40 - 60 HP 6P Motors)	
OPTIONAL WATER JET RING (30 - 40 HP 8P Motors)	
DRAWING NBR.: A0646	REV.: 0
EFFECTIVE DATE : 08/05/2012	

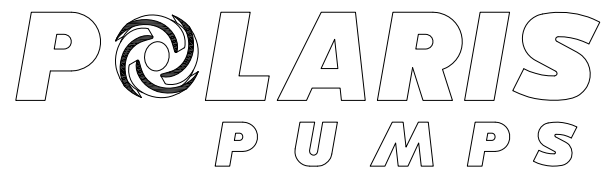

PUMP MODEL	WEIGHT (lbs.)	WEIGHT (kg)
TBM 200 LH - PHO	2128	967
TBM 200 LH - PBO	2139	972
TBM 200 LH - PVO	2143	974

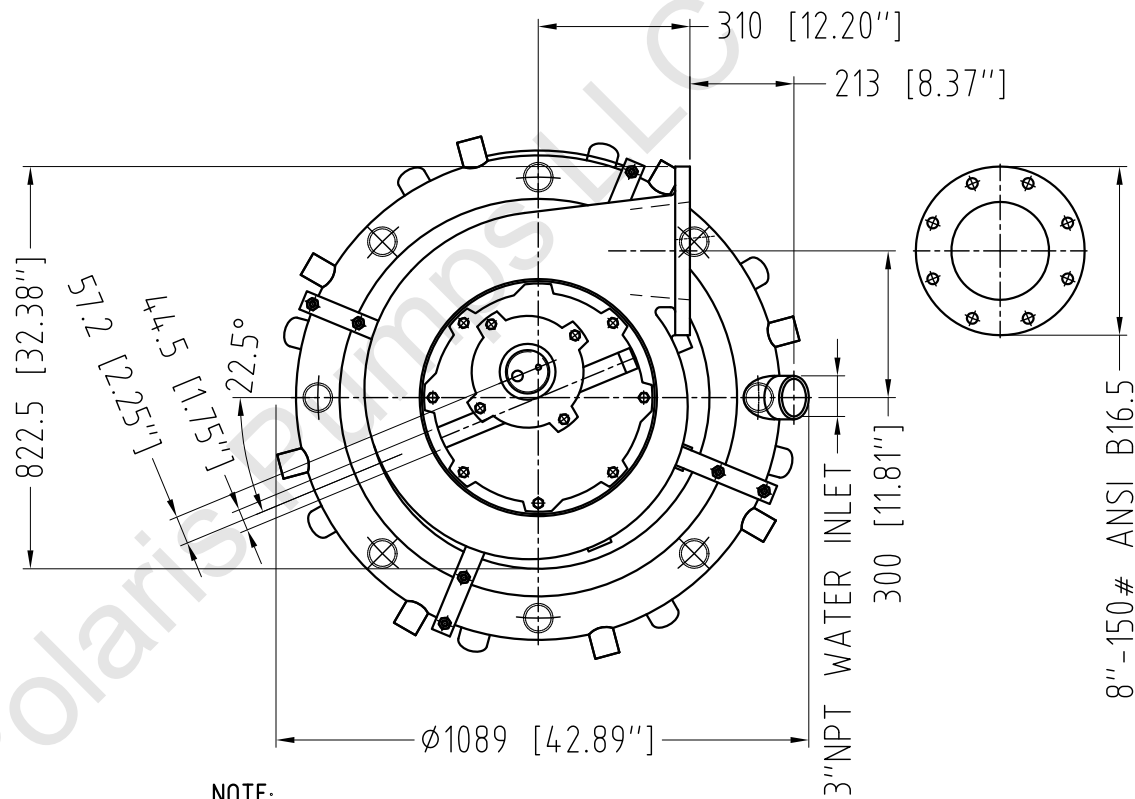
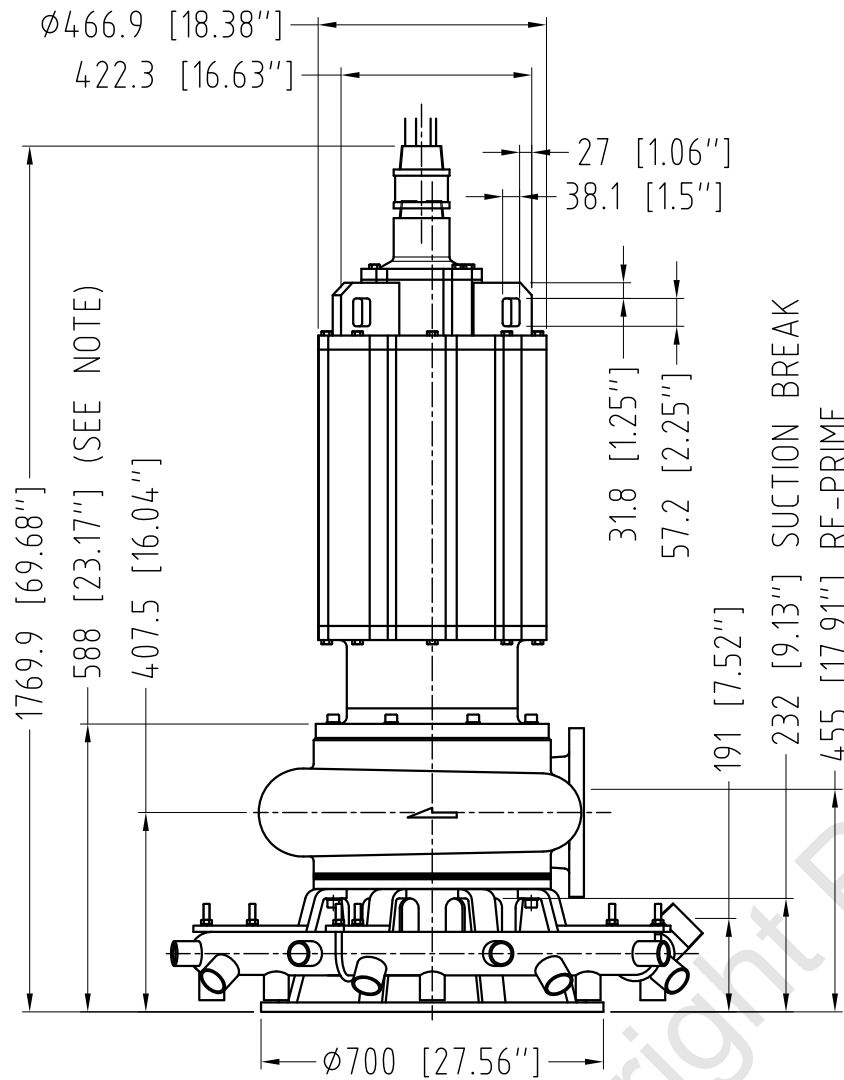

NOTE:
 MIN. SUBMERGENCE FOR MOTOR
 MODULES EQUIPPED WITH
 WATER JACKETS ONLY

GENERAL ARRANGEMENT, WEIGHTS
 TBM 200 LH-PHO, PBO, PVO (75 - 125 HP 6P Motors)
 OPTIONAL WATER JET RING (60 - 150 HP 8P Motors)

DRAWING NBR.: A0645 REV.: 0

EFFECTIVE DATE : 08/12/2012

POLARIS
 P U M P S

PUMP MODEL	WEIGHT (lbs.)	WEIGHT (kg)
TBM 200 LH - PHO	2477	1126
TBM 200 LH - PBO	2488	1131
TBM 200 LH - PVO	2493	1133

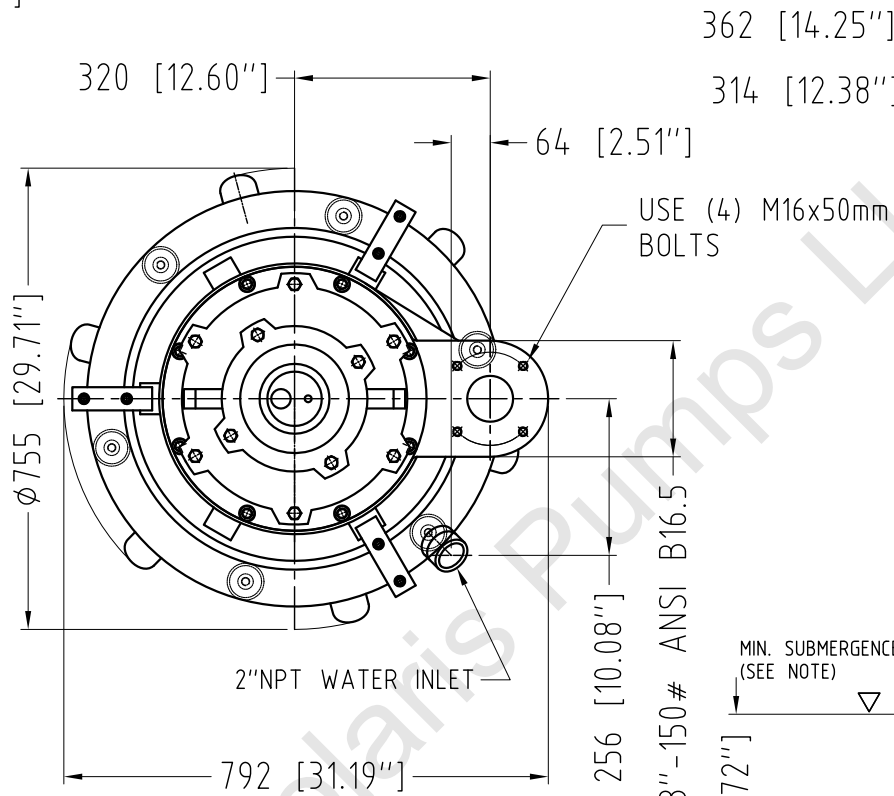
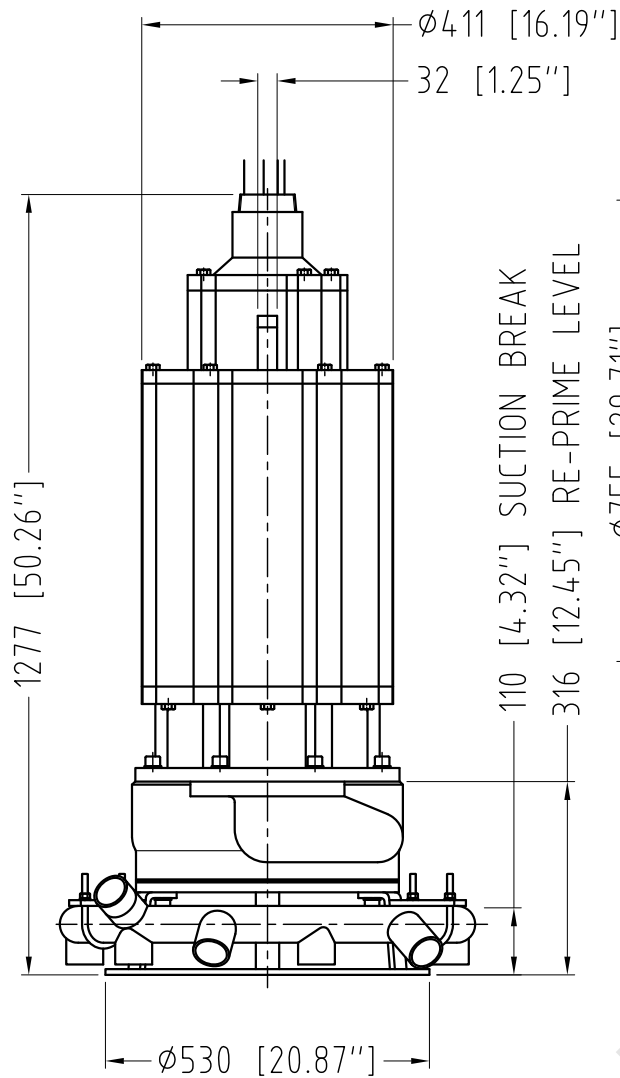

NOTE:
 MIN. SUBMERGENCE FOR MOTOR
 MODULES EQUIPPED WITH
 WATER JACKETS ONLY

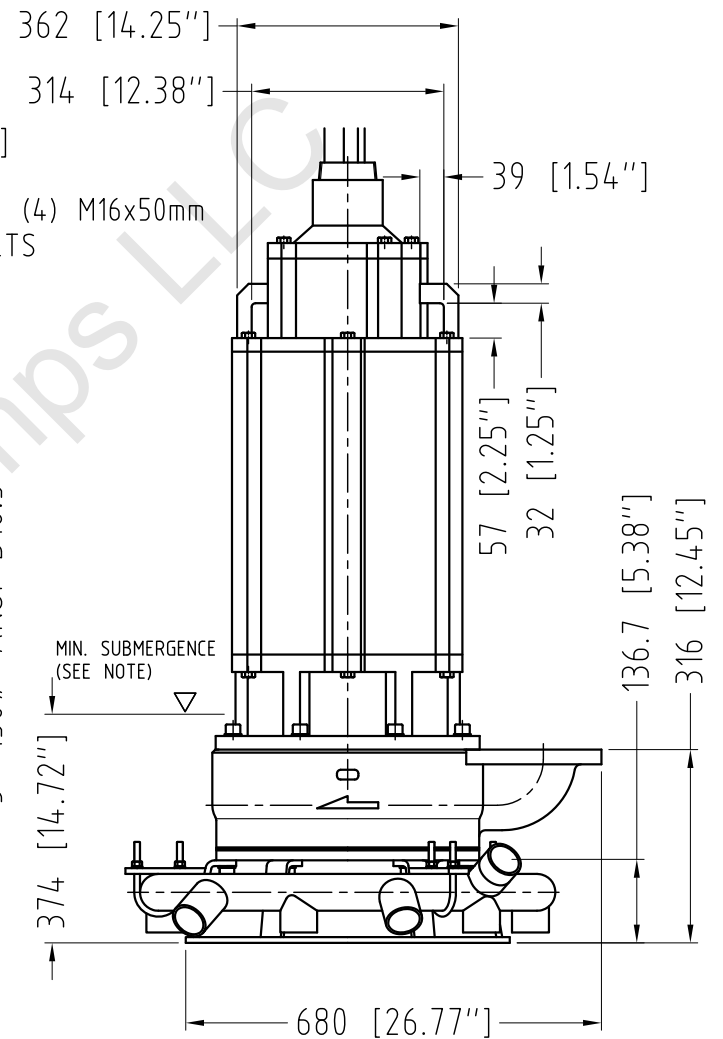

GENERAL ARRANGEMENT, WEIGHTS
 TBM 75 MH-PHO, PBO, PVO (50 - 75 HP 4P Motors)

DRAWING NBR.: A0648 REV.: 0

EFFECTIVE DATE : 08/05/2012

POLARIS
 P U M P S

PUMP MODEL	WEIGHT (lbs.)	WEIGHT (kg)
TBM 75 MH - PHO	1388	631
TBM 75 MH - PBO	1393	633
TBM 75 MH - PVO	1395	634

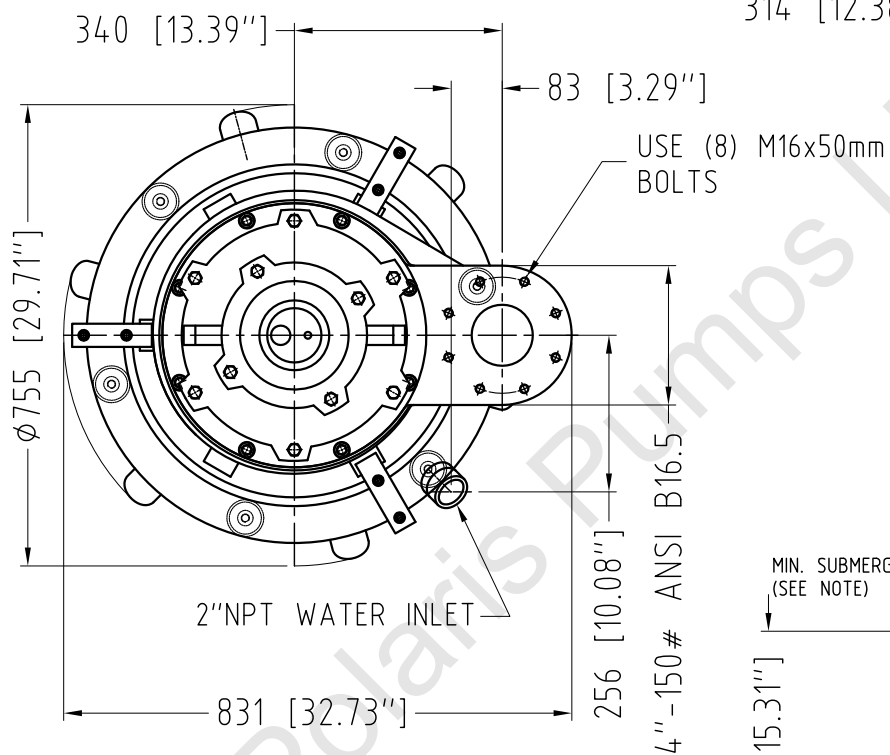
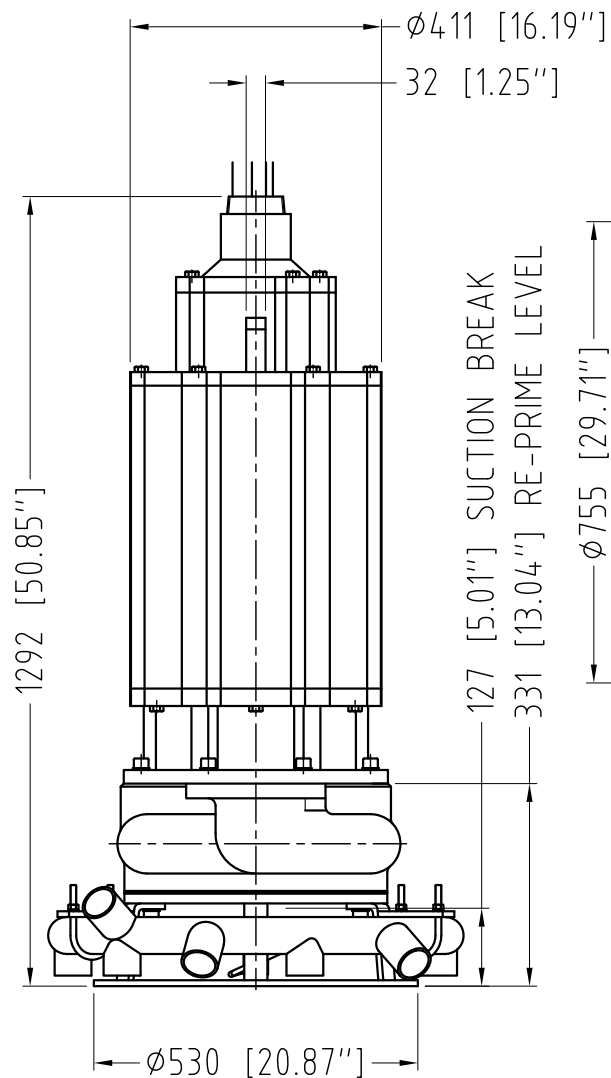

NOTE:
 MIN. SUBMERGENCE FOR MOTOR
 MODULES EQUIPPED WITH
 WATER JACKETS ONLY

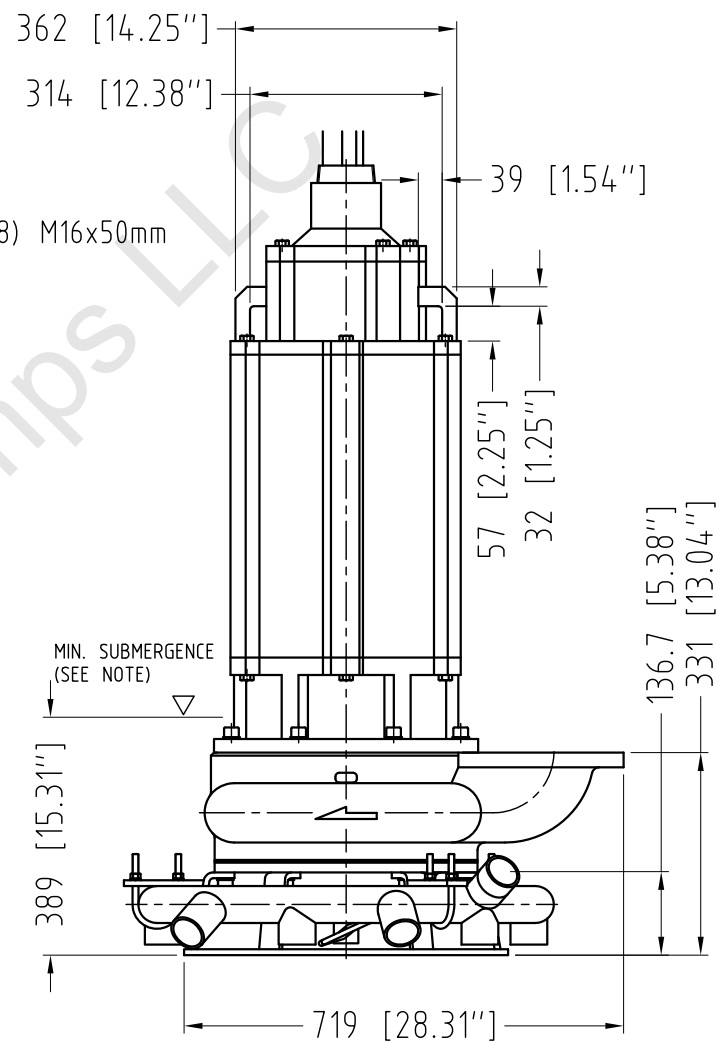

GENERAL ARRANGEMENT, WEIGHTS
 TBM 100 MH-PHO, PBO, PVO (50 - 75 HP 4P Motors)
 (30 - 40 HP 6P Motors)

DRAWING NBR.: A0650 REV.: 0

EFFECTIVE DATE : 08/05/2012

POLARIS
 P U M P S

PUMP MODEL	WEIGHT (lbs.)	WEIGHT (kg)
TBM 100 MH - PHO	1529	695
TBM 100 MH - PBO	1538	699
TBM 100 MH - PVO	1536	698

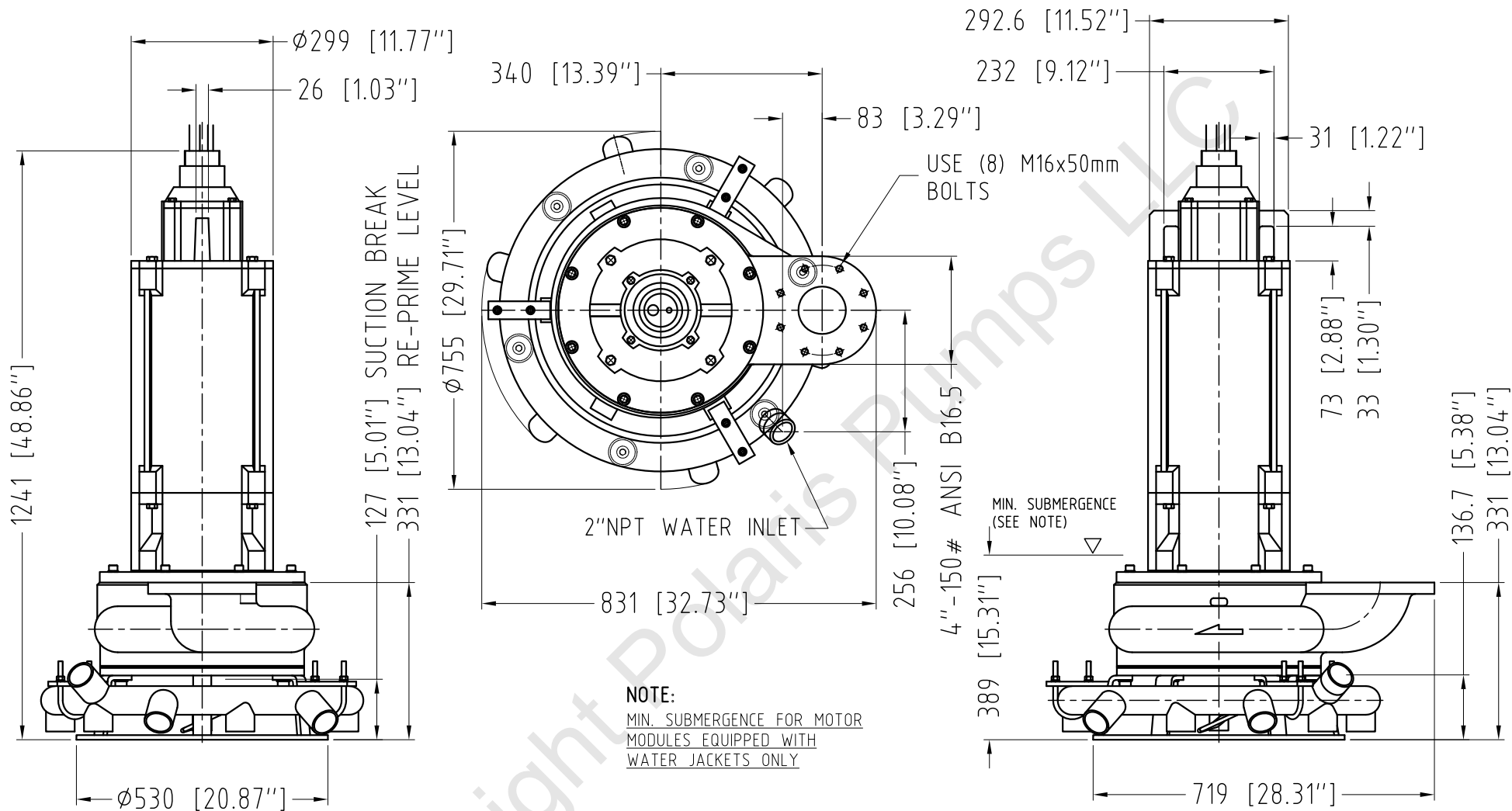

GENERAL ARRANGEMENT, WEIGHTS
TBM 100 MH-PHO, PBO, PVO (25 - 40 HP 4P Motors)
(15 - 25 HP 6P Motors)

DRAWING NBR.: A0649 REV.: 0

EFFECTIVE DATE : 08/05/2012

POLARIS
PUMPS

PUMP MODEL	WEIGHT (lbs.)	WEIGHT (kg)
TBM 100 MH - PHO	827	376
TBM 100 MH - PBO	834	379
TBM 100 MH - PVO	832	378

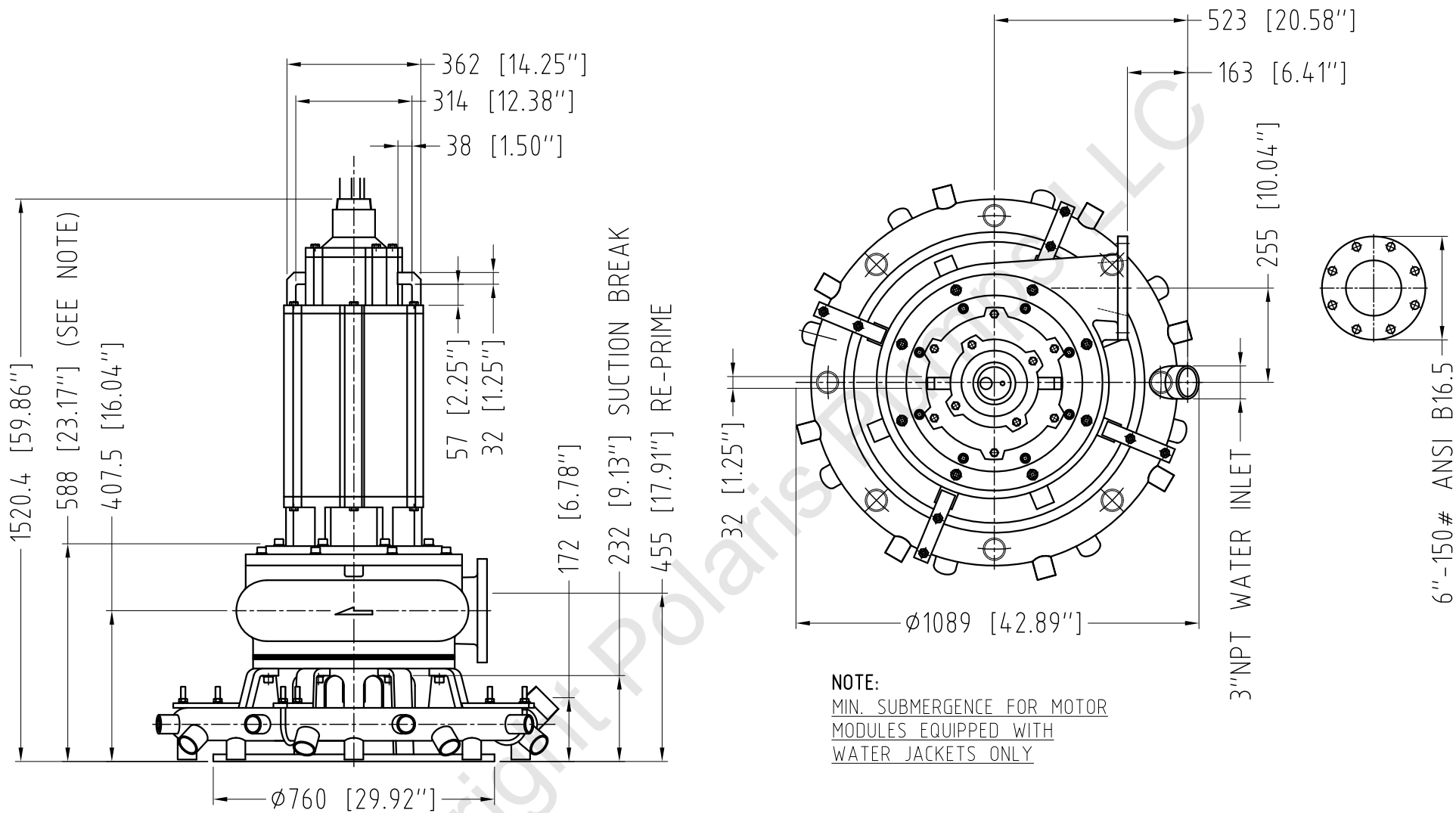

NOTE:
 MIN. SUBMERGENCE FOR MOTOR
 MODULES EQUIPPED WITH
 WATER JACKETS ONLY

GENERAL ARRANGEMENT, WEIGHTS	
TBM 150 MH-PHO, PBO, PVO (50 - 60 HP 6P Motors)	
OPTIONAL WATER JET RING (30 - 40 HP 8P Motors)	
DRAWING NBR.: A0644	REV.: 0
EFFECTIVE DATE : 08/05/2012	

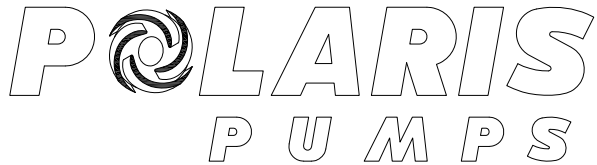

PUMP MODEL	WEIGHT (lbs.)	WEIGHT (kg)
TBM 150 MH - PHO	2101	955
TBM 150 MH - PBO	2341	1064
TBM 150 MH - PVO	2361	1073

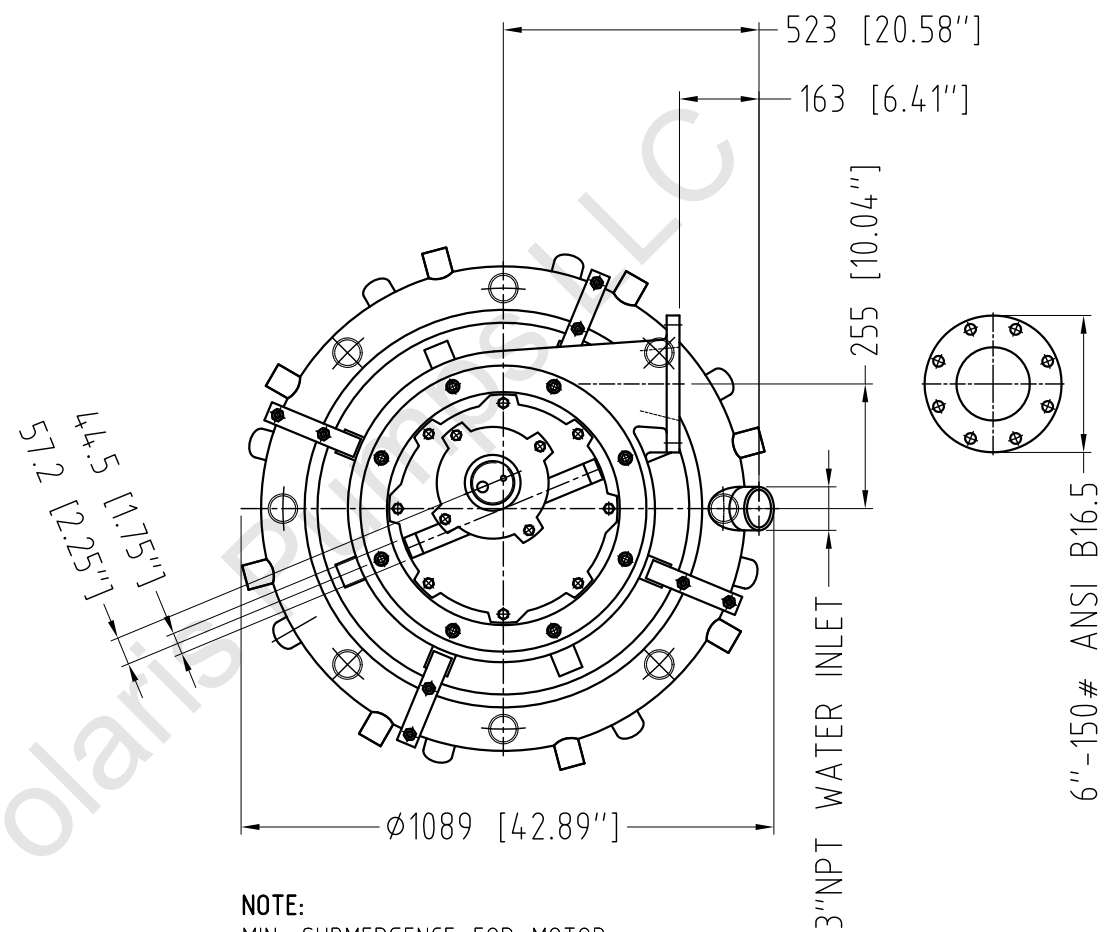
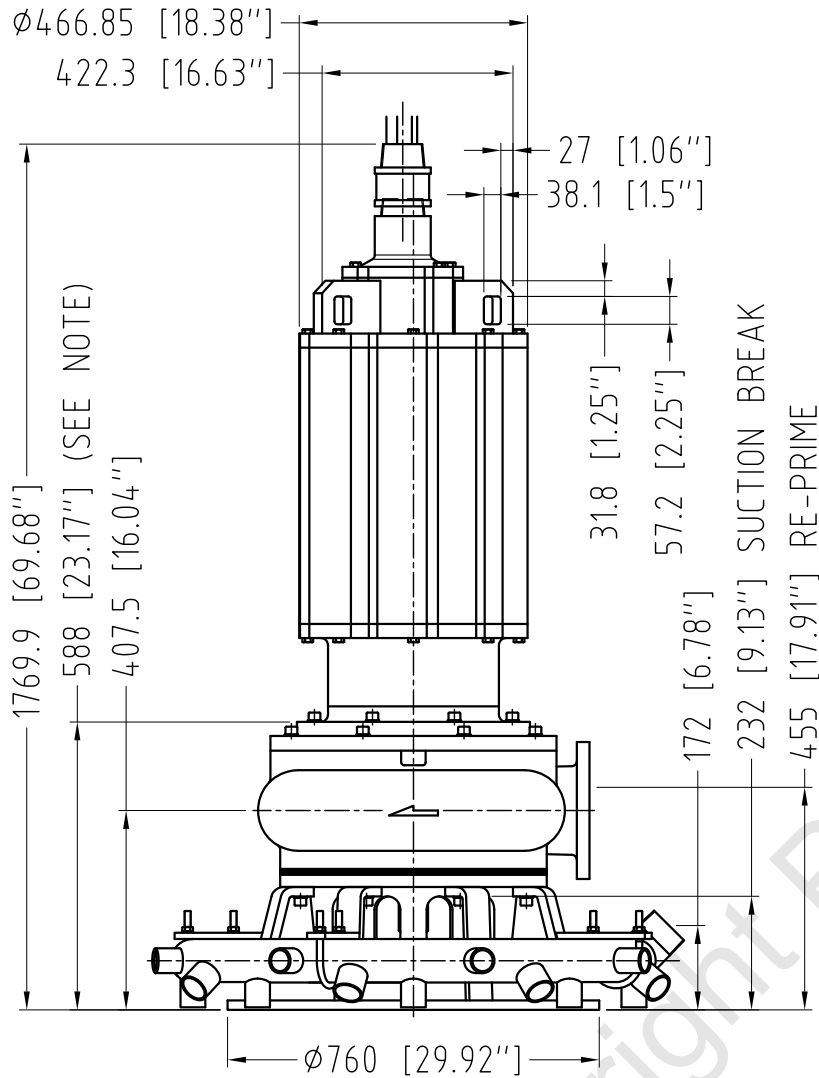

NOTE:
 MIN. SUBMERGENCE FOR MOTOR
 MODULES EQUIPPED WITH
 WATER JACKETS ONLY

GENERAL ARRANGEMENT, WEIGHTS	
TBM 150 MH-PHO, PBO, PVO (100-125HP 6P/8P Motors)	
OPTIONAL WATER JET RING (100-150 HP 4P Motors)	
DRAWING NBR.: A0643	REV.: 0
EFFECTIVE DATE : 08/05/2012	

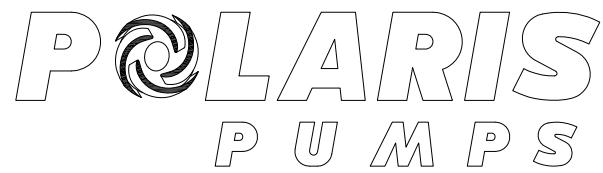

PUMP MODEL	WEIGHT (lbs.)	WEIGHT (kg)
TBM 150 MH - PHO	2451	1114
TBM 150 MH - PBO	2691	1223
TBM 150 MH - PVO	2693	1224

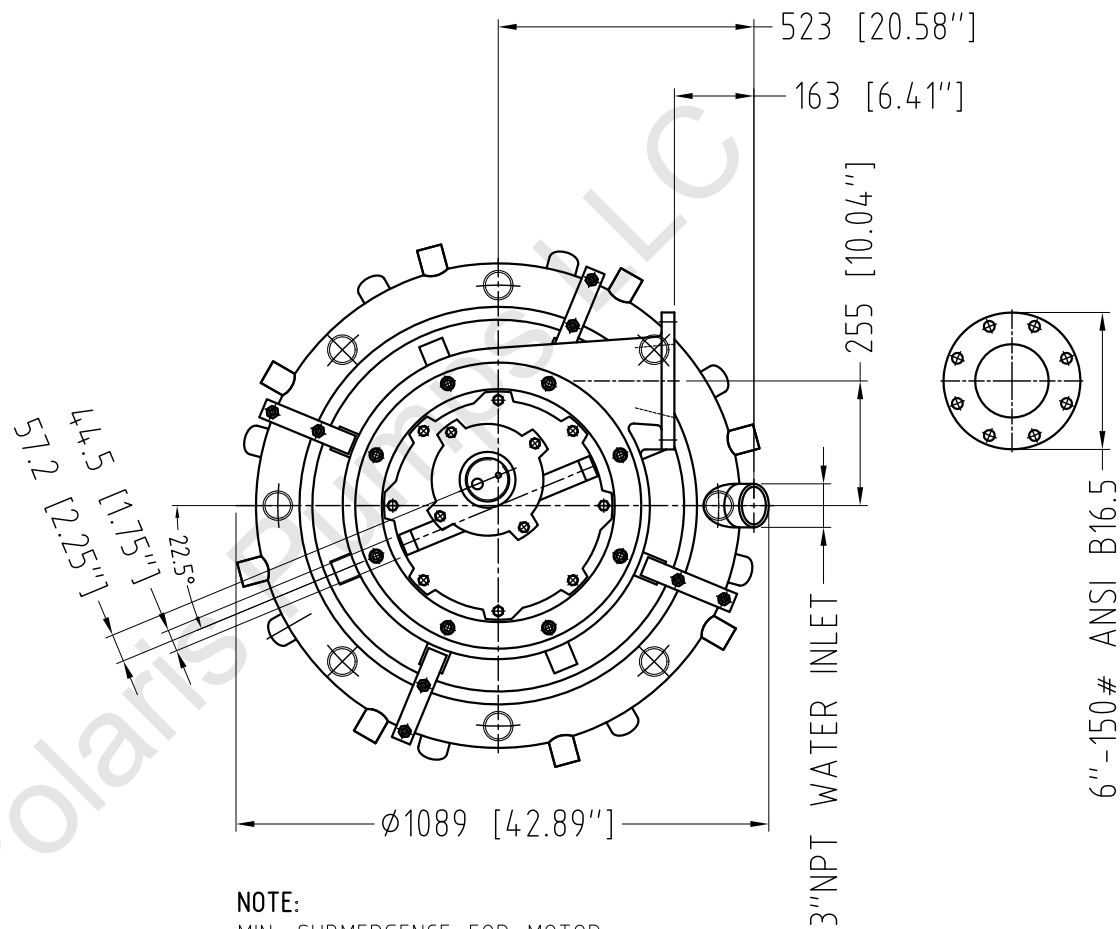
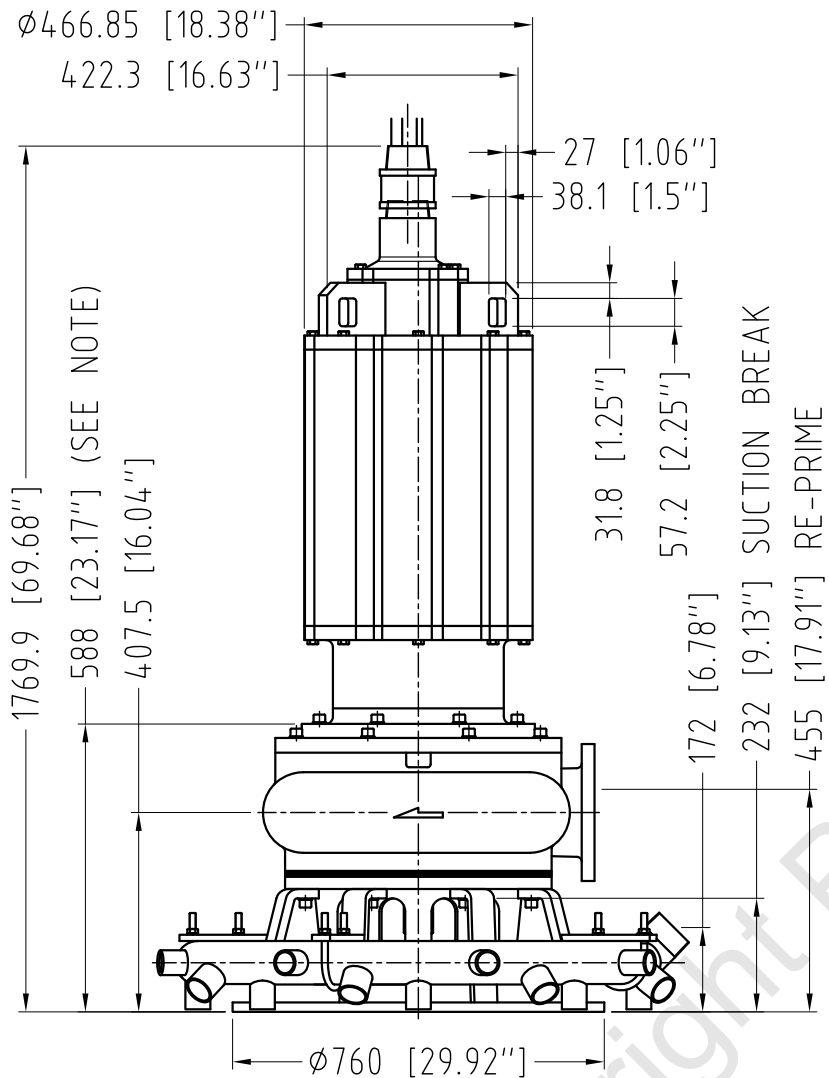

NOTE:
 MIN. SUBMERGENCE FOR MOTOR
 MODULES EQUIPPED WITH
 WATER JACKETS ONLY

GENERAL ARRANGEMENT, WEIGHTS	
TBM 150 MH-PHO, PBO, PVO (OPTIONAL WATER JET RING)	
(75HP 6P, 60 - 75 HP 8P Motors)	
DRAWING NBR.: A0642	REV.: 0
EFFECTIVE DATE : 08/05/2012	

P  **L A R I S**
 P U M P S

PUMP MODEL	WEIGHT (lbs.)	WEIGHT (kg)
TBM 150 MH - PHO	2321	1055
TBM 150 MH - PBO	2338	1063
TBM 150 MH - PVO	2343	1065

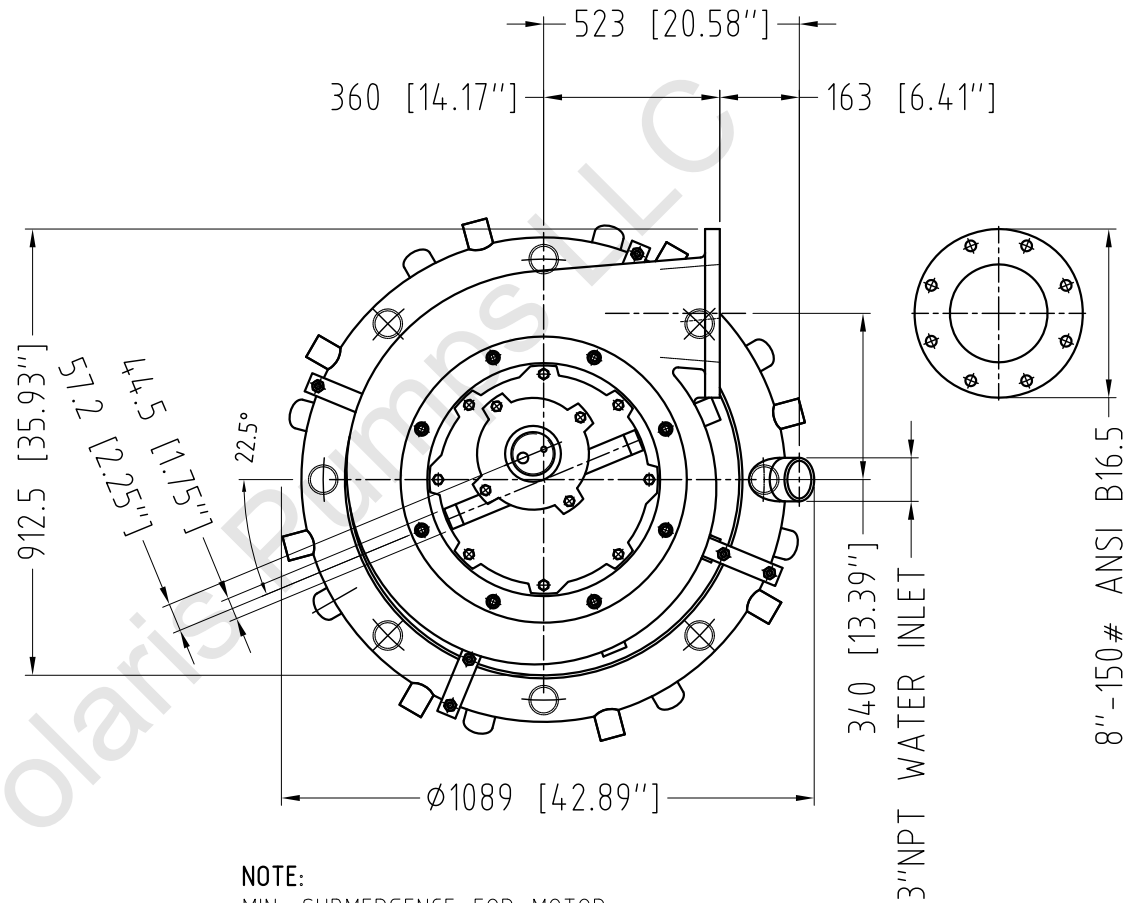
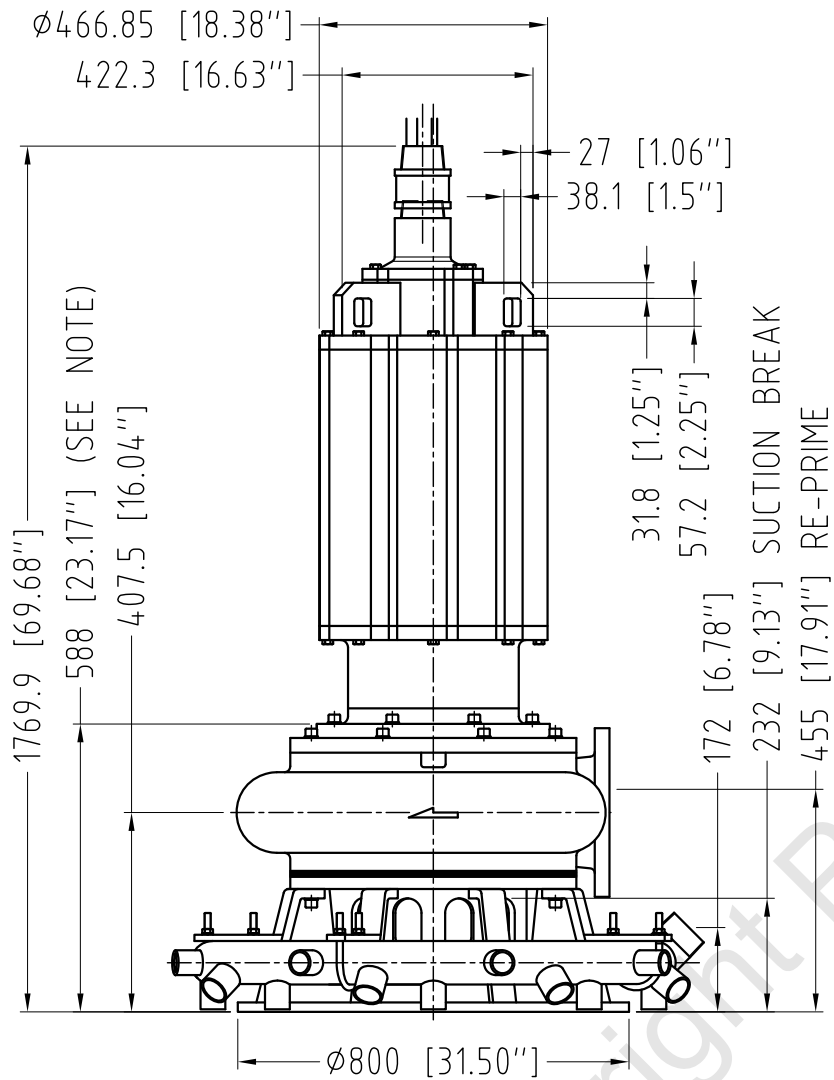

NOTE:
 MIN. SUBMERGENCE FOR MOTOR
 MODULES EQUIPPED WITH
 WATER JACKETS ONLY

GENERAL ARRANGEMENT, WEIGHTS	
TBM 200 MH-PHO, PBO, PVO (75 - 125 HP 6P Motors)	
OPTIONAL WATER JET RING (60 - 150 HP 8P Motors)	
DRAWING NBR.: A0652	REV.: 0
EFFECTIVE DATE : 08/05/2012	

POLARIS
 P U M P S

PUMP MODEL	WEIGHT (lbs.)	WEIGHT (kg)
TBM 200 MH - PHO	2785	1266
TBM 200 MH - PBO	2805	1275
TBM 200 MH - PVO	2810	1277

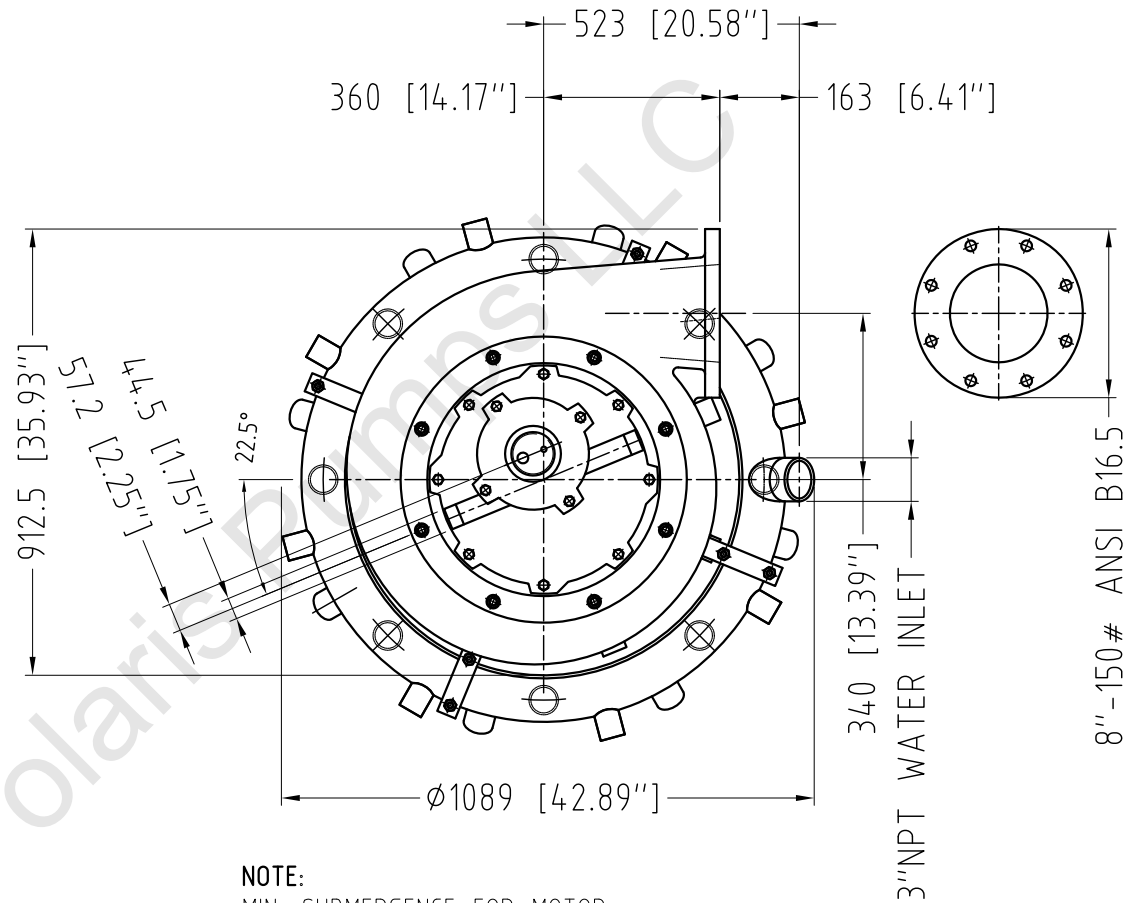
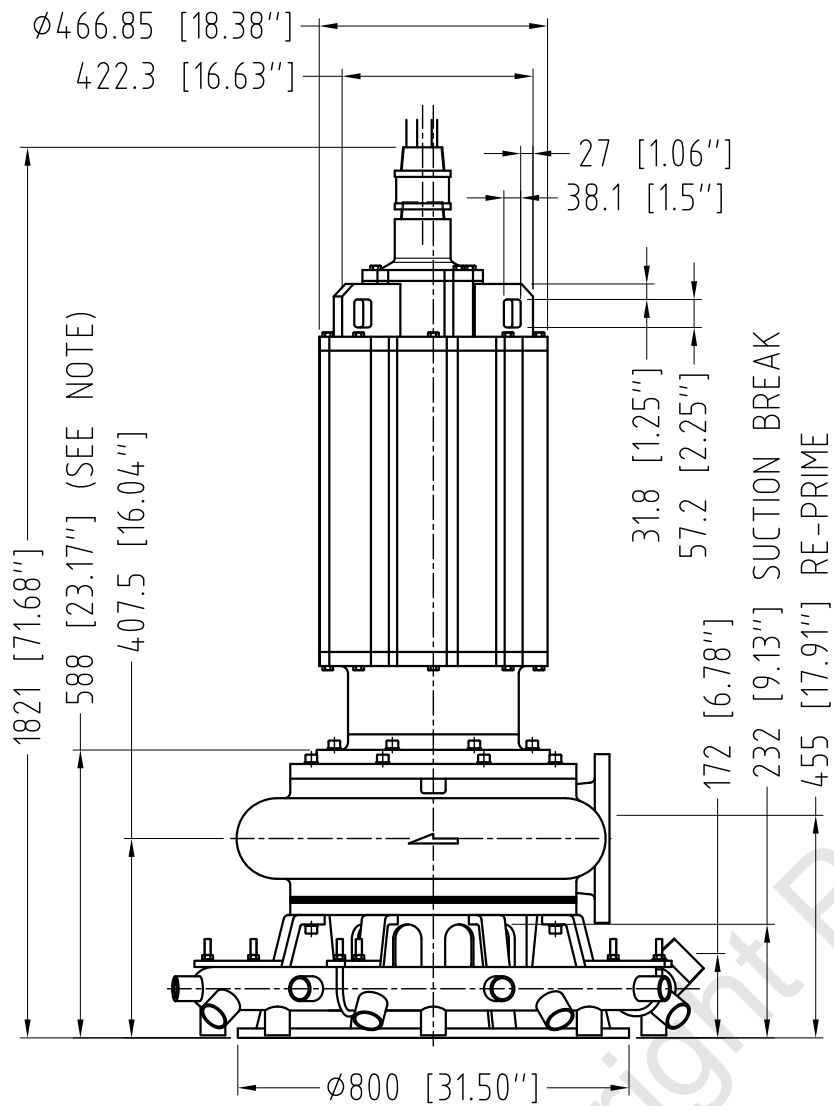

NOTE:
 MIN. SUBMERGENCE FOR MOTOR
 MODULES EQUIPPED WITH
 WATER JACKETS ONLY

GENERAL ARRANGEMENT, WEIGHTS TBM 200 MH-PHO, PBO, PVO (150 HP 6P Motor) OPTIONAL WATER JET RING	
DRAWING NBR.: A0653	REV.: 0
EFFECTIVE DATE : 08/05/2012	

POLARIS
 P U M P S

PUMP MODEL	WEIGHT (lbs.)	WEIGHT (kg)
TBM 200 MH - PHO	2785	1266
TBM 200 MH - PBO	2805	1275
TBM 200 MH - PVO	2810	1277